

PERMANENT RETURN AFTER DETOUR

CONTRACT NO. 64640

F.A.P. RTE.	SECTION	COUNTY	TOTAL SHEETS	SHEET NO.
22	6M & TS	HENRY	257	57
STA.		TO STA.		
FED. ROAD DIST. NO.		ILLINOIS	FED. AID PROJECT	

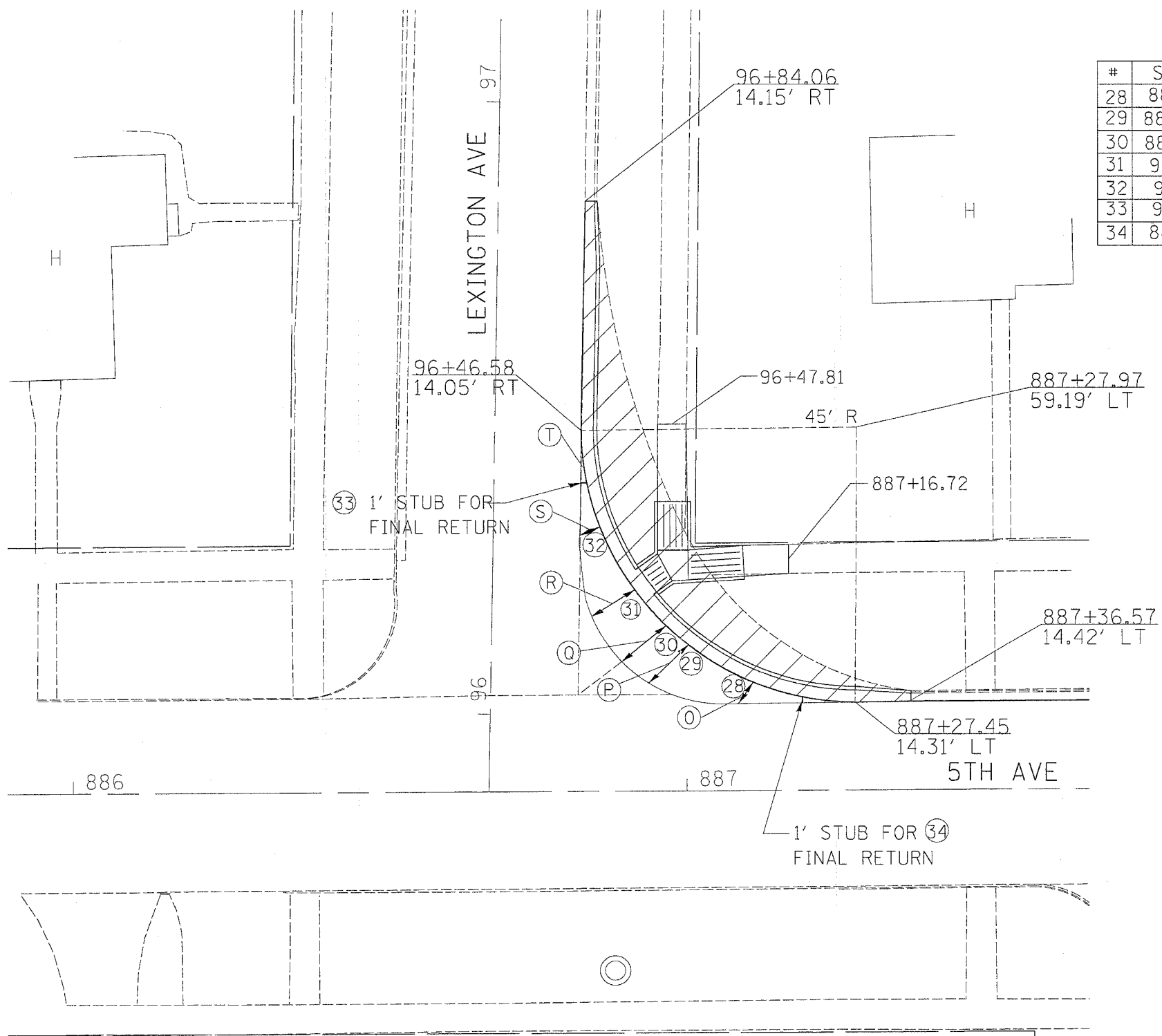

#	STATION	OFFSET	ELEVATION	REMARKS
28	887+11.15	17.69' LT	848.89	FINAL
29	887+00.36	23.80' LT	848.67	FINAL
30	886+96.73	26.95' LT	848.59	FINAL
31	96+20.62	23.21' RT	848.47	FINAL
32	96+30.81	17.38' RT	848.28	FINAL
33	96+37.98		848.17	
34	887+18.86		849.02	

	DISTANCE (FT)
O	4.14
P	8.96
Q	9.28
R	8.23
S	3.61
T	0.54

NOT TO SCALE

REVISIONS	DATE

ILLINOIS DEPARTMENT OF TRANSPORTATION

SCALE: VERT. _____
 HORIZ. _____

DATE _____ DRAWN BY _____
 CHECKED BY _____

PERMANENT RETURN AFTER DETOUR

PLT DATE = Thu Oct 27 10:25:44 2005
 FILE NAME = c:\p\projects\216880\p16880pl.dgn
 PLOT SCALE = 10.000 / IN.
 REFERENCE = NHP