

F.A.R. RTE.	SECTION	COUNTY	TOTAL SHEETS	SHEET NO.
22	6M & TS	HENRY	257	85
STA.		TO STA.		
FED. ROAD DIST. NO.		ILLINOIS FED. AID PROJECT		

PAVEMENT ELEVATIONS

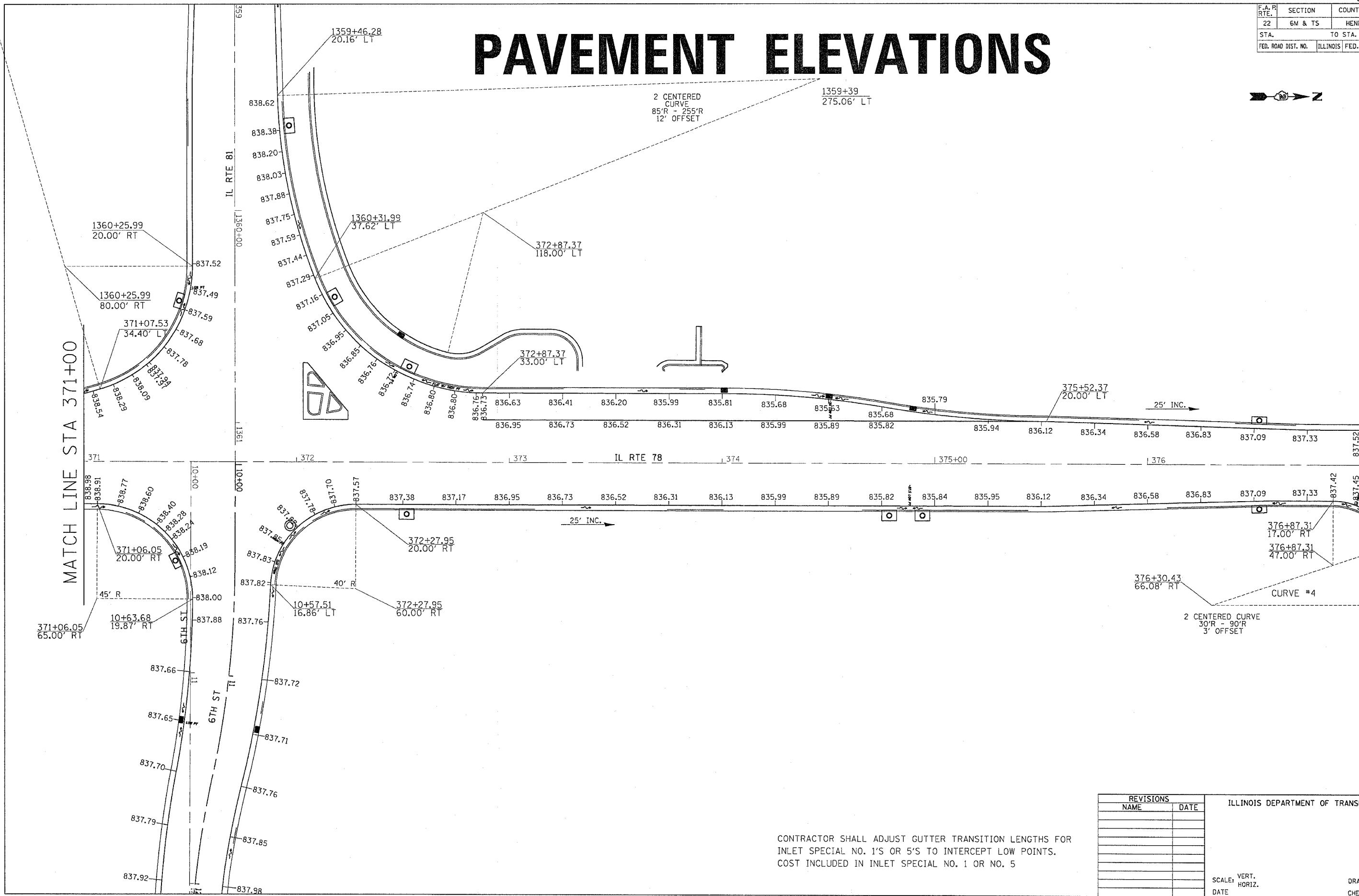

PLOT DATE = Thu Oct 27 09:34:04 2005
 FILE NAME = c:\pwworkspace\216888\1\168888.dgn
 PLOT SCALE = 1/8" = 1' IN.
 REFERENCE = SHEET

CONTRACTOR SHALL ADJUST GUTTER TRANSITION LENGTHS FOR INLET SPECIAL NO. 1'S OR 5'S TO INTERCEPT LOW POINTS. COST INCLUDED IN INLET SPECIAL NO. 1 OR NO. 5

REVISIONS	
NAME	DATE

ILLINOIS DEPARTMENT OF TRANSPORTATION

SCALE: VERT. DATE
 HORIZ. DATE

DRAWN BY
 CHECKED BY