

DRAINAGE DETAILS

FA P. RTE.	SECTION	COUNTY	TOTAL SHEETS	SHEET NO.
22	6M&T5	HENRY	257	98
STA. 1356+00		TO STA. 11+36		
FED. ROAD DIST. NO.	ILLINOIS	FED. AID PROJECT		

PLAN	DATE
BY	
REVISIONS	
NO.	DESCRIPTION
1	AS SHOWN

PROFILE	DATE
BY	
REVISIONS	
NO.	DESCRIPTION
1	AS SHOWN

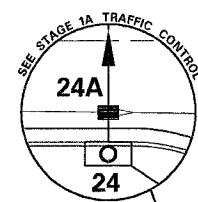

STORM SEWER							
21-22	7'-SS-CLA-T1-12"	838.40 - 838.35	SLOPE = 0.71%	33A-33	16'-SS-RG-CLA-T1-12"	833.50 - 833.10	SLOPE = 2.50%
22-23	37'-SS-CLA-T1-15"	838.25 - 837.90	SLOPE = 0.95%	24-25	33'-SS-WM-REO-18"	837.45 - 837.30	SLOPE = 0.45%
23-24	34'-SS-RG-CLA-T2-18"	837.80 - 837.65	SLOPE = 0.44%	25-26	36'-SS-WM-REO-24"	837.10 - 836.95	SLOPE = 0.42%
24-24A	SEE TRAFFIC CONTROL			26-27	57'-SS-WM-REO-24"	836.75 - 836.40	SLOPE = 0.61%
24A-25	DETAIL SHEETS			27-29	134'-SS-WM-REO-24"	836.30 - 835.25	SLOPE = 0.78%
				28-29	42'-SS-RG-CLA-T2-12"	836.40 - 835.60	SLOPE = 1.90%
				29-30	83'-SS-WM-REO-24"	835.15 - 834.40	SLOPE = 0.90%
				30-32	83'-SS-WM-REO-24"	834.30 - 833.60	SLOPE = 0.84%
				31-32	73'-SS-RG-CLA-T1-15"	834.35 - 833.70	SLOPE = 0.89%
				32-33	47'-SS-WM-REO-24"	833.50 - 832.95	SLOPE = 1.17%
				33-34	69'-SS-RG-CLA-T1-30"	832.75 - 832.45	SLOPE = 0.43%
				52-53	56'-SS-RG-CLA-T2-24"	834.10 - 833.80	SLOPE = 0.54%
				53-34	55'-SS-RG-CLA-T2-24"	833.60 - 832.50	SLOPE = 2.00%

INLETS / MANHOLES			
21	STA. 1357+31.6 38.1' RT	RES DEPTH MH 4' DIA.	TY 1 FR, CL LID
		LID ELEV = 841.45	
22	STA. 1357+23 35.7' RT	INLET SPL NO. 5	EOP ELEV = 840.98
		WIER ELEV = 840.49	
23	STA. 1356+89.1 35.7' RT	INLET SPL NO. 5	EOP ELEV = 841.07
		WIER ELEV = 840.58	
24	STA. 1356+58.8 15' RT	INLET SPL NO. 5	EOP ELEV = 842.10
		WIER ELEV = 841.61	
24A	STA. 1356+59 10.6' RT	INLET SPL (TEMPORARY)	GRATE ELEV = MATCH EXISTING
25	STA. 1356+59.9 15' LT	INLET SPL NO. 5	EOP ELEV = 842.10
		WIER ELEV = 841.61	
26	STA. 1356+90.6 37.7' LT	INLET SPL NO. 5	EOP ELEV = 841.13
		WIER ELEV = 840.64	
27	STA. 1357+43 17.6' LT	INLET SPL NO. 3	EOP ELEV = 840.90
		WIER ELEV = 840.41	
28	STA. 1358+77 20.2' RT	INLET SPL	EOP ELEV = 839.59
		WIER ELEV = 839.80	
29	STA. 1358+77 18.8' LT	INLET SPL NO. 3	EOP ELEV = 839.80
		WIER ELEV = 839.31	
30	STA. 1359+60.4 23' LT	INLET SPL NO. 3	EOP ELEV = 838.45
		WIER ELEV = 837.96	
31	STA. 1360+42 24.6' RT	INLET SPL NO. 5	EOP ELEV = 837.55
		WIER ELEV = 837.06	
32	STA. 1360+42 44.7' LT	INLET SPL NO. 3	EOP ELEV = 837.10
		WIER ELEV = 836.61	
33A	STA. 372+51.8 43.1' LT	INLET SPL NO. 3	EOP ELEV = 836.72
		WIER ELEV = 836.23	
33B	STA. 372+49.1 60.4' LT	INLET SPL NO. 1	EOP ELEV = 838.32
		WIER ELEV = 837.86	
34	STA. 372+51.4 22' RT	INLET SPL NO. 3	EOP ELEV = 837.35
		WIER ELEV = 836.86	
52	STA. 371+44.8 46.1' RT	INLET SPL NO. 3	EOP ELEV = 838.19
		WIER ELEV = 837.70	
53	STA. 371+96.6 32.6' RT	RES DEPTH MH 5' DIA.	TY 1 FR, CL LID
		LID ELEV = 837.80	

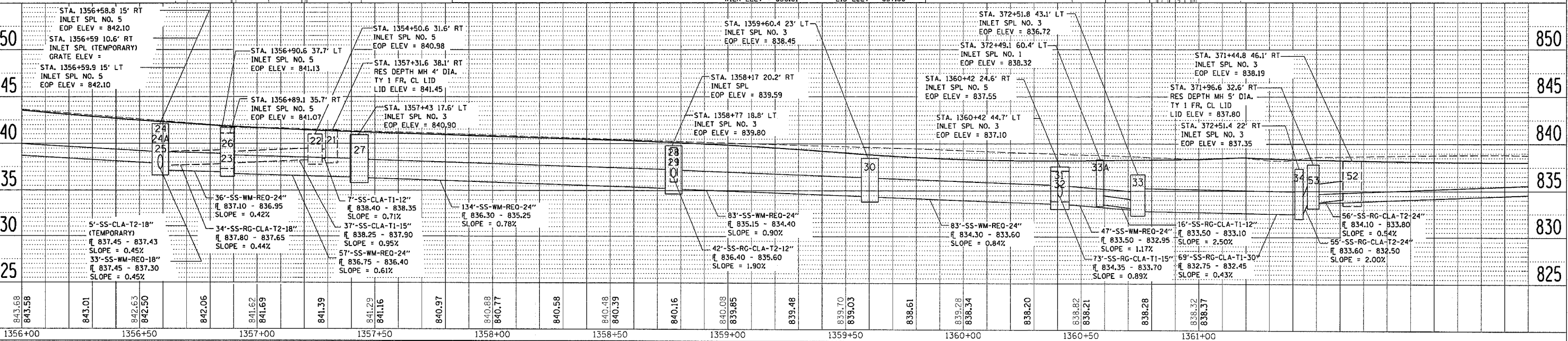
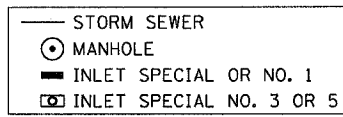

DRAINAGE DETAILS