

F.A.P. RITE NO.	SECTION	COUNTY	TOTAL SHEETS	SHEET NO.
22	GM&TS	HENRY	257	123
STA.		TO STA.		
FED. ROAD DIST. NO.		ILLINOIS FED. AID PROJECT		

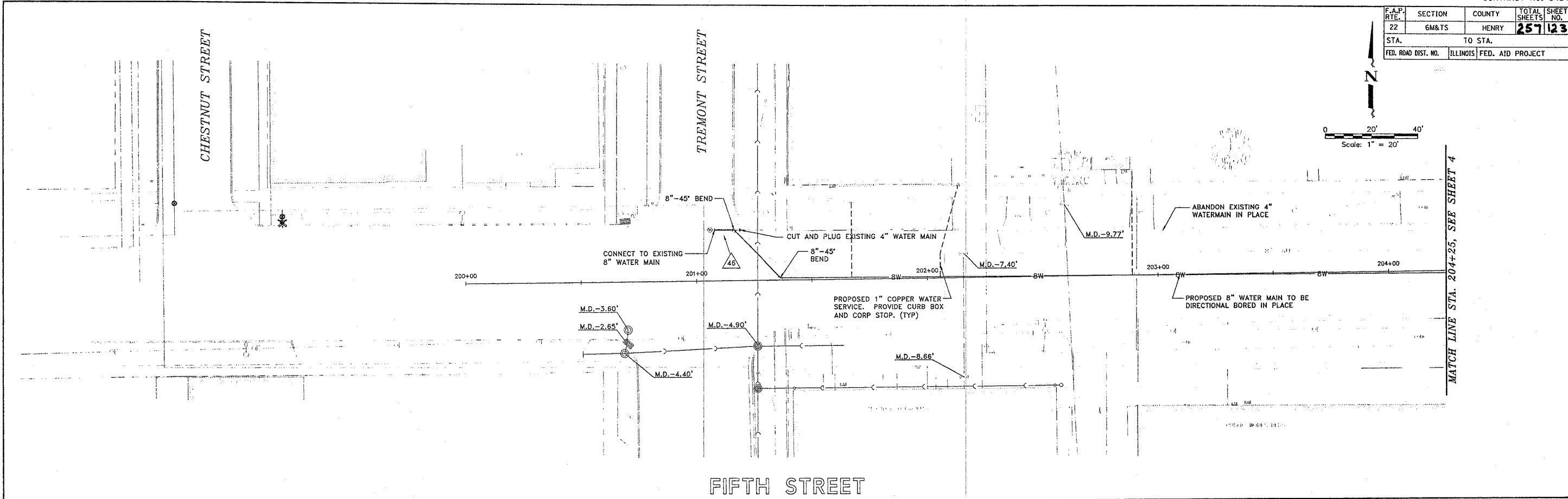

	EXISTING BITUMINOUS PAVEMENT REMOVAL AND REPLACEMENT. (BIT.)
	EXISTING PC CONCRETE PAVEMENT REMOVAL AND REPLACEMENT. (CONC.)
	EXISTING SIDEWALK REMOVAL AND REPLACEMENT. (SW.)
	EXISTING AGGREGATE SURFACE REMOVAL AND REPLACEMENT. (AGG.)
	EXISTING CONCRETE CURB & GUTTER REMOVAL AND REPLACEMENT. (C&G)

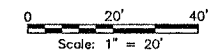
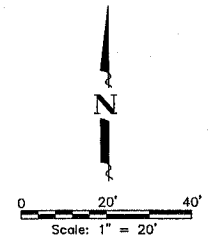

CITY OF KEWANEE
401 East Third Street, Kewanee, IL 61443

REVISIONS		
NO.	ITEM	DATE
1	REVISED PER CLIENT COMMENTS	AUGUST 2005

PLOTTING SCALE:	1" = 20'
DRAWN BY:	BRS
CHECKED BY:	
DATE:	AUGUST 2005

McCLURE ENGINEERING ASSOCIATES, INC.
 4700 Kennedy Drive East Moline, Illinois 61244
 (309) 792-9350 FAX (309) 792-8974
Design Firm License: Illinois #184-000918
 Copyright 2005 by McClure Engineering Associates, Inc.

FIFTH STREET	
STA. 200+00 TO STA. 204+25	
6th Street & Main Street Water Main	KEWANEE, ILLINOIS
FILE NAME: T:\KE103.195\dwg\03195MDL.dwg	JOB NUMBER: 01-21-03-195

SHEET NO.
6
OF 6

WATER MAIN DETAILS