

F.A.P. RTE.	SECTION	COUNTY	TOTAL SHEETS	SHEET NO.
22	6M&T5	HENRY	257	124
STA.		TO STA.		
FED. ROAD DIST. NO.		ILLINOIS	FED. AID PROJECT	

W. 6TH ST. (RT. 81) W.M. EXTENSION  
FALL 2005, CITY OF KEWANEE  
LOG NO. 2006-0675

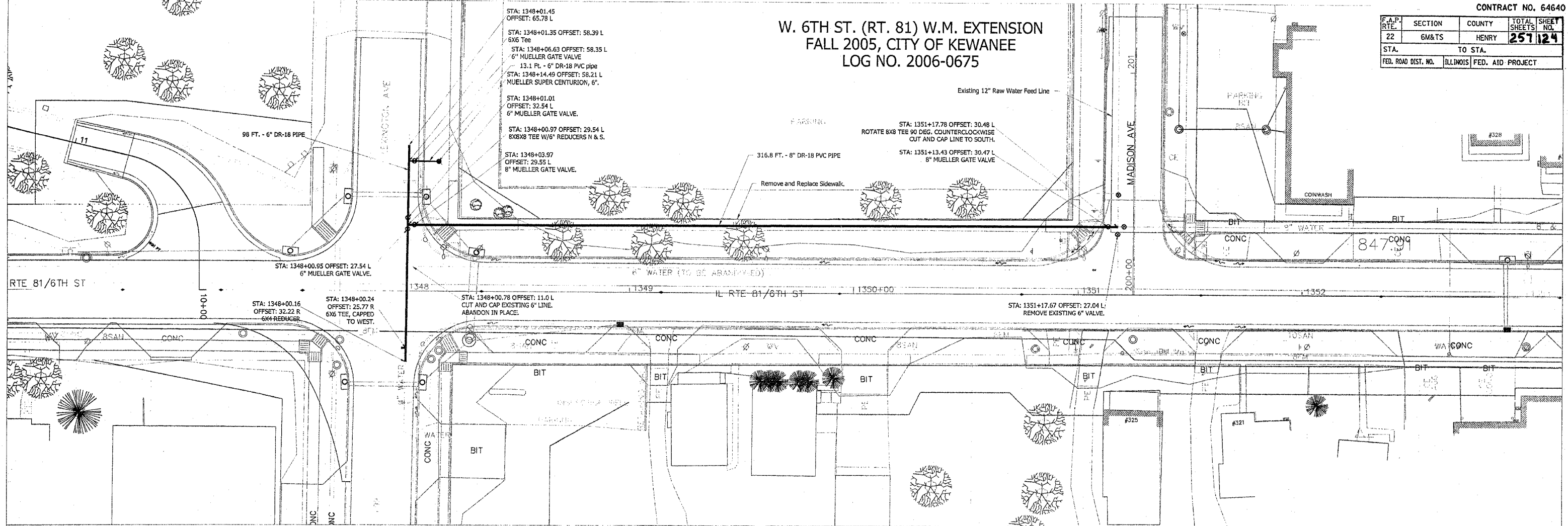

SCHEDULE OF QUANTITIES

ITEM	UNIT	TOTAL QUANTITY
WATER MAIN 8"	FOOT	319
WATER MAIN 6"	FOOT	110
WATER VALVES 8"	EACH	2
WATER VALVES 6"	EACH	3
8" X 8" D.I.P. TEE	EACH	2
6" X 6" D.I.P. TEE	EACH	2
FIRE HYDRANT TO BE REMOVED AND REPLACED	EACH	1
8" X 6" REDUCER	EACH	2
6" X 4" REDUCER	EACH	1
CONNECTION TO EXISTING WATER MAIN	EACH	3
TRENCH BACKFILL	CU YD	323
ABANDONMENT OF EXISTING WATER MAIN	L SUM	1

PROFILE

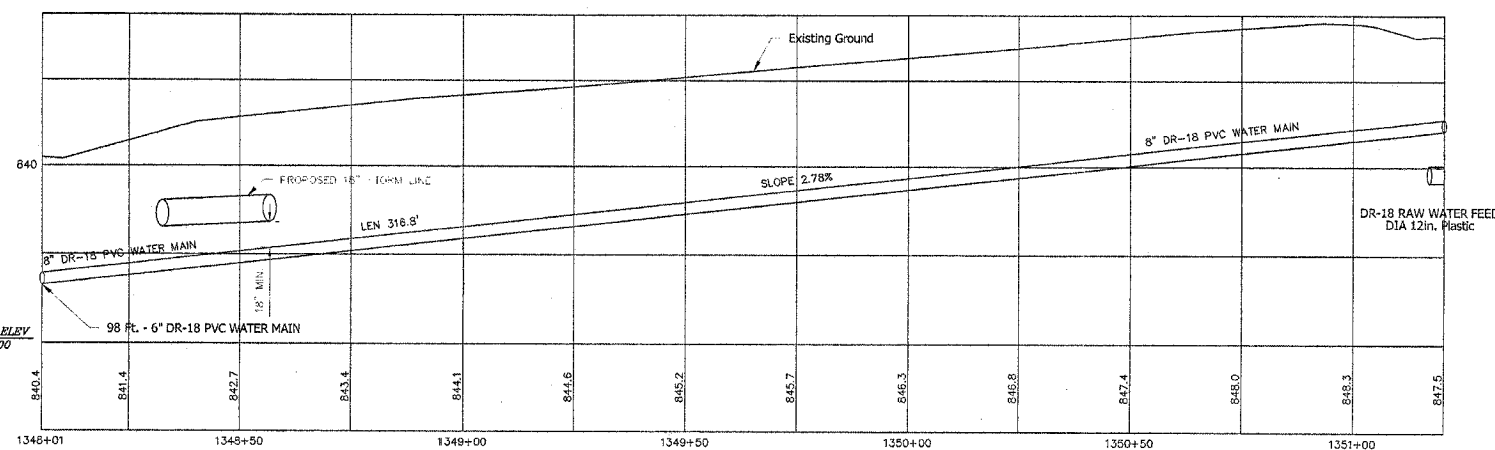

GRAPHIC SCALE

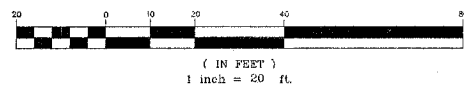

ALL WORK TO CONFORM TO THE "STANDARD SPECIFICATIONS FOR WATER AND SEWER CONSTRUCTION IN ILLINOIS, CURRENT VERSION."

CALL BEFORE YOU DIG  
1-800-392-0123

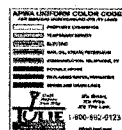

WATER MAIN DETAILS

DRAWN BY: MJF	DATE: 9/15/2005
CHECKED BY: KS	DRAWING NO: 400-001-2005
400-001-2005 SHEET 1 OF 1	