

Bench Mark: Chiseled "□" on N.E. Wingwall of SN 019-0029
Elev. = 788.87

Existing Structure: SN 019-0029 built as SBI Route 12 Sec. 125 VBR in 1976
Three span, 27" deep precast prestressed concrete box beams,
176'-10" bk. to bk. of abutments, 33'-0" o. to o. of deck on pile supported
spill-thru abutment and multi column piers. Road to be closed. Traffic to be
maintained utilizing a detour.
No Salvage

STATE OF ILLINOIS
DEPARTMENT OF TRANSPORTATION

ROUTE NO.	SECTION	COUNTY	TOTAL SHEETS	SHEET NO.	SHEET NO. 1
FAP 553	125 VBR-1F	DEKALB	15	3	13 SHEETS
FED. ROAD DIST. NO. 7	ILLINOIS	FED. AID PROJECT-			

Contract #64890

See Sheet 2 of 13 for Total Bill of Materials and General Notes.

ICE R.R.
BUILT 200 BY
STATE OF ILLINOIS
F.A.P. RT. 553 SEC. 125VBR-1
STA. 144+14.40 LOADING HS20
STR. NO. 019-0047

THESE PLANS ARE APPLICABLE TO THE BEAM AND BEARING FABRICATION ONLY. ALL OTHER DETAILS SHOWN ARE FOR INFORMATION ONLY.

NAME PLATE DETAIL
See Std. 515001

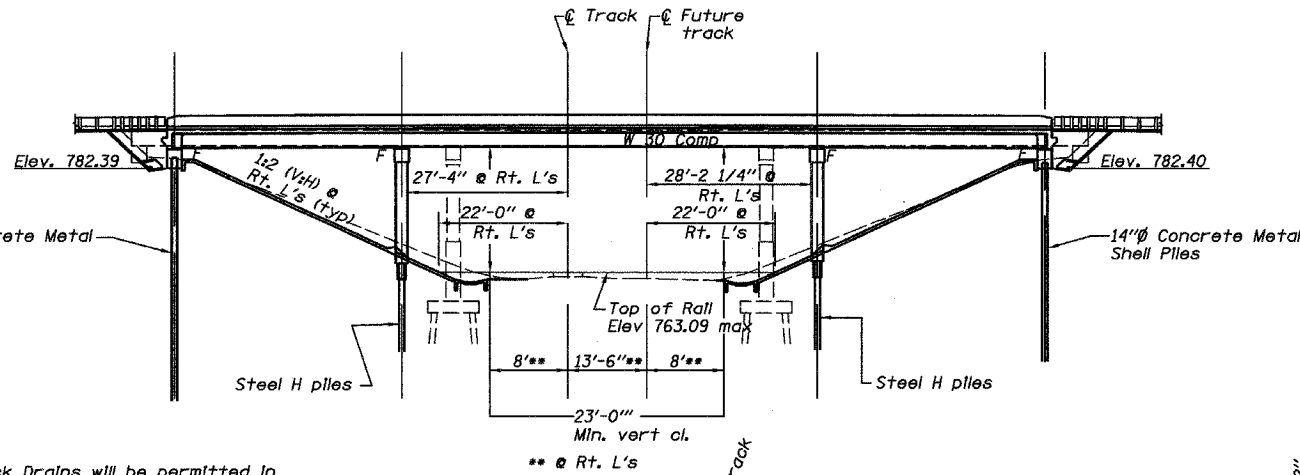

Note: No Deck Drains will be permitted in the spans over tracks or within 10' of cross arms of a railroad pole line.

ELEVATION

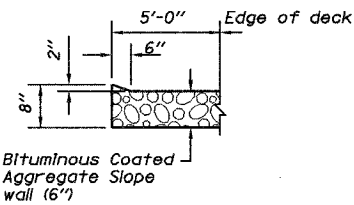

SECTION A-A

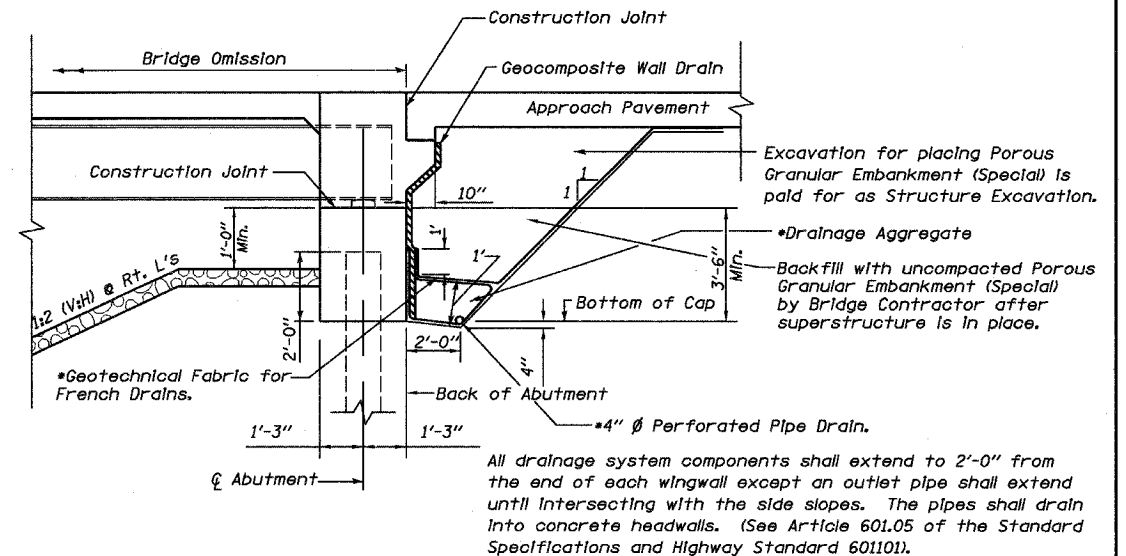
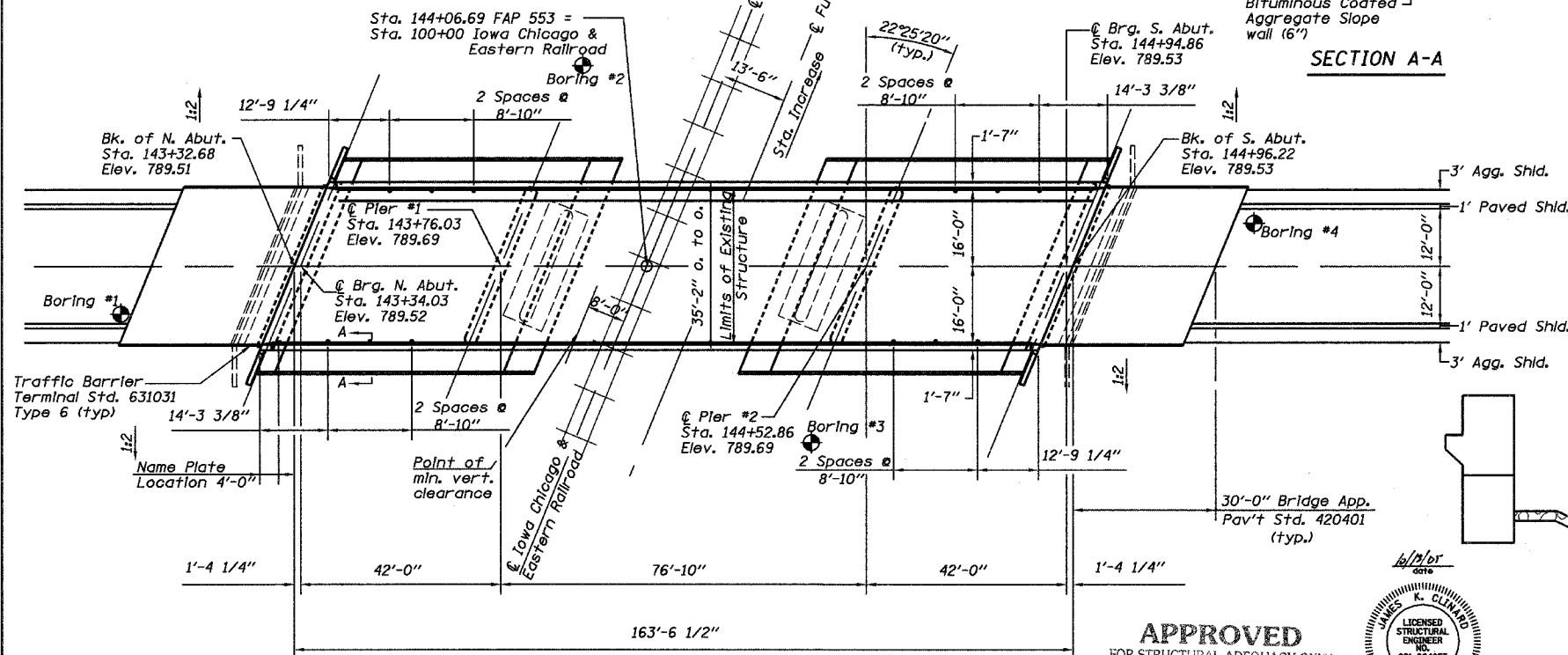

SECTION THRU INTEGRAL ABUTMENT

* Included in the cost of "Pipe Underdrains for Structures"



APPROVED
FOR STRUCTURAL ADEQUACY ONLY

ENGINEER OF BRIDGES AND STRUCTURES

LOADING HS20-44

Allow 50#/sq. ft. for future wearing surface.

DESIGN SPECIFICATIONS

2002 AASHTO

SEISMIC DATA

Seismic Performance Category (SPC) = A
Bedrock Acceleration Coefficient (A) = 0.04g
Site Coefficient (S) = 1.0

DESIGN STRESSES

FIELD UNITS

$f_c = 3,500$ psi
 $f_y = 50,000$ psi (Struct.) (M270 GRADE 50 W)
 $f_y = 60,000$ psi (Reinf.)

CHAMBLIN & ASSOCIATE
PERU ILLINOIS MORRIS

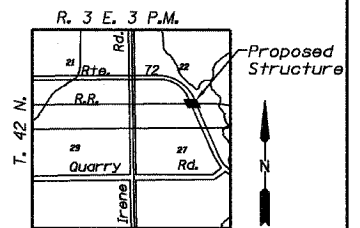

LOCATION SKETCH

GENERAL PLAN
IL RTE 72 OVER
IOWA CHICAGO & EASTERN RAILROAD
FAP ROUTE 553
SECTION 125VBR-1F
DEKALB COUNTY
STA. 144+14.40
SN 019-0047

Mile Post 70.0 =
Sta. 75+40.72

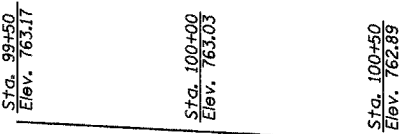

TOP OF RAIL ELEVATIONS
IOWA CHICAGO & EASTERN R.R.

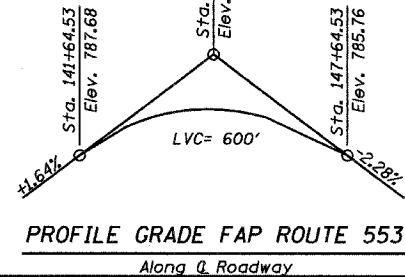

PROFILE GRADE FAP ROUTE 553
Along Q Roadway