

F.A.U. RTE.	SECTION	COUNTY	TOTAL SHEETS	SHEET NO.
*	**	SANGAMON	261	48
STA.		TO STA.		
FED. ROAD DIST. NO.	ILLINOIS	FED. AID PROJECT		
* 7968 (OLD US 36) & 7968 (CAMP BUTLER RD.)				
** 3R(BR, BR-1, BR-2), 19RS-8				

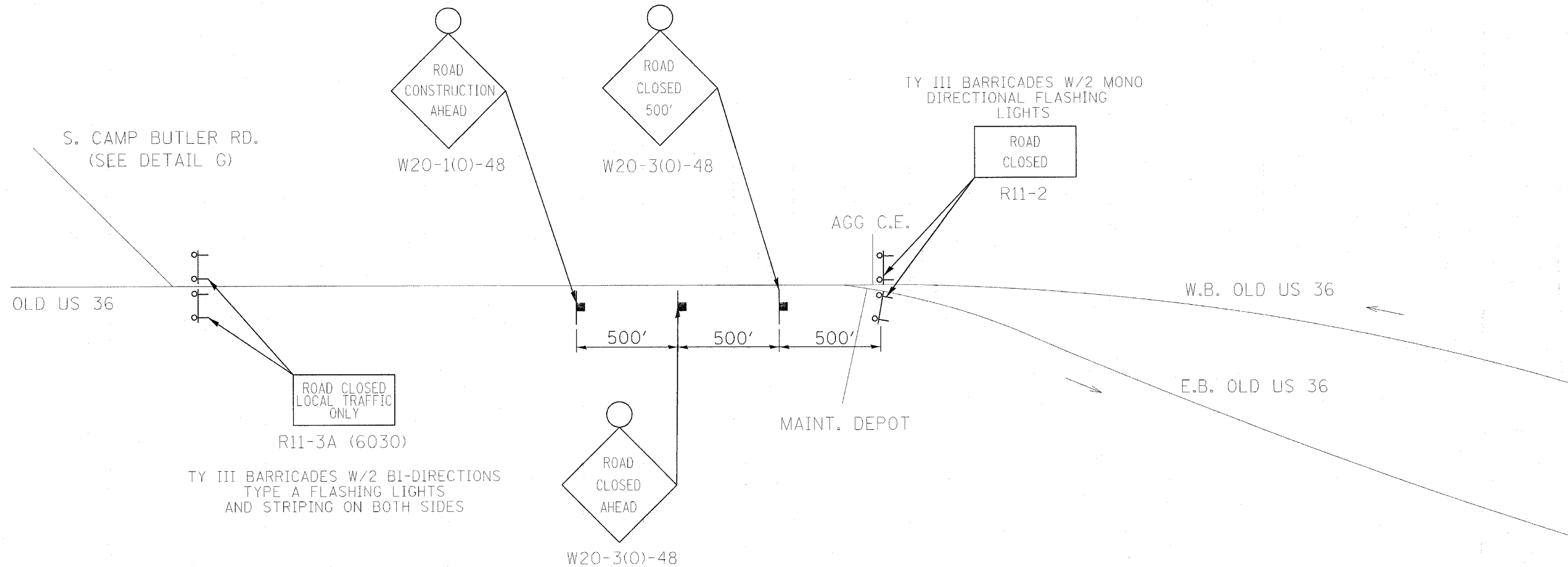

# DETAIL B

REVISIONS	
NAME	DATE

ILLINOIS DEPARTMENT OF TRANSPORTATION

**ROAD CLOSURE DETAILS**

F.A.U. Route 7978 (OLD US 36)  
F.A.U. Route 7968 (CAMP BUTLER RD.)  
Section 3R(BR, BR-1, BR-2), 19RS-8  
SANGAMON COUNTY

SCALE: VERT. \_\_\_\_\_  
HORIZ. \_\_\_\_\_

DATE: SEPTEMBER 7, 2005

DRAWN BY JWC  
CHECKED BY RSC

PLOT DATE = 11/2/2005  
FILE NAME = c:\p\proj\72449\72449.dgn  
PLOT SCALE = 20,0000' / IN.  
USER NAME = cojm