

F.A.U. RTE.	SECTION	COUNTY	TOTAL SHEETS	SHEET NO.
•	••	SANGAMON	261	55
STA. 88+50.00		TO STA. 277+50.00		
FED. ROAD DIST. NO.		ILLINOIS FED. AID PROJECT		
• 7978 (OLD US 36) & 7968 (CAMP BUTLER RD.)		•• 3R(BR, BR-1, BR-2), 19RS-8		

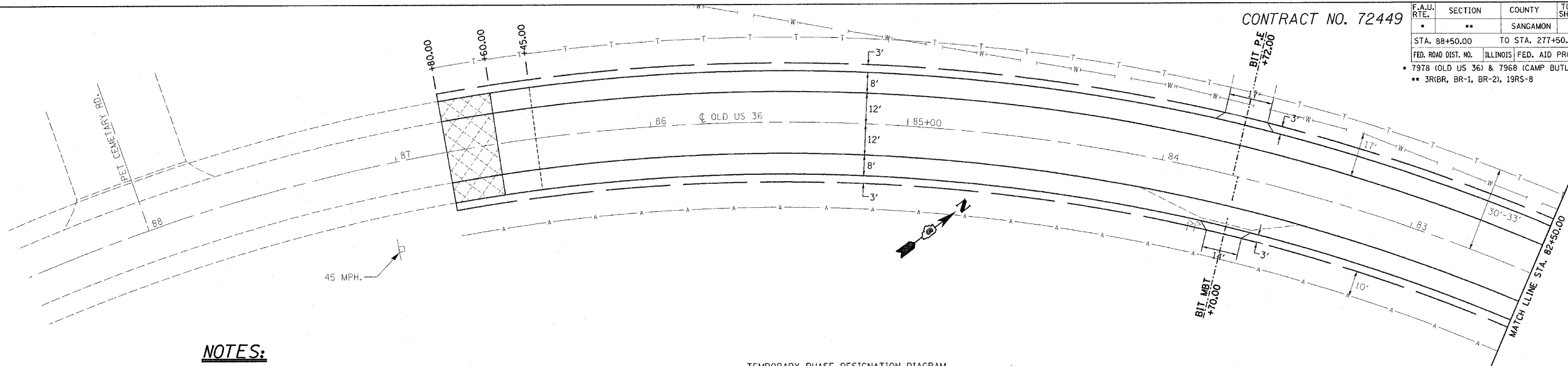

NOTES:

- ① THE BUREAU OF OPERATIONS SHALL BE NOTIFIED 14 DAYS PRIOR TO THE PLACEMENT OF THE FINAL PAVEMENT MARKINGS TO VERIFY NO PASSING ZONES.
- ② THE BUREAU OF OPERATIONS SHALL BE NOTIFIED 5 DAYS IN ADVANCED OF THE PLACEMENT OF THE CONCRETE BARRIER WALL IN ORDER TO MANUFACTURE AND PLACE "MAX. WIDTH" SIGNS W12-2(O)-48 FLUORESCENT ORANGE IN COLOR. PLACEMENT SHALL BE AT EACH END OF THE BRIDGE 150m (500') BEYOND THE SIGN "ROAD CONSTRUCTION AHEAD" W20-1(O)-48. THE POSTED SPEED SHALL BE AGREED UPON AT THE PREJOB MEETING.
- ③ WHEN USING TRAFFIC STANDARD 701321, CRYSTAL REFLECTORS SHALL BE USED IN TANGENT SECTIONS OF THE TEMPORARY CONCRETE BARRIER. DOUBLE SIDED PANELS WITH BI-DIRECTIONAL STEADY BURNING LIGHTS SHALL BE USED IN THE TAPERED SECTIONS. THE PLACEMENT OF THESE ITEMS ARE SHOWN ON THE STANDARD SECTIONS.

TEMPORARY PHASE DESIGNATION DIAGRAM

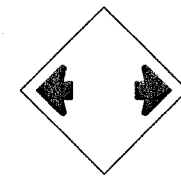
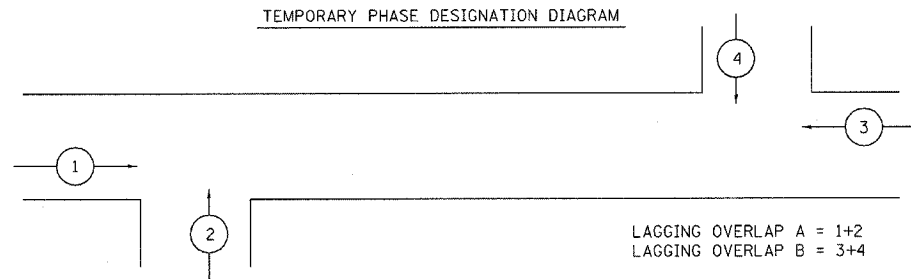

W12-2(O)-48

THE SIGN ABOVE SHALL BE MANUFACTURED, SUPPLIED, AND ERECTED BY THE CONTRACTOR. COST SHALL BE INCORPORATED WITH THE PAY ITEM TRAFFIC CONTROL AND PROTECTION, STANDARD 701321 (SPECIAL).

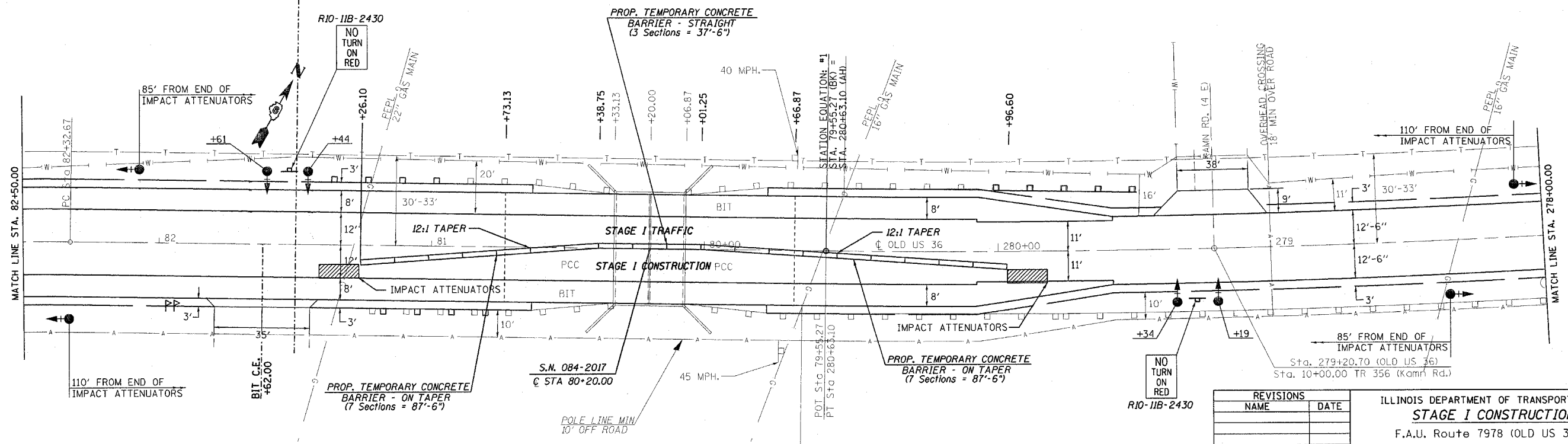

REVISIONS	
NAME	DATE

ILLINOIS DEPARTMENT OF TRANSPORTATION
STAGE I CONSTRUCTION
 F.A.U. Route 7978 (OLD US 36) &
 F.A.U. Route 7968 (CAMP BUTLER RD.)
 Section 3R(BR, BR-1, BR-2), 19RS-8
 SANGAMON COUNTY
 SCALE: VERT. _____
 HORIZ. _____
 DATE: OCTOBER 24, 2005
 DRAWN BY: _____
 CHECKED BY: RSC

PLOT DATE = 11/3/2005
 FILE NAME = c:\pro\proj\11\6652102\shststage1.dgn
 PLOT SCALE = 28.0000' / IN.
 USER NAME = tcochrane