

F.A.U. RTE.	SECTION	COUNTY	TOTAL SHEETS	SHEET NO.
*	**	SANGAMON	261	58

STA. 278+00.00 TO STA. 266+00.00
 FED. ROAD DIST. NO. ILLINOIS FED. AID PROJECT
 * 7978 (OLD US 36) & 7968 (CAMP BUTLER RD.)
 ** 3R(BR, BR-1, BR-2), 19RS-8
CONTRACT NO. 72449

(#6)

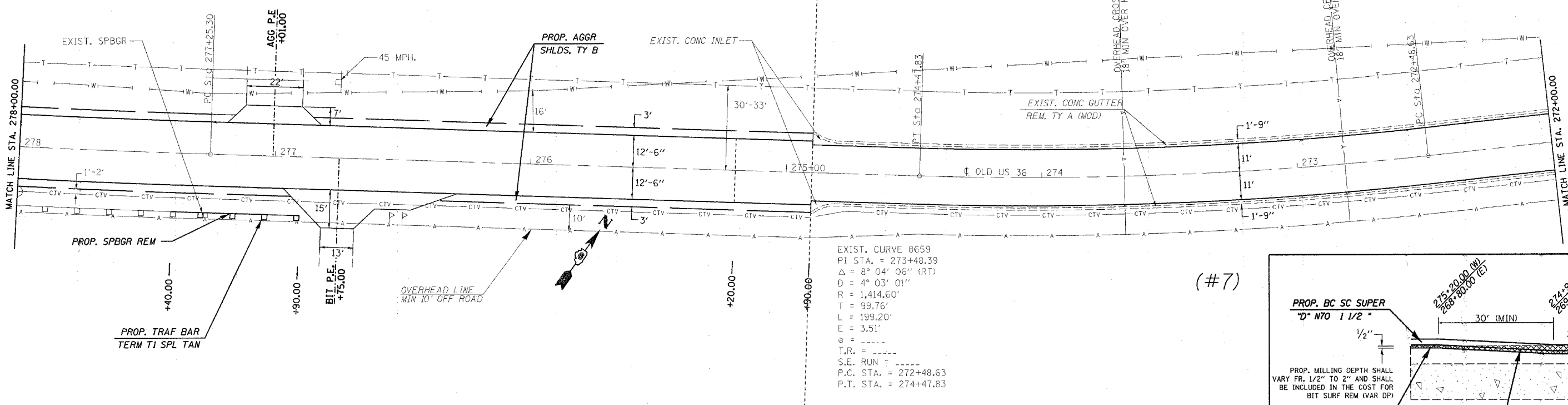

EXIST. CURVE 8659
 PI STA. = 273+48.39
 $\Delta = 8^\circ 04' 06''$ (RT)
 $D = 4^\circ 03' 01''$
 $R = 1,414.60'$
 $T = 99.76'$
 $L = 199.20'$
 $E = 3.51'$
 $e =$
 $T.R. =$
 $S.E. RUN =$
 P.C. STA. = 272+48.63
 P.T. STA. = 274+47.83

(#7)

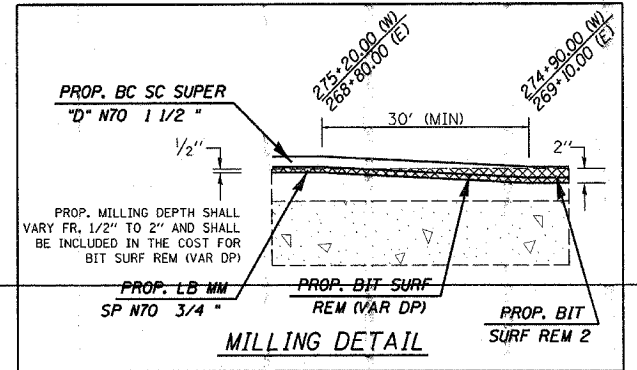

PLOT DATE = 11/2/2005
 FILE NAME = c:\projects\11652582\shp\plan1001.dgn
 PLOT SCALE = 28,00000 / IN.
 USER NAME = coxj

(#7)

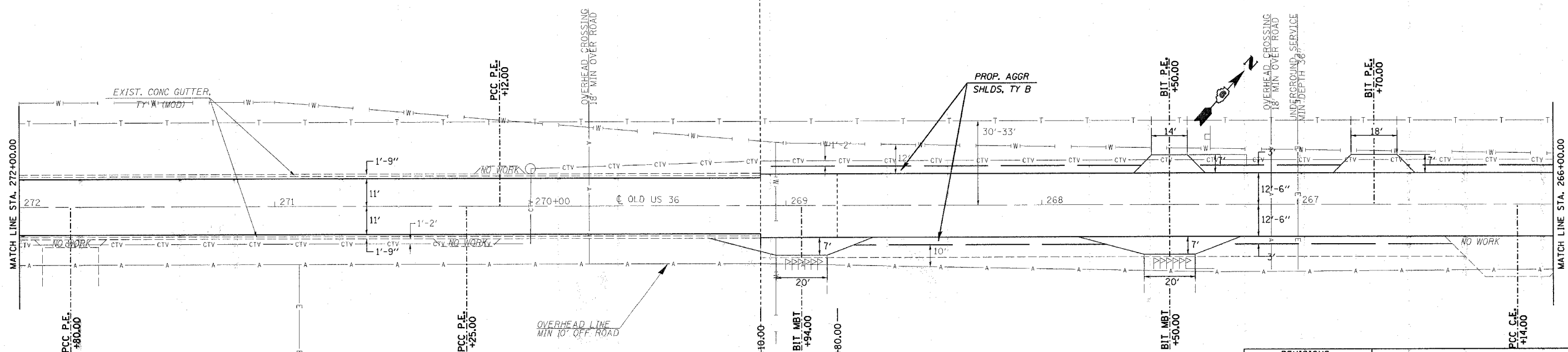

(#8)

REVISIONS	
NAME	DATE

ILLINOIS DEPARTMENT OF TRANSPORTATION
PLAN VIEW
 F.A.U. Route 7978 (OLD US 36) &
 F.A.U. Route 7968 (CAMP BUTLER RD.)
 Section 3R(BR, BR-1, BR-2), 19RS-8
 SANGAMON COUNTY
 SCALE: VERT. _____
 HORIZ. _____
 DATE: AUGUST 9, 2005
 DRAWN BY: JWC
 CHECKED BY: RSC