

CONTRACT NO. 72449

F.A.U. RTE.	SECTION	COUNTY	TOTAL SHEETS	SHEET NO.
•	••	SANGAMON	261	60
STA. 254+00.00 TO STA. 242+00.00				
FED. ROAD DIST. NO. ILLINOIS FED. AID PROJECT				
• 7978 (OLD US 36) & 7968 (CAMP BUTLER RD.)				
•• 3R(BR, BR-1, BR-2), 19RS-8				

(#8)

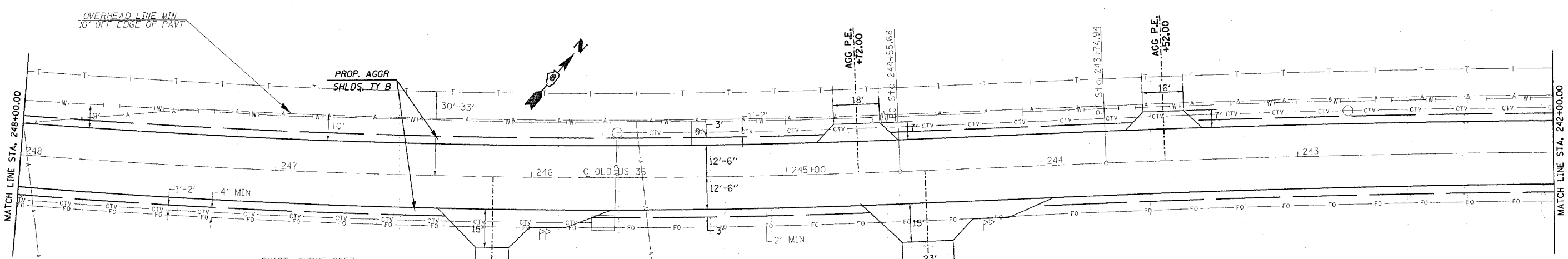
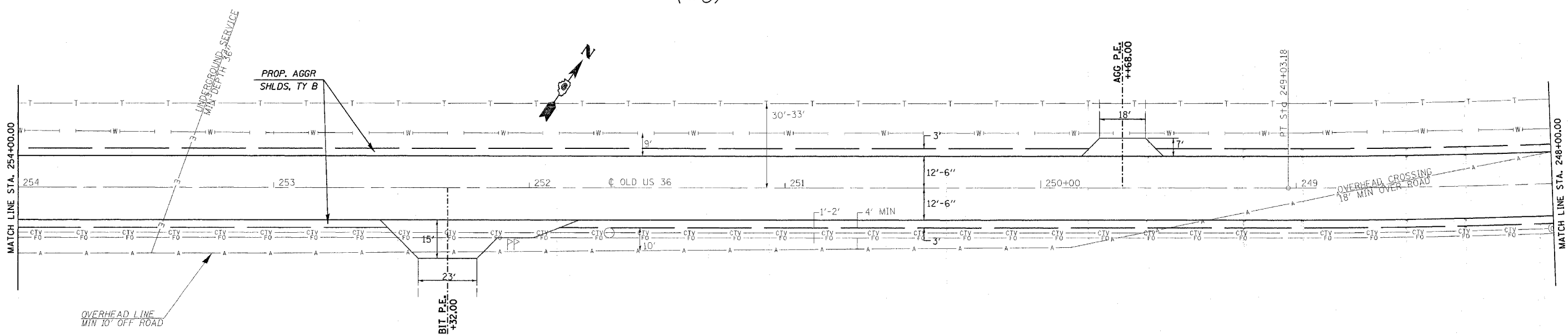

EXIST. CURVE 8657
 PI STA. = 246+79.89
 $\Delta = 8^\circ 59' 56''$ (RT)
 $D = 2^\circ 00' 39''$
 $R = 2,849.22'$
 $T = 224.21'$
 $L = 447.50'$
 $E = 8.81'$
 $e = \text{-----}$
 $T.R. = \text{-----}$
 $S.E. RUN = \text{-----}$
 $P.C. STA. = 244+55.68$
 $P.T. STA. = 249+03.18$

(#8)

REVISIONS	
NAME	DATE

ILLINOIS DEPARTMENT OF TRANSPORTATION
PLAN VIEW
 F.A.U. Route 7978 (OLD US 36) &
 F.A.U. Route 7968 (CAMP BUTLER RD.)
 Section 3R(BR, BR-1, BR-2), 19RS-8
 SANGAMON COUNTY
 VERT. SCALE: HORIZ.
 DATE: AUGUST 9, 2005
 DRAWN BY: JWC
 CHECKED BY: RSC

PLOT DATE = 11/27/2005
 FILE NAME = c:\cadd\proj\72449\shp\plan10010.dgn
 PLOT SCALE = 20.0000 / 1 IN.
 USER NAME = eckjv