

F.A.U. RTE.	SECTION	COUNTY	TOTAL SHEETS	SHEET NO.
•	••	SANGAMON	261	116
STA. ***		TO STA. ***		
FED. ROAD DIST. NO.		ILLINOIS FED. AID PROJECT		
• 7978 (US 36) & 7968 (CAMP BUTLER RD.) •• 3R(BR, BR-1, BR-2), 19RS-8 ••• E.B. OLD US 36 - STA 42+00.00 TO 48+50.00 ••• E.B. CAMP BUTLER RD. - STA 22+00.00 TO 26+19.40				

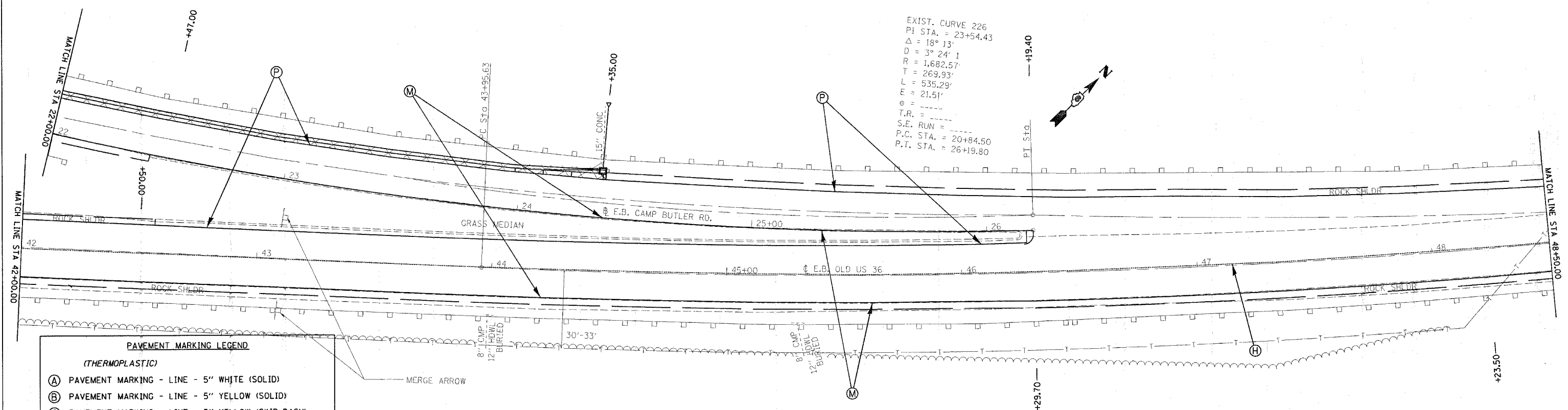

PAVEMENT MARKING LEGEND	
(THERMOPLASTIC)	
(A)	PAVEMENT MARKING - LINE - 5\"
(B)	PAVEMENT MARKING - LINE - 5\"
(C)	PAVEMENT MARKING - LINE - 5\"
(D)	PAVEMENT MARKING - LINE - 5\"
(E)	PAVEMENT MARKING - LINE - 6\"
(F)	PAVEMENT MARKING - LINE - 6\"
(G)	PAVEMENT MARKING - LINE - 12\"
(PREFORMED PLASTIC, TYPE B)	
(H)	PAVEMENT MARKING - LINE - 5\"
(I)	PAVEMENT MARKING - LINE - 6\"
(J)	PAVEMENT MARKING - LINE - 6\"
(K)	PAVEMENT MARKING - LINE - 24\"
(L)	PAVEMENT MARKING - LETTERS & SYMBOLS WHITE (SOLID)
(PAINT)	
(M)	PAVEMENT MARKING - LINE - 5\"
(N)	PAVEMENT MARKING - LINE - 8\"
(O)	PAVEMENT MARKING - LINE - 5\"
(P)	PAVEMENT MARKING - LINE - 5\"
(Q)	PAVEMENT MARKING - LINE - 5\"
(R)	PAVEMENT MARKING - LINE - 5\"

REVISIONS	
NAME	DATE

ILLINOIS DEPARTMENT OF TRANSPORTATION  
**PAVEMENT MARKING DETAILS**  
 F.A.U. Route 7978 (OLD US 36) &  
 F.A.U. Route 7968 (CAMP BUTLER RD.)  
 Section: 3R(BR, BR-1, BR-2), 19RS-8  
 SANGAMON COUNTY  
 VERT. SCALE:      DRAWN BY: JWC  
 HORIZ. SCALE:      CHECKED BY: RSC  
 DATE: JULY 20, 2005

**(E.B. OLD US 36 & E.B. CAMP BUTLER RD.)**

PLOT DATE  
 FILE NAME  
 PLOT SCALE  
 USER NAME  
 shspavementmarkings00111.dgn  
 Chain: E001