

F.A.U. RTE.	SECTION	COUNTY	TOTAL SHEETS	SHEET NO.
*	**	SANGAMON	261	118
STA. 6+00.00		TO STA. 11+00.00		
FED. ROAD DIST. NO.		ILLINOIS FED. AID PROJECT		
*7978 (OLD US 36) & 7968 (CAMP BUTLER RD.)				
**3R(BR, BR-1, BR-2), 19RS-8				

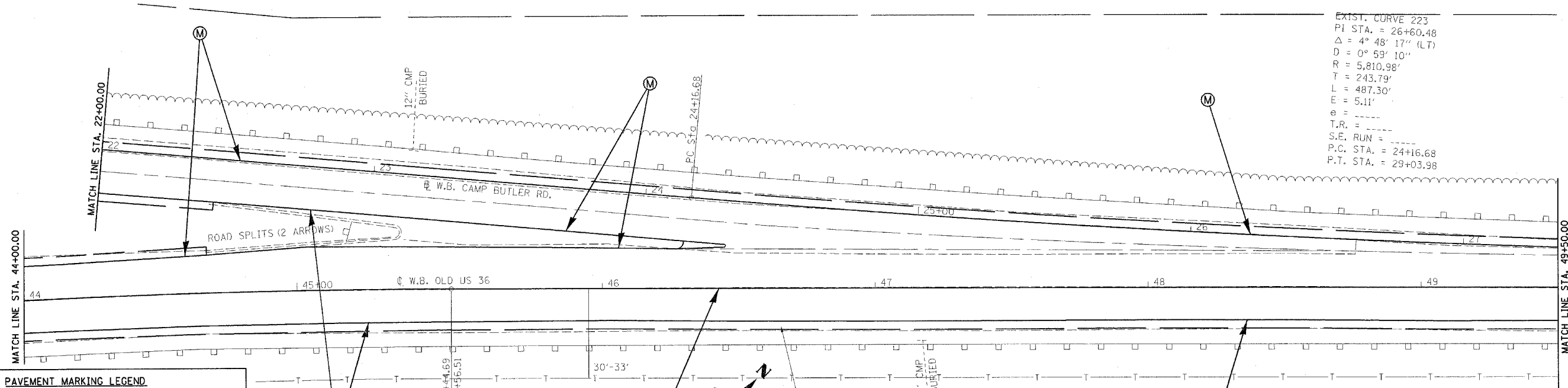

EXIST. CURVE 223  
 PI STA. = 26+60.48  
 $\Delta = 4^\circ 48' 17''$  (LT)  
 $D = 0^\circ 59' 10''$   
 $R = 5,810.98'$   
 $T = 243.79'$   
 $L = 487.30'$   
 $E = 5.11'$   
 $e =$   
 $T.R. =$   
 $S.E. RUN =$   
 $P.C. STA. = 24+16.68$   
 $P.T. STA. = 29+03.98$

**PAVEMENT MARKING LEGEND**

*(THERMOPLASTIC)*

- (A) PAVEMENT MARKING - LINE - 5" WHITE (SOLID)
- (B) PAVEMENT MARKING - LINE - 5" YELLOW (SOLID)
- (C) PAVEMENT MARKING - LINE - 5" YELLOW (SKIP-DASH)
- (D) PAVEMENT MARKING - LINE - 5" DOUBLE YELLOW (SOLID)
- (E) PAVEMENT MARKING - LINE - 6" WHITE (SOLID)
- (F) PAVEMENT MARKING - LINE - 6" WHITE (SKIP-DASH)
- (G) PAVEMENT MARKING - LINE - 12" YELLOW (SOLID)

---

*(PREFORMED PLASTIC, TYPE B)*

- (H) PAVEMENT MARKING - LINE - 5" WHITE (SKIP - DASH)
- (I) PAVEMENT MARKING - LINE - 6" WHITE (SOLID)
- (J) PAVEMENT MARKING - LINE - 6" WHITE (SKIP - DASH)
- (K) PAVEMENT MARKING - LINE - 24" WHITE (SOLID)
- (L) PAVEMENT MARKING - LETTERS & SYMBOLS WHITE (SOLID)

---

*(PAINT)*

- (M) PAVEMENT MARKING - LINE - 5" WHITE (SOLID)
- (N) PAVEMENT MARKING - LINE - 8" WHITE (SOLID)
- (O) PAVEMENT MARKING - LINE - 5" WHITE (SKIP - DASH)
- (P) PAVEMENT MARKING - LINE - 5" YELLOW (SOLID)
- (Q) PAVEMENT MARKING - LINE - 5" YELLOW (SKIP - DASH)
- (R) PAVEMENT MARKING - LINE - 5" DOUBLE YELLOW (SOLID)

REVISIONS	
NAME	DATE

ILLINOIS DEPARTMENT OF TRANSPORTATION  
**PAVEMENT MARKING DETAILS**  
 F.A.U. Route 7978 (OLD US 36) &  
 F.A.U. Route 7968 (CAMP BUTLER RD)  
 Section: 3R(BR, BR-1, BR-2), 19RS-8  
 SANGAMON COUNTY  
 SCALE: VERT. \_\_\_\_\_  
 HORIZ. \_\_\_\_\_  
 DATE: JULY 20, 2005  
 DRAWN BY: JWC  
 CHECKED BY: RSC

PLOT DATE = 11/3/2005  
 FILE NAME = c:\projects\0652102\shpavementmarking27.dgn  
 PLOT SCALE = 20/8000' / IN.  
 USER NAME = c:\brn\rsr