

**ELEVATION**  
(Looking West)

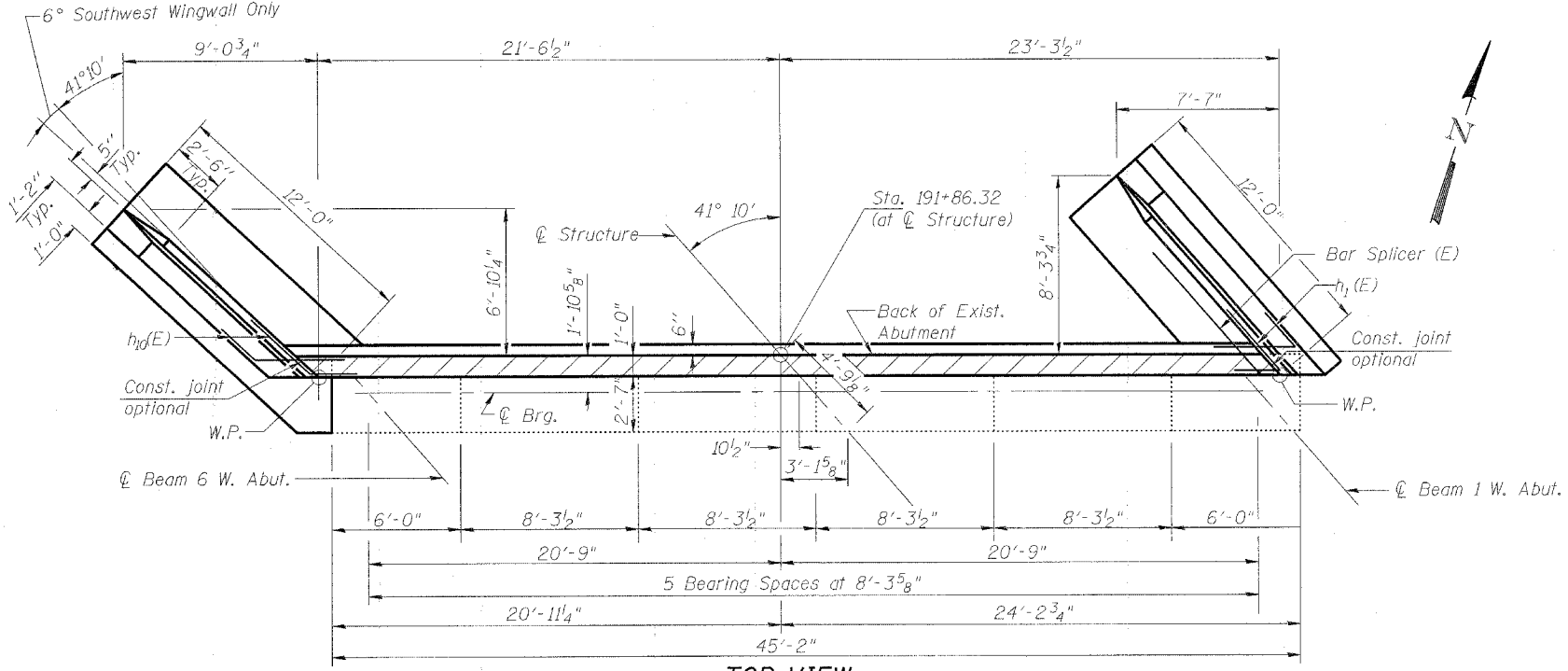

**TOP VIEW**

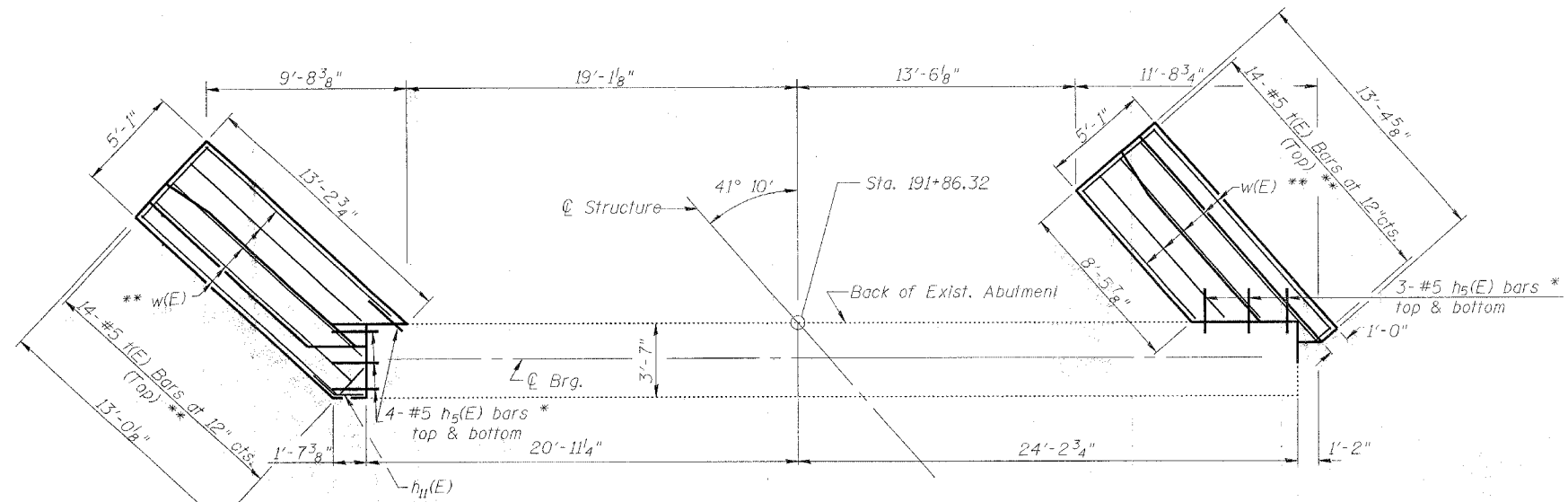

**PLAN-PILE CAP**  
(Wing Wall dowels not shown for clarity)

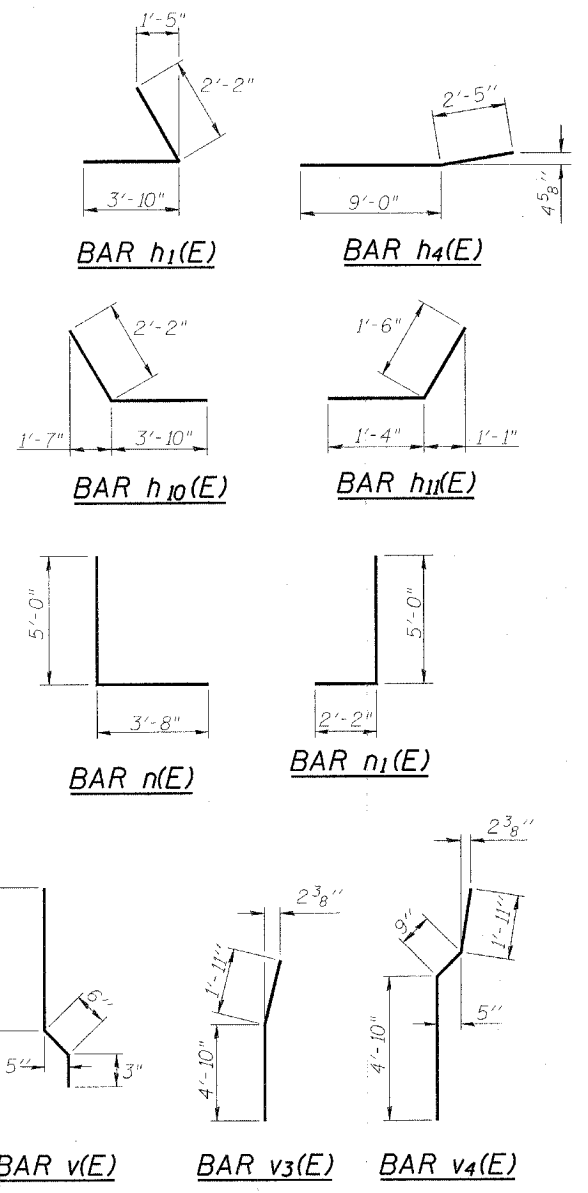

**BILL OF MATERIAL (WEST ABUT.)**

| BAR                              | NO. | SIZE    | LENGTH  | SHAPE |
|----------------------------------|-----|---------|---------|-------|
| h(E)                             | 12  | #5      | 44'-6"  | —     |
| h1(E)                            | 14  | #5      | 6'-0"   | └     |
| h3(E)                            | 10  | #4      | 10'-4"  | —     |
| h4(E)                            | 16  | #4      | 11'-5"  | —     |
| h5(E)                            | 14  | #5      | 2'-3"   | —     |
| h7(E)                            | 10  | #4      | 13'-0"  | —     |
| h8(E)                            | 2   | #4      | 11'-1"  | —     |
| h9(E)                            | 2   | #4      | 12'-2"  | —     |
| h10(E)                           | 12  | #5      | 6'-0"   | └     |
| h11(E)                           | 2   | #5      | 2'-10"  | └     |
| n(E)                             | 26  | #6      | 8'-8"   | └     |
| n1(E)                            | 26  | #6      | 7'-2"   | └     |
| v(E)                             | 28  | #5      | 4'-7"   | —     |
| v1(E)                            | 46  | #5      | 3'-5"   | └     |
| v2(E)                            | 26  | #6      | 7'-5"   | —     |
| v3(E)                            | 6   | #6      | 6'-9"   | └     |
| v4(E)                            | 20  | #6      | 7'-6"   | └     |
| w(E)                             | 20  | #5      | 12'-10" | —     |
| Structure Excavation             |     | Cu. Yd. | 129.9   |       |
| Concrete Structures              |     | Cu. Yd. | 23.1    |       |
| Reinforcement Bars, Epoxy Coated |     | Pound   | 3190    |       |
| Bar Splicers                     |     | Each    | 46      |       |

**NOTES:**

- Work this Sheet with Sheet 17 of 20.
- Reinforcement bars designated (E) shall be epoxy coated.
- Quantity of concrete in end post Included with Concrete Superstructure on Sheet 6 of 20.
- See Sheet 19 of 20 for details of Bar Splicers.
- See Sheet 17 of 20 for Wing Wall Elevations and Section Thru Abutment.
- All edges have 3/4" chamfer except as noted.
- Hatched area to be poured after superstructure forms have been removed. Quantity of concrete included with Concrete Superstructure on Sheet 6 of 20.
- \* Epoxy grout h5(E) bars in 7" (Min.) drilled holes according to Art. 584 of the Standard Specifications. Cost included with "Concrete Structures".
- \*\* Reinforcement shall be cut off to maintain 1 1/2" cover at existing structure and be epoxy coated. Cost included in cost of Reinforcement Bars, Epoxy Coated.

**MIN BAR LAPS**  
#5 bars = 1'-8"  
#6 bars = 2'-0"

ILLINOIS DEPARTMENT OF TRANSPORTATION

**WEST ABUTMENT**

OLD U.S. ROUTE 36 OVER  
N.B. 7TH STREET RAMP  
F.A.U. ROUTE 797B  
SECTION BR-2  
SANGAMON COUNTY  
STA. 192+62.16  
STRUCTURE NUMBER 084-0053

DATE: JAN. 2005  
DRAWN BY: NUJ  
CHECKED BY: PBB