

BILL OF MATERIAL (EAST ABUT.)

BAR	NO.	SIZE	LENGTH	SHAPE
h(E)	12	#5	44'-6"	—
h ₁ (E)	14	#5	6'-0"	—
h ₂ (E)	12	#5	6'-0"	—
h ₃ (E)	10	#4	10'-4"	—
h ₄ (E)	16	#4	11'-5"	—
h ₅ (E)	14	#5	2'-3"	—
h ₆ (E)	2	#5	3'-0"	—
h ₇ (E)	10	#4	13'-0"	—
h ₈ (E)	2	#4	11'-1"	—
h ₉ (E)	2	#4	12'-2"	—
n(E)	26	#6	8'-8"	—
n ₁ (E)	26	#6	7'-2"	—
r(E)	28	#5	4'-7"	—
v(E)	46	#5	3'-5"	—
v ₁ (E)	92	#5	3'-9"	—
v ₂ (E)	26	#6	7'-5"	—
v ₃ (E)	6	#6	6'-9"	—
v ₄ (E)	20	#6	7'-6"	—
w(E)	20	#5	12'-10"	—
Structure Excavation		Cu. Yd.	130.3	
Concrete Structures		Cu. Yd.	23.1	
Reinforcement Bars, Epoxy Coated		Pound	3190	
Bar Splicers		Each	46	

NOTES:

- Work this Sheet with Sheet 17 of 20.
- Reinforcement bars designated (E) shall be epoxy coated.
- Quantity of concrete in end post included with Concrete Superstructure on Sheet 6 of 20.
- See Sheet 19 of 20 for details of Bar Splicers.
- See Sheet 17 of 20 for Wing Wall Elevations and Section Thru Abutment.
- All edges have 3/4" chamfer except as noted.
- Hatched area to be poured after superstructure forms have been removed. Quantity of concrete included with Concrete Superstructure on Sheet 6 of 20.
- * Epoxy grout h₅(E) bars in 7" (Min.) drilled holes according to Art. 584 of the Standard Specifications. Cost included with "Concrete Structures".
- ** Reinforcement shall be cut off to maintain 1/2" cover at existing structure and be epoxy coated. Cost included in cost of Reinforcement Bars, Epoxy Coated.

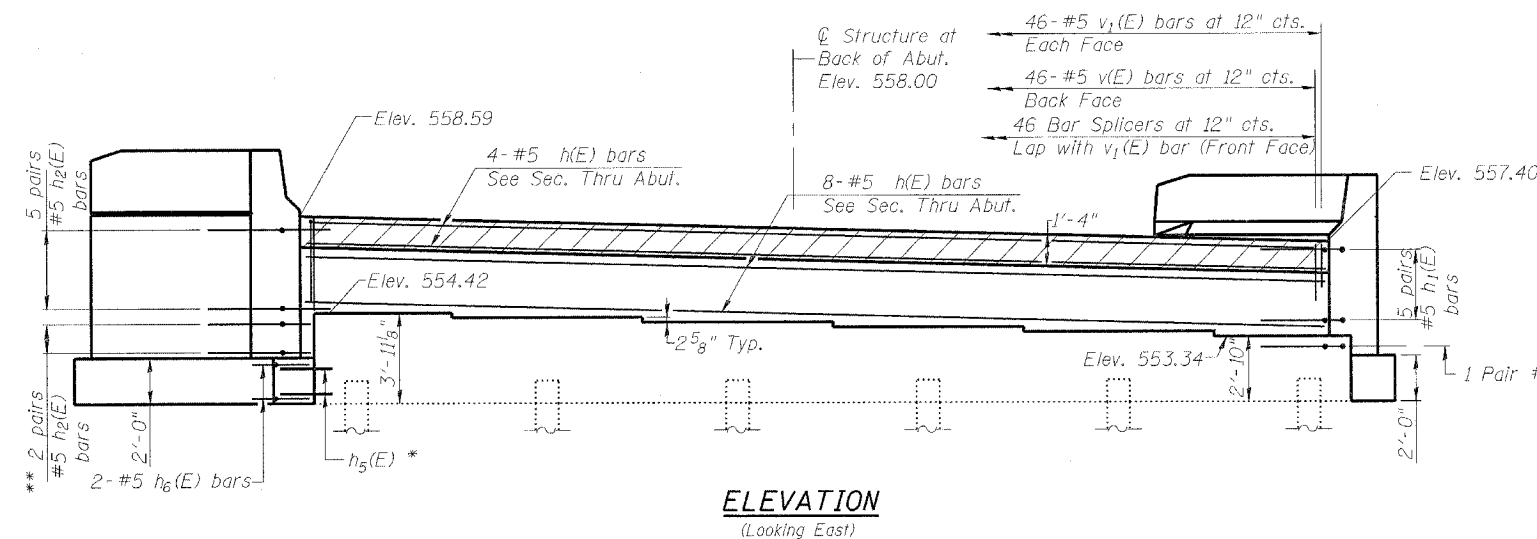

ELEVATION
(Looking East)

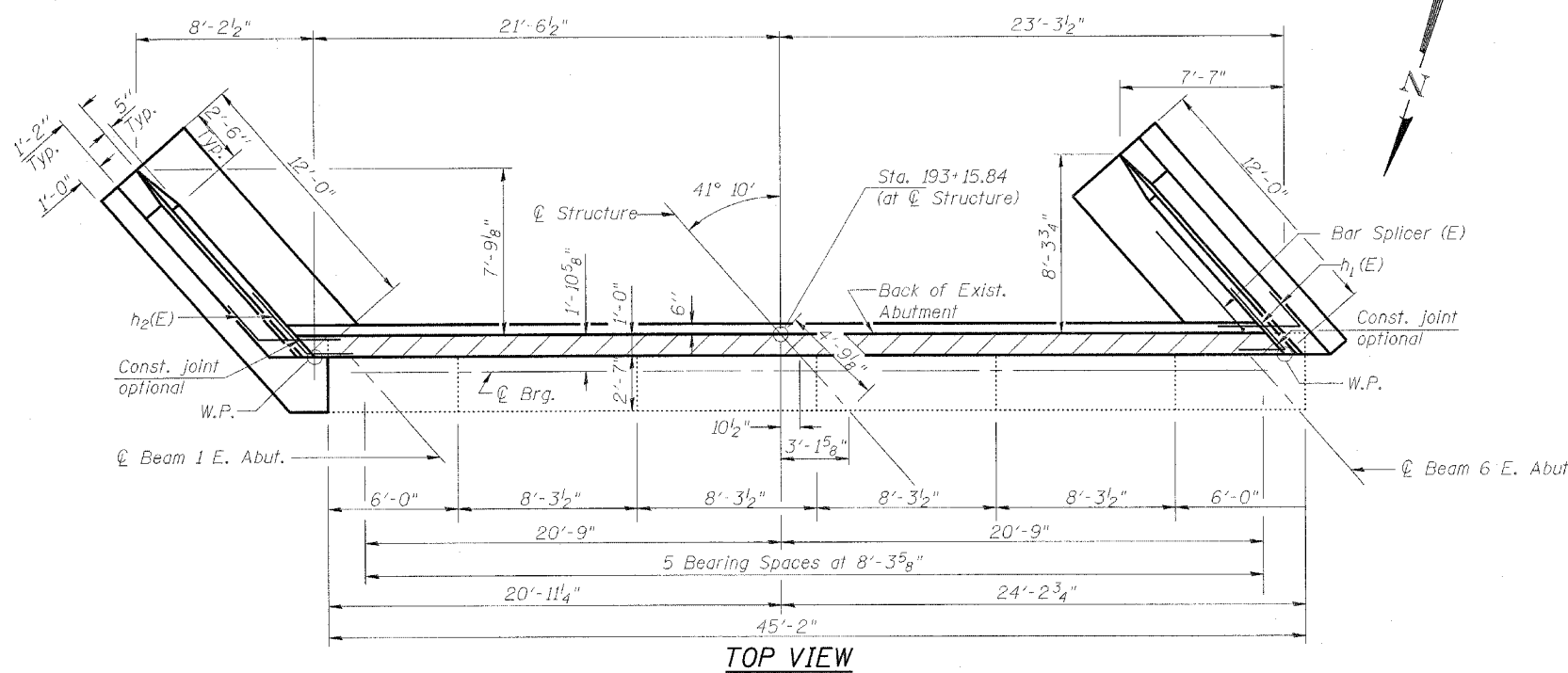

TOP VIEW

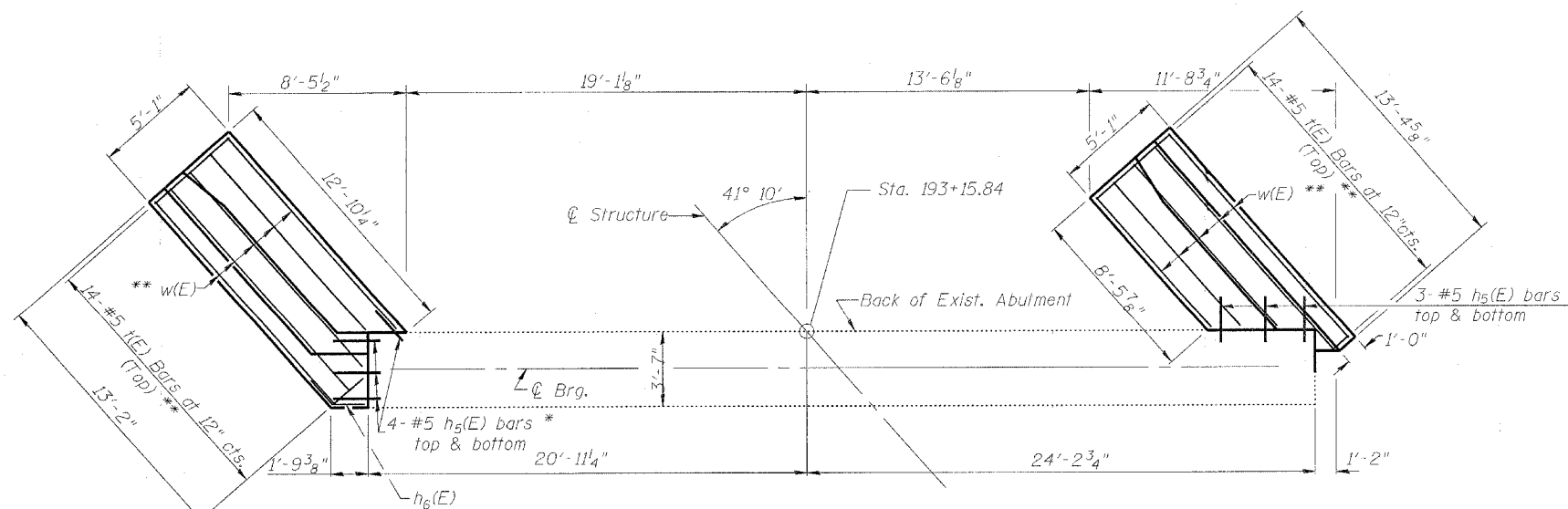

PLAN-PILE CAP
(Wing Wall dowels not shown for clarity)

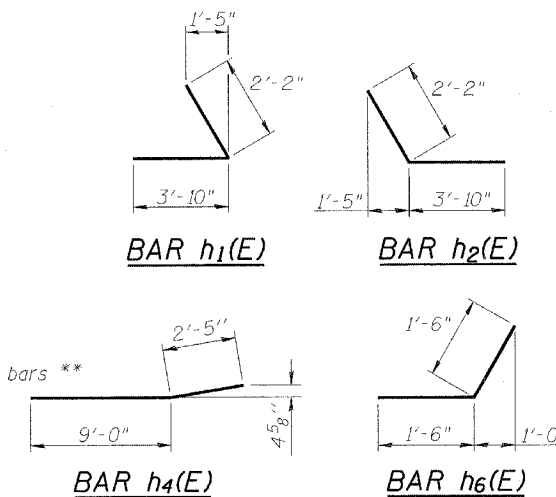

BAR h₁(E)

BAR h₂(E)

BAR h₄(E)

BAR h₆(E)

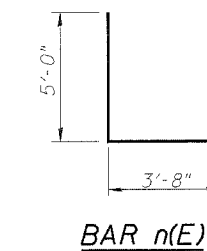

BAR n(E)

BAR n₁(E)

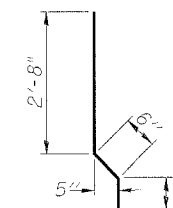

BAR v(E)

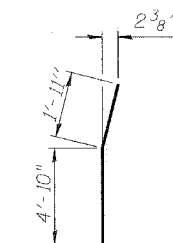

BAR v₃(E)

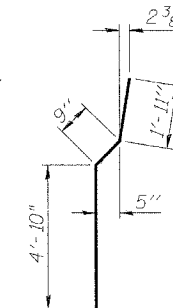

BAR v₄(E)

MIN BAR LAPS
#5 bars = 1'-8"
#6 bars = 2'-0"

ILLINOIS DEPARTMENT OF TRANSPORTATION

EAST ABUTMENT
OLD U.S. ROUTE 36 OVER
N.B. 7TH STREET RAMP
F.A.U. ROUTE 7978
SECTION BR-2
SANGAMON COUNTY
STA. 192+62.16
STRUCTURE NUMBER 084-0053

DATE: JAN. 2005

DRAWN BY: NJV
CHECKED BY: PBB