

STATE OF ILLINOIS  
DEPARTMENT OF TRANSPORTATION

ROUTE NO.	SECTION	COUNTY	TOTAL SHEETS	SHEET NO.	SHEET NO. 4 33 SHEETS
FAU 7968	*	SANGAMON	261	174	
FED. ROAD DIST. NO. 7	ILLINOIS	FED. AID PROJECT			

Contract #72449 \*SECTION 3R(BR, BR-1, BR-2)19RS-8

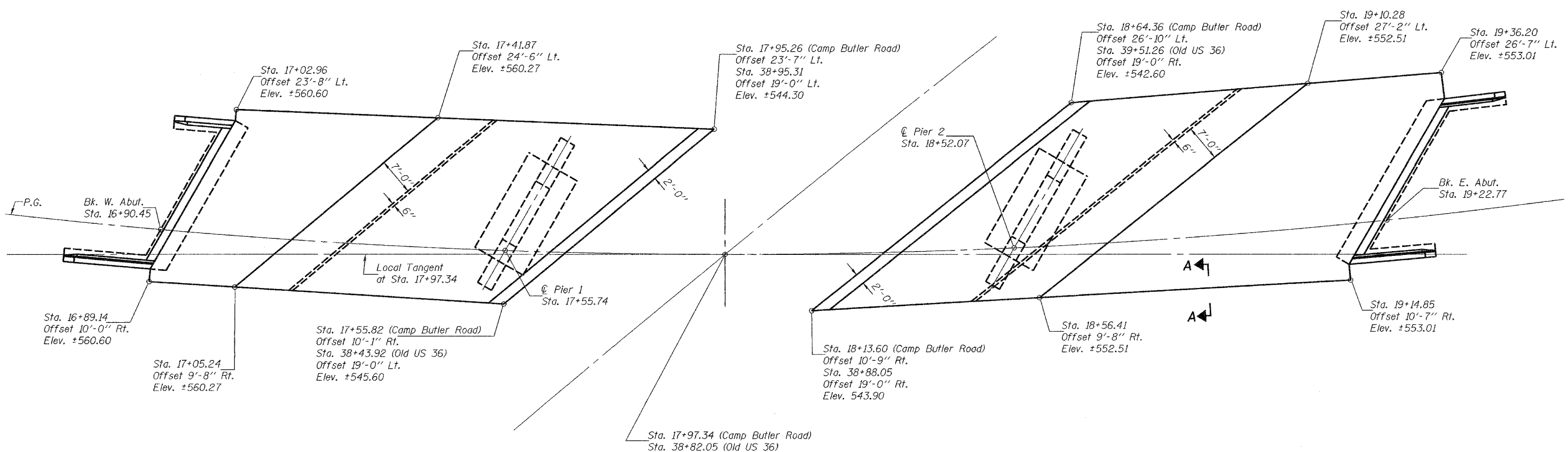
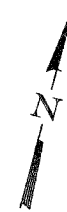

Note: Offsets are measured radially with respect to P.G. Line

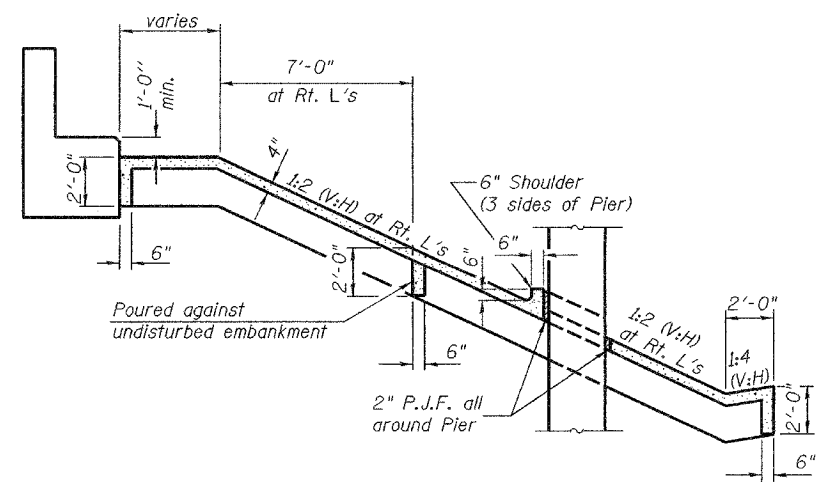
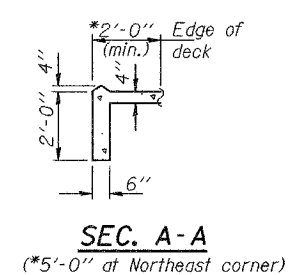

**SLOPE WALL DETAILS**  
F.A.U. ROUTE 7968  
SECTION 3R(BR, BR-1, BR-2)19RS-8  
SANGAMON COUNTY  
STATION 17+97.34  
STRUCTURE NO. 084-0518

DESIGNED	J. Mann
CHECKED	G. Ahanchi
DRAWN	BECKY M. LEACH
CHECKED	JWM/GRA

December 1, 2005  
EXAMINED *Thomas J. Demagalli*  
PASSED *Ralph E. Anderson*  
ENGINEER OF BRIDGE DESIGN  
ENGINEER OF BRIDGES AND STRUCTURES