

STATE OF ILLINOIS
DEPARTMENT OF TRANSPORTATION

ROUTE NO.	SECTION	COUNTY	SHEET NO.	SHEET
FAU 7968	*	SANGAMON	261	182
FED. ROAD DIST. NO. 7	ILLINOIS	FED. AID PROJECT-		

SHEET NO. 12
33 SHEETS
Contract #72449 *SECTION 3R(BR, BR-1, BR-2)19RS-8

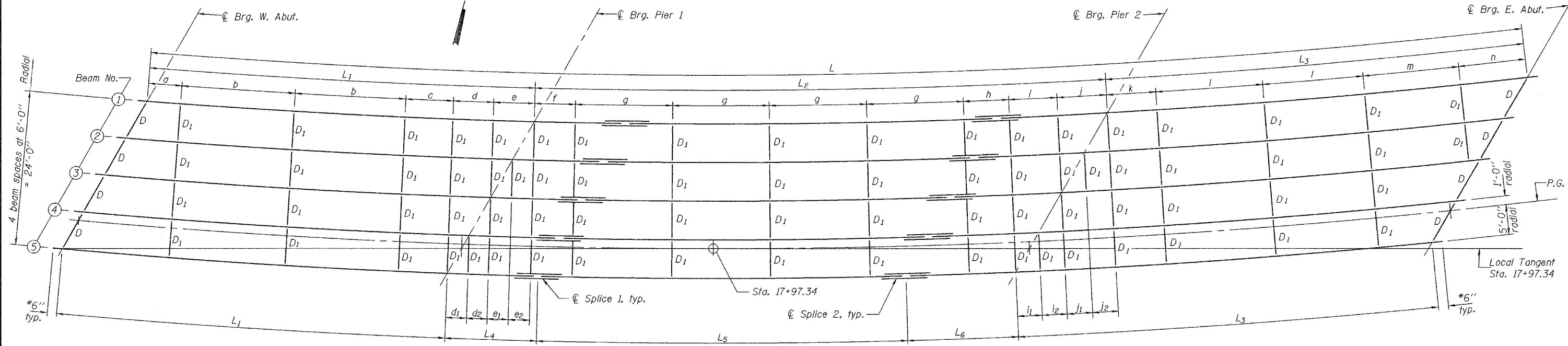

PLAN

All beams are W36x160 M 270, Grade 50 (NTR).

*Measured along \bar{c} beam

TABLE OF "L" DIMENSIONS

Beam No.	Radius (ft.)	L	L ₁	L ₂	L ₃	L ₄	L ₅	L ₆
1	1195.36	226'-7 ⁷ / ₈ "	62'-2 ³ / ₄ "	96'-10 ³ / ₈ "	67'-6"	17'-3 ¹ / ₄ "	61'-6"	18'-1 ¹ / ₈ "
2	1201.36	226'-2 ¹ / ₈ "	62'-1 ³ / ₄ "	96'-8 ⁵ / ₁₆ "	67'-4 ¹ / ₁₆ "	17'-4 ³ / ₁₆ "	61'-6"	17'-10 ¹ / ₁₆ "
3	1207.36	225'-9 ¹ / ₄ "	62'-0 ¹³ / ₁₆ "	96'-6 ¹ / ₄ "	67'-2 ³ / ₁₆ "	17'-3 ³ / ₁₆ "	61'-8"	17'-7 ¹ / ₈ "
4	1213.36	225'-4 ¹ / ₂ "	61'-11 ⁷ / ₈ "	96'-4 ⁵ / ₁₆ "	67'-0 ⁵ / ₁₆ "	17'-8 ¹ / ₈ "	61'-4"	17'-4 ³ / ₁₆ "
5	1219.36	224'-11 ¹³ / ₁₆ "	61'-11"	96'-2 ⁵ / ₁₆ "	66'-10 ¹ / ₂ "	17'-5"	61'-8"	17'-1 ⁵ / ₁₆ "

TABLE OF OFFSET DIMENSIONS

Beam No.	\bar{c} Brg. W. Abut.		\bar{c} Brg. Pier 1		\bar{c} Brg. Splice 1		\bar{c} Brg. Splice 2		\bar{c} Brg. Pier 2		\bar{c} Brg. E. Abut.	
	X	Y	X	Y	X ₁	Y ₁	X ₂	Y ₂	X	Y	X	Y
1	2'-1 ¹ / ₁₆ "	3'-7 ⁷ / ₁₆ "	0'-2 ³ / ₄ "	0'-4 ³ / ₄ "	13'-6 ⁷ / ₁₆ "	0'-0 ¹⁵ / ₁₆ "	47'-11 ³ / ₈ "	0'-11 ⁹ / ₁₆ "	1'-0 ⁵ / ₈ "	1'-9 ⁷ / ₈ "	4'-3 ⁵ / ₈ "	7'-5 ⁷ / ₁₆ "
2	2'-2 ³ / ₄ "	3'-10 ³ / ₈ "	0'-3 ³ / ₈ "	0'-5 ⁷ / ₈ "	16'-10 ⁷ / ₁₆ "	0'-1 ⁷ / ₁₆ "	44'-7 ⁷ / ₁₆ "	0'-9 ¹⁵ / ₁₆ "	0'-11 ¹ / ₄ "	1'-7 ¹ / ₂ "	4'-0 ⁹ / ₁₆ "	7'-0 ¹ / ₁₆ "
3	2'-4 ¹ / ₂ "	4'-1 ³ / ₈ "	0'-4 ¹ / ₁₆ "	0'-7 ¹ / ₁₆ "	20'-4 ³ / ₈ "	0'-2 ¹ / ₁₆ "	41'-3 ¹ / ₂ "	0'-8 ¹ / ₂ "	0'-9 ¹⁵ / ₁₆ "	1'-5 ¹ / ₄ "	3'-9 ⁹ / ₁₆ "	6'-6 ¹⁵ / ₁₆ "
4	2'-6 ⁵ / ₁₆ "	4'-4 ⁷ / ₁₆ "	0'-4 ¹³ / ₁₆ "	0'-8 ⁹ / ₁₆ "	23'-4 ⁹ / ₁₆ "	0'-2 ¹ / ₁₆ "	37'-11 ⁵ / ₈ "	0'-7 ¹ / ₂ "	0'-8 ³ / ₄ "	1'-3 ³ / ₈ "	3'-6 ¹ / ₁₆ "	6'-1 ¹⁵ / ₁₆ "
5	2'-8 ¹ / ₈ "	4'-7 ⁵ / ₈ "	0'-5 ⁵ / ₈ "	0'-9 ¹ / ₁₆ "	27'-0 ¹ / ₈ "	0'-3 ⁹ / ₁₆ "	34'-7 ³ / ₄ "	0'-5 ¹⁵ / ₁₆ "	0'-7 ⁵ / ₈ "	1'-1 ³ / ₁₆ "	3'-3 ¹⁵ / ₁₆ "	5'-9 ³ / ₁₆ "

**TOP OF BEAM ELEVATIONS

Location	Beam 1	Beam 2	Beam 3	Beam 4	Beam 5
\bar{c} Brg. W. Abut.	565.242	565.749	566.255	566.759	567.261
\bar{c} Pier 1	563.833	564.376	564.917	565.457	566.001
\bar{c} Splice 1	563.442	563.993	564.545	565.086	565.647
\bar{c} Splice 2	561.415	562.012	562.605	563.197	563.779
\bar{c} Pier 2	560.623	561.245	561.863	562.478	563.084
\bar{c} Brg. E. Abut.	557.669	558.352	559.030	559.703	560.370

**For fabrication only.

*TABLE OF a thru n DIMENSIONS

Beam No.	a	b	c	d	d ₁	d ₂	e	e ₁	e ₂	f	g	h	i	i ₁	i ₂	j	J ₁	J ₂	k	l	m	n
1	6'-5 ³ / ₄ "	17'-6"	8'-0"	6'-3 ⁵ / ₈ "	-	-	6'-5 ³ / ₈ "	-	-	9'-2 ⁵ / ₈ "	16'-0 ¹ / ₁₆ "	8'-1 ³ / ₁₆ "	7'-6 ³ / ₄ "	-	-	7'-9"	-	-	8'-0"	16'-0"	16'-0"	11'-6"
2	9'-4 ¹ / ₂ "	17'-7 ¹ / ₁₆ "	8'-0 ¹ / ₂ "	6'-4"	-	-	-	3'-2 ⁵ / ₈ "	3'-3 ¹ / ₈ "	9'-3 ³ / ₁₆ "	16'-1 ¹ / ₁₆ "	8'-1 ¹ / ₁₆ "	7'-7 ¹ / ₄ "	-	-	-	3'-10 ⁷ / ₁₆ "	3'-11"	8'-0 ¹ / ₂ "	16'-0 ¹⁵ / ₁₆ "	16'-0 ¹⁵ / ₁₆ "	7'-1 ¹ / ₁₆ "
3	12'-3 ¹ / ₄ "	17'-8 ¹ / ₈ "	8'-0 ¹⁵ / ₁₆ "	6'-4 ³ / ₈ "	-	-	-	3'-2 ⁷ / ₈ "	3'-3 ⁵ / ₁₆ "	9'-3 ³ / ₄ "	16'-2 ⁵ / ₈ "	8'-2 ³ / ₁₆ "	7'-7 ¹ / ₁₆ "	-	-	-	3'-10 ¹ / ₁₆ "	3'-11 ¹ / ₄ "	8'-0 ¹⁵ / ₁₆ "	16'-1 ¹⁵ / ₁₆ "	16'-1 ¹⁵ / ₁₆ "	2'-9 ¹ / ₂ "
4	15'-1 ¹⁵ / ₁₆ "	17'-9 ³ / ₁₆ "	8'-1 ⁷ / ₁₆ "	-	3'-2 ³ / ₁₆ "	3'-2 ⁵ / ₈ "	6'-6 ⁹ / ₁₆ "	-	-	9'-4 ¹ / ₄ "	16'-3 ⁵ / ₈ "	8'-2 ⁵ / ₈ "	-	3'-9 ¹³ / ₁₆ "	3'-10 ³ / ₈ "	7'-10 ³ / ₈ "	-	-	8'-1 ⁷ / ₁₆ "	16'-2 ⁷ / ₈ "	14'-8 ³ / ₈ "	-
5	18'-0 ⁵ / ₈ "	17'-10 ³ / ₁₆ "	8'-1 ¹⁵ / ₁₆ "	-	3'-2 ³ / ₈ "	3'-2 ¹³ / ₁₆ "	6'-6 ¹⁵ / ₁₆ "	-	-	9'-4 ¹³ / ₁₆ "	16'-4 ⁹ / ₁₆ "	8'-3 ¹ / ₈ "	-	3'-10"	3'-10 ⁹ / ₁₆ "	7'-10 ⁷ / ₈ "	-	-	8'-1 ¹⁵ / ₁₆ "	16'-3 ⁷ / ₈ "	10'-5 ³ / ₈ "	-

DESIGNED	J. Mann
CHECKED	G. Ahanchi
DRAWN	BECKY M. LEACH
CHECKED	JWM/GRA

EXAMINED	December 1, 2005
THOMAS J. DOMAGALSKI	PRINCIPAL ENGINEER OF BRIDGE DESIGN
PASSED	PAUL E. ANDERSON
	ENGINEER OF BRIDGES AND STRUCTURES

Tangent to beam at Sta. 17+97.34 (parallel to Local Tangent at Sta. 17+97.34)

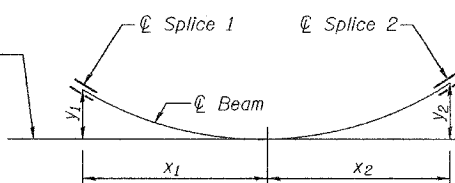

SPLICE OFFSET DETAIL

x₁ & x₂ dimensions are parallel to the respective beam tangent at Sta. 17+97.34.
y₁ & y₂ dimensions are at right angles to the respective beam tangent at Sta. 17+97.34.

Tangent to beam at Sta. 17+97.34 (parallel to Local Tangent at Sta. 17+97.34)

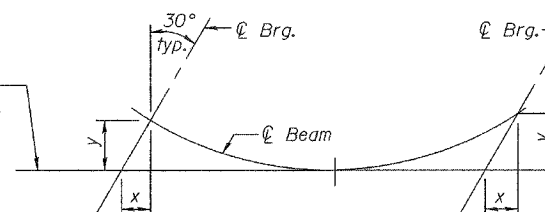

\bar{c} BRG. OFFSET DETAIL

x & y dimensions are given from the respective local tangent of each beam at Sta. 17+97.34.

STRUCTURAL STEEL
F.A.U. ROUTE 7968
SECTION 3R(BR, BR-1, BR-2)19RS-8
SANGAMON COUNTY
STATION 17+97.34
STRUCTURE NO. 084-0518