

F.A.P. RTE.	SECTION	COUNTY	TOTAL SHEETS	SHEET NO.
328	5R, Y, RS-1	CLAY	242	21
STA.		TO STA.		
FED. ROAD DIST. NO. 7		ILLINOIS	FED. AID PROJECT	
CONTRACT NO. 74078				

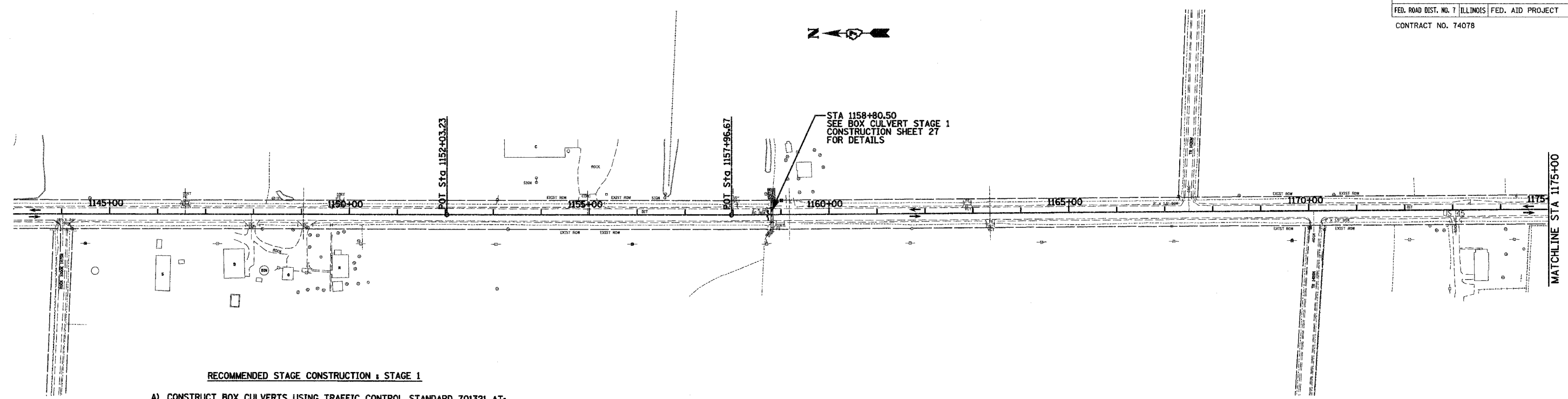

**RECOMMENDED STAGE CONSTRUCTION - STAGE 1**

- A) CONSTRUCT BOX CULVERTS USING TRAFFIC CONTROL STANDARD 701321 AT: STA 1158+80.50, STA 1204+41, STA 1221+20 & STA 1245+00 (SEE STAGE 1 CONSTRUCTION - BOX CULVERTS FOR DETAILS)  
CONSTRUCT DETOUR ROAD #1, INCLUDING TEMPORARY ENTRANCES, ENTRANCE PIPES, AND MAILBOX TURNOUTS.  
CONSTRUCT ANY MAINLINE AND CROSSROAD PIPES AND BOX CULVERTS IN THESE AREAS FIRST.
- B) SHIFT TRAFFIC TO COMBINATION OF DETOUR ROAD AND EXISTING PAVEMENT USING CONTROL STANDARD 701331.
- C) CONSTRUCT NEW PAVEMENT, SHOULDERS, SLOPES, ETC. STA 1246+50 TO STA 1263+00 (ALL PROPOSED MAINLINE CENTERLINE STATIONING)
- D) BEGIN DECK REHABILITATION ON LITTLE WABASH RIVER BRIDGE USING STANDARD 701321. (SEE BRIDGE PLANS FOR DETAILS)  
↔ TWO WAY TRAFFIC IN STAGE 1-B
- E) ANY CHANGES TO STAGING SHALL BE APPROVED BY THE ENGINEER.

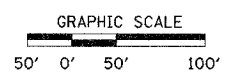
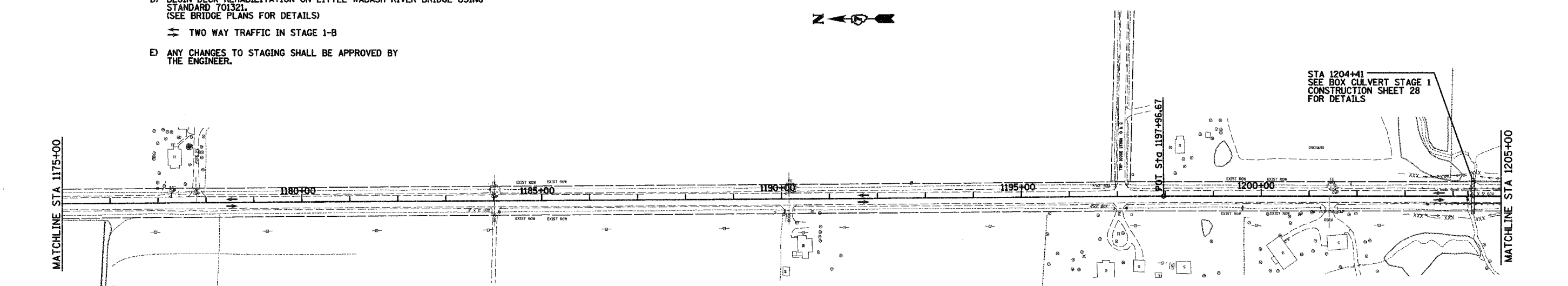

REVISIONS	
NAME	DATE

ILLINOIS DEPARTMENT OF TRANSPORTATION

## STAGE 1 CONSTRUCTION

SCALE: VERT.      DRAWN BY: IJ  
 HORIZ.              CHECKED BY: MAR  
 DATE: 10-21-05