

F.A.P. RTE.	SECTION	COUNTY	TOTAL SHEETS	SHEET NO.
328	5R, Y, RS-1	CLAY	242	37
STA. 1200+00		TO STA. 1215+00		
FED. ROAD DIST. NO. 7		ILLINOIS		FED. AID PROJECT
CONTRACT NO. 74078				

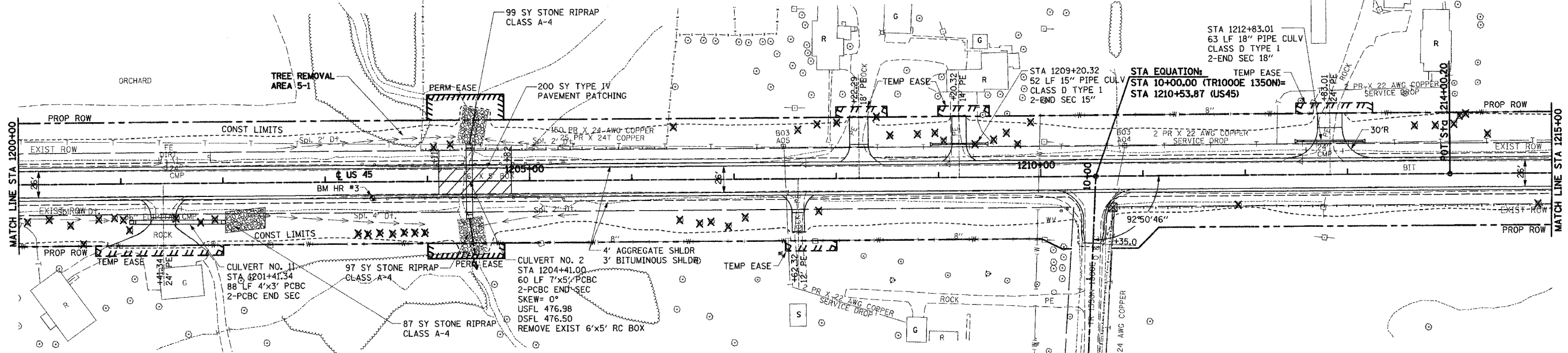

DATE	BY
DATE	BY
DATE	BY

DATE	BY
DATE	BY
DATE	BY



GUARDRAIL REMOVAL
 LT. STA. 1203+36.60 TO LT. 1205+34.00
 RT. STA. 1203+36.60 TO RT. 1205+34.00

CULVERT No. 2 STA 1204+41		DR AREA = 160 AC	
LOW GRADE ELEV = 484.77 @ STA 1204+00			
FLOOD YR	OPENING (SF)	EXIST	PROP
50	198	30	35
100	227	30	35
500	299	30	35
500	299	30	35

BM HR #3 STA 1203+46.00, 16.00' RT.
 TOP OF GUARDRAIL POST
 EL 490.67

LEGEND:
 - PAVEMENT REMOVAL

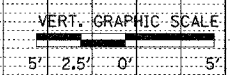
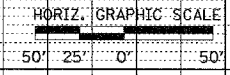
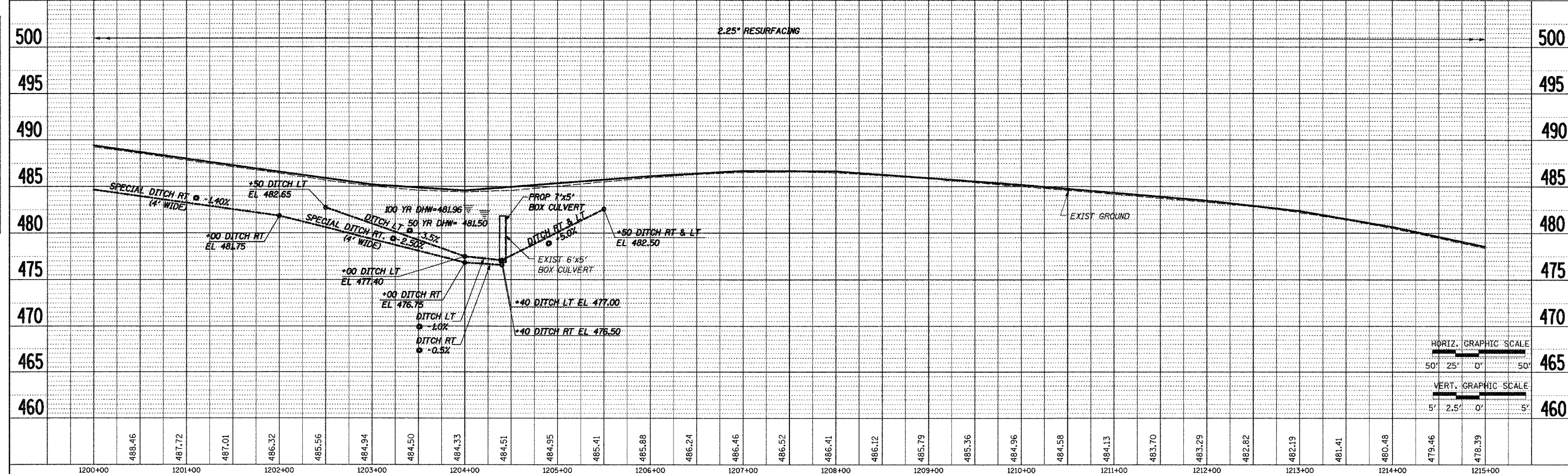
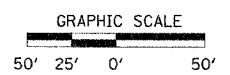

STA 1200+00 TO STA 1215+00

... \ARCH\PROJECTS\74078\74078.DWG 17/05/2006 10:35:43 AM