

F.A.P. RTE.	SECTION	COUNTY	TOTAL SHEETS	SHEET NO.
328	5R, Y, RS-1	CLAY	242	41
STA. 1260+00		TO STA. 1275+00		
FED. ROAD DIST. NO. 7 ILLINOIS FED. AID PROJECT				
CONTRACT NO. 74078				

DETOUR 1  
 PI STA. = 18+27.94  
 $\Delta = 12^\circ 24' 01''$  (RT)  
 $D = 6^\circ 44' 26''$   
 $R = 850.00'$   
 $T = 92.34'$   
 $L = 183.96'$   
 $E = 5.00'$   
 P.C. STA. = 17+35.60  
 P.T. STA. = 19+19.56

WETLAND SITE #7

DETOUR 1  
 PI STA. = 20+56.41  
 $\Delta = 12^\circ 24' 06''$  (LT)  
 $D = 7^\circ 15' 09''$   
 $R = 790.00'$   
 $T = 85.83'$   
 $L = 171.00'$   
 $E = 4.65'$   
 P.C. STA. = 19+70.58  
 P.T. STA. = 21+41.57  
 SE RATE = N/A

STA EQUATION:  
 PT STA 21+41.57 (DETOUR No 1) =  
 STA 1265+33.31 (US 45)



WETLAND SITE #5

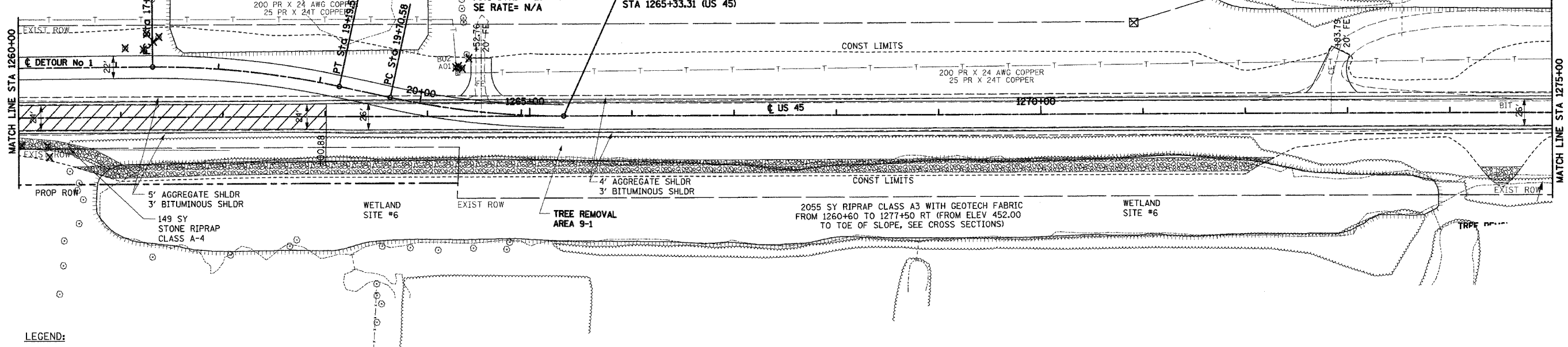

LEGEND:  
 - PAVEMENT REMOVAL

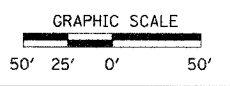

DATE	BY	REVISION

DATE	BY	REVISION

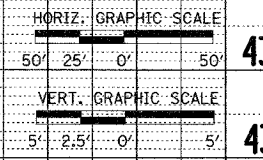
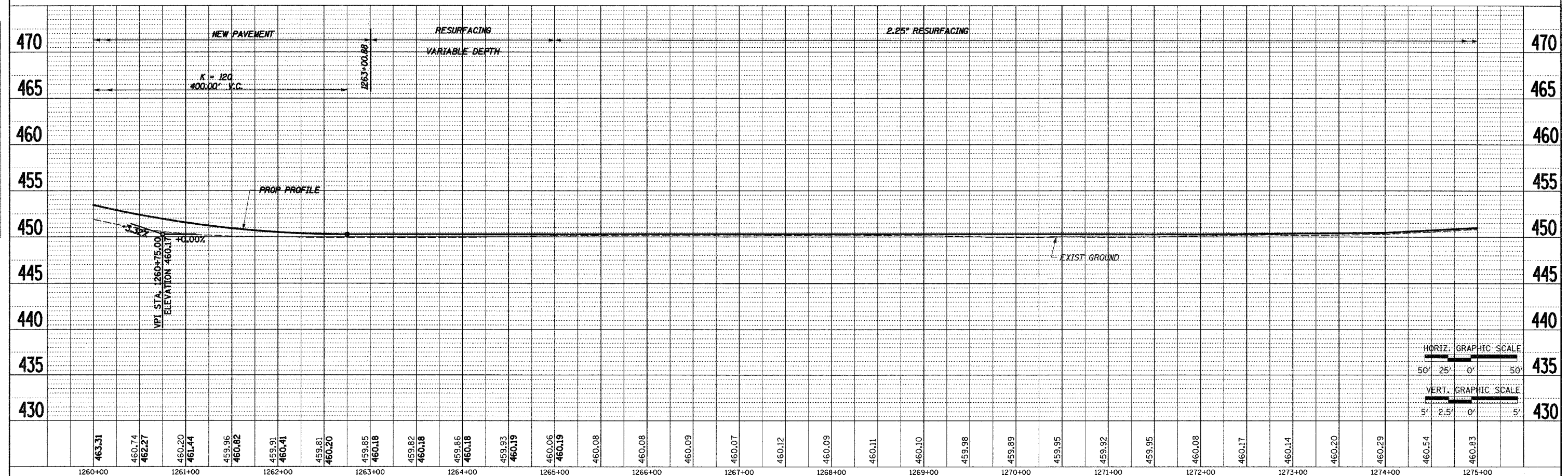

STA 1260+00 TO STA 1275+00

\Users\jfranklin\My Documents\proj\10-25-05\10-25-05.dwg 10/25/05 10:05:56 AM