

F. & A. SYL.	SECTION	COUNTY	TOTAL SHEETS	SHEET NO.
328	5R, Y, RS-1	CLAY	242	60
STA.		TO STA.		
FED. ROAD DIST. NO.	ILLINOIS	FED. AID PROJECT		
CONTRACT NO. 74078				

PLOTTED  
 TEMPLATE  
 AREAS CHECKED  
 NO.

PLOTTED  
 TEMPLATE  
 AREAS CHECKED  
 NO.

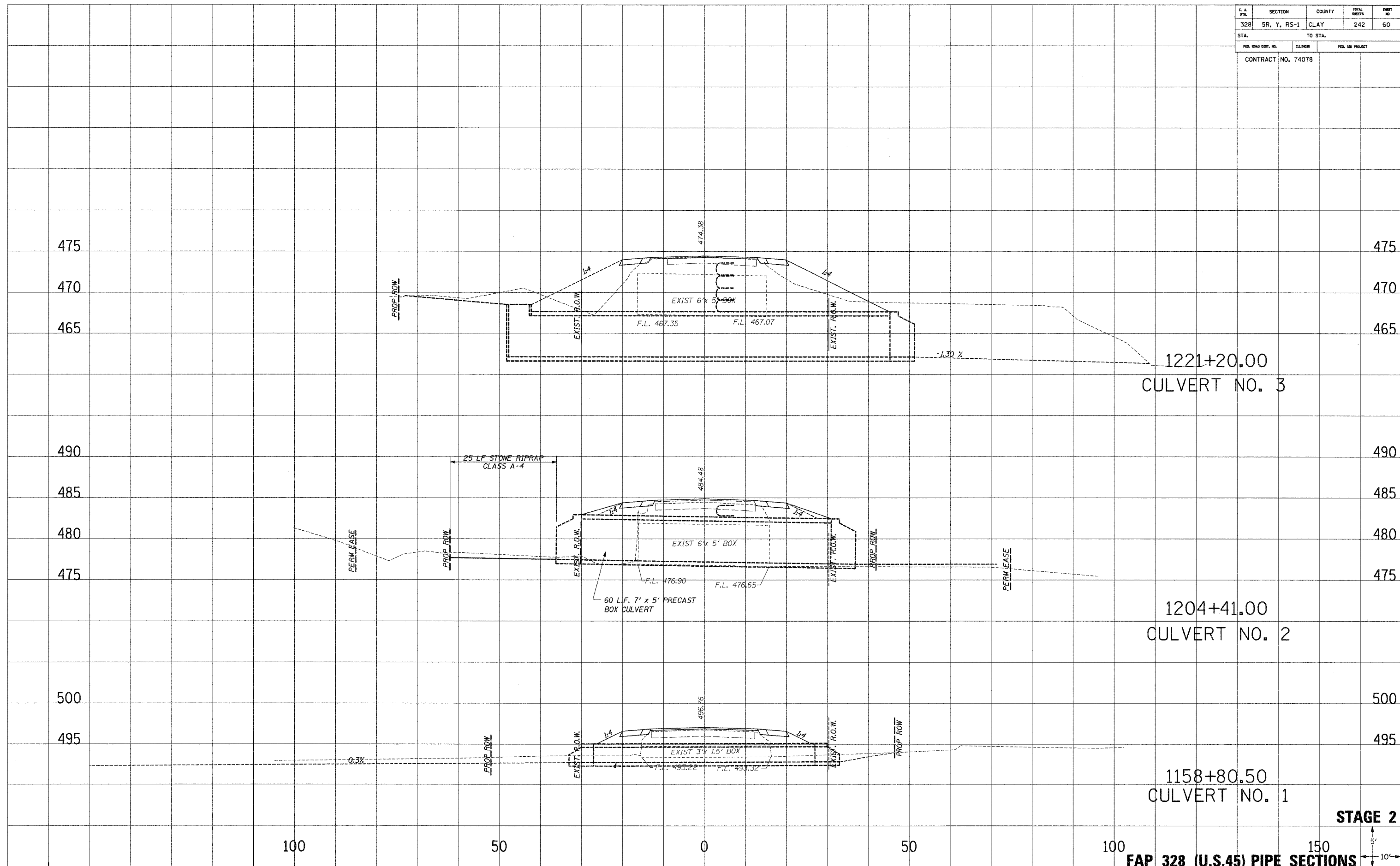

**STAGE 2**  
 100 150  
**FAP 328 (U.S.45) PIPE SECTIONS**  
 5'  
 10'

...\\gpnv\server\j... 10/25/2005 10:57:14 AM