



F. A. RTE.	SECTION	COUNTY	TOTAL SHEETS	SHEET NO.
328	5R, Y, RS-1	CLAY	242	92
STA. TO STA.				
FED. ROAD DIST. NO.		ILLINOIS	FED. AID PROJECT	
CONTRACT NO. 74078				

LEGEND

-  TOPSOIL EXCAVATION
-  PAVEMENT REMOVAL
-  PAVEMENT TO BE BROKEN & LEFT IN PLACE

PLATTED
 FOR DATE
 NOTE BOOK
 AREAS CHECKED
 NO.

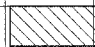
PLATTED
 FOR DATE
 NOTE BOOK
 AREAS CHECKED
 NO.

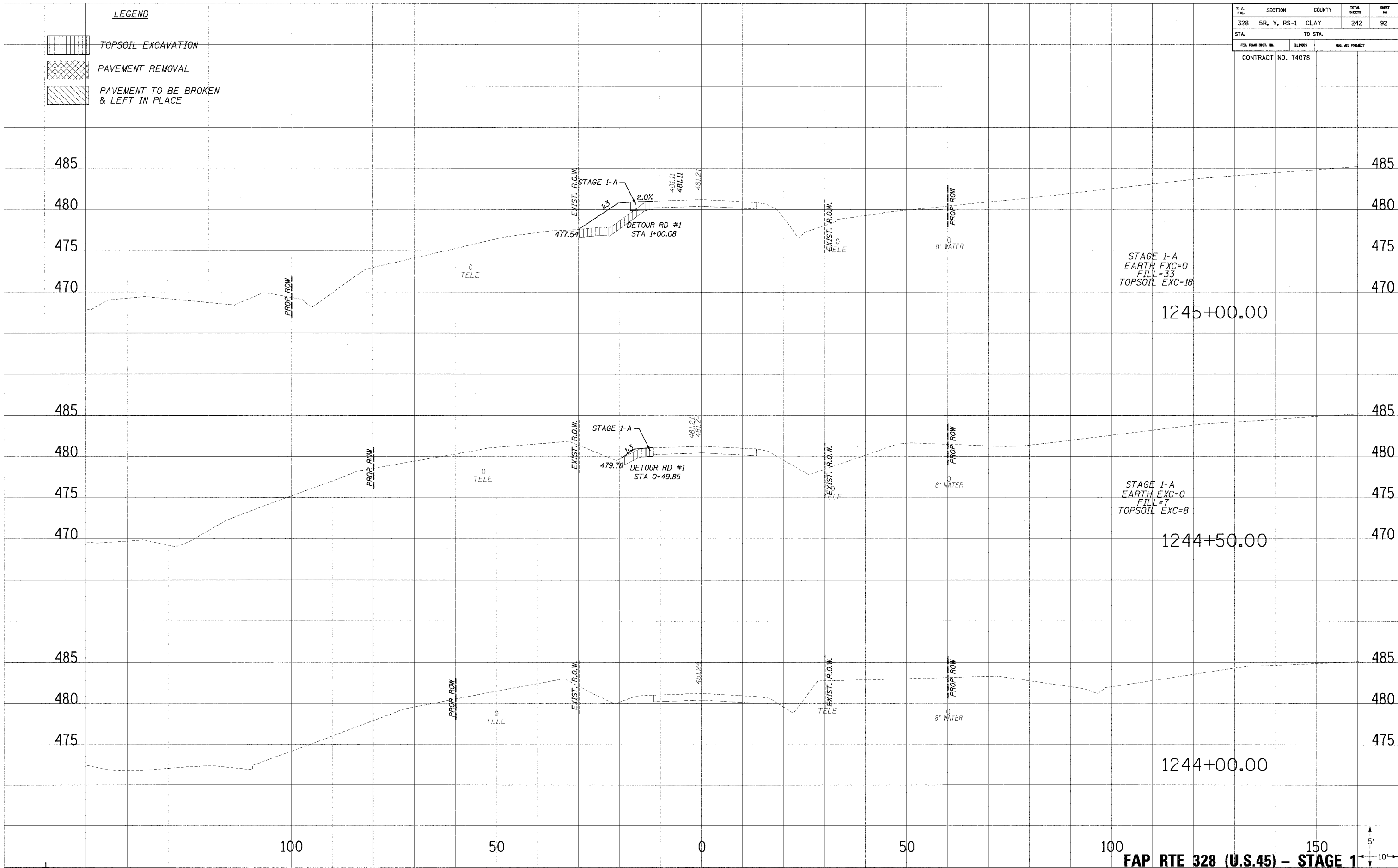

FAP RTE 328 (U.S.45) - STAGE 1

