



F. A. RYE	SECTION	COUNTY	TOTAL SHEETS	SHEET NO
328	5R, Y, RS-1	CLAY	242	93
STA.		TO STA.		
FED. ROAD DIST. NO.	ILLINOIS	FED. AID PROJECT		
CONTRACT NO. 74078				

- LEGEND**
-  TOPSOIL EXCAVATION
 -  PAVEMENT REMOVAL
 -  PAVEMENT TO BE BROKEN & LEFT IN PLACE

DATE: _____
 DRAWN BY: _____
 CHECKED BY: _____
 NO. _____

DATE: _____
 DRAWN BY: _____
 CHECKED BY: _____
 NO. _____

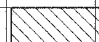
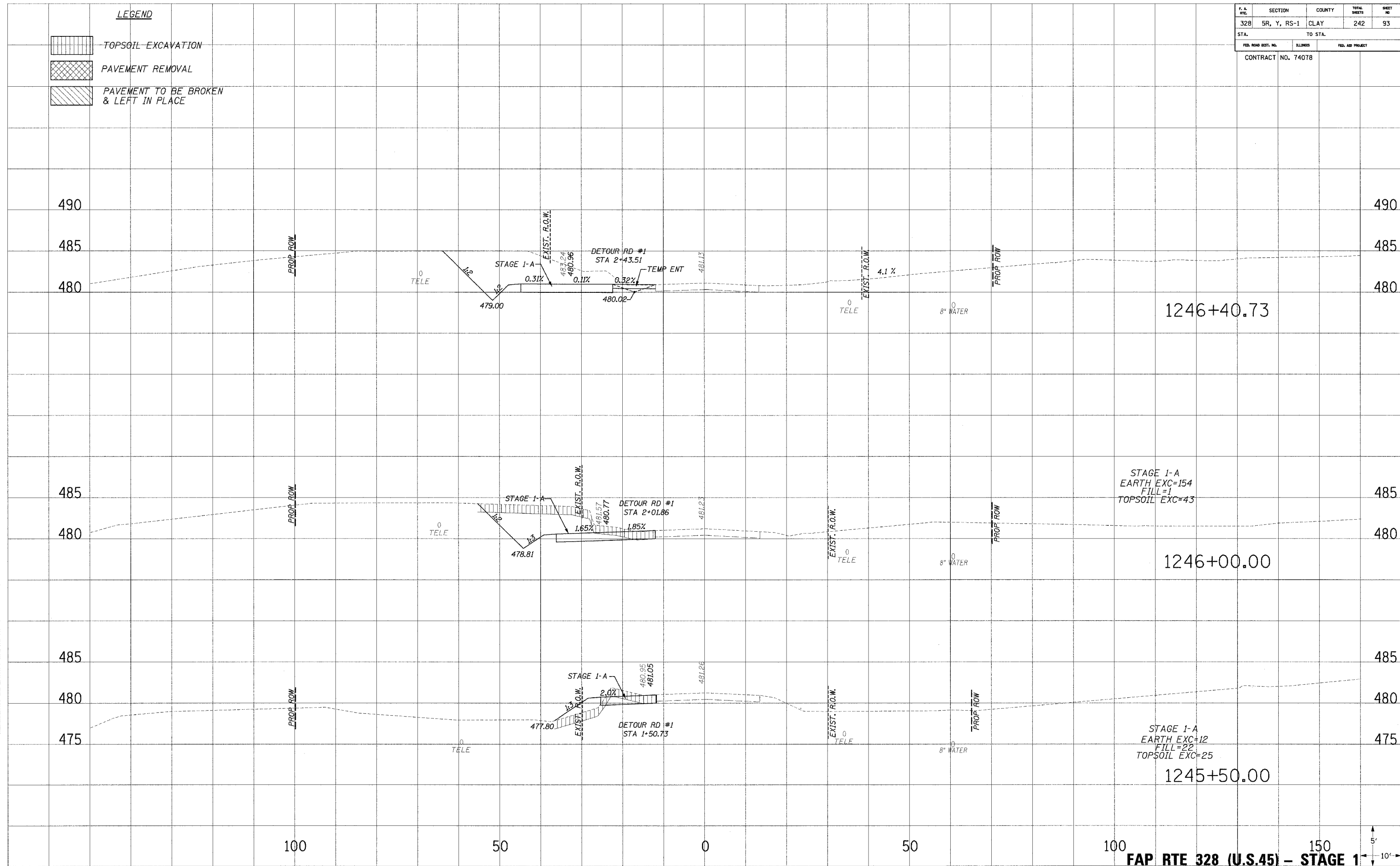

FAP RTE 328 (U.S.45) - STAGE 1

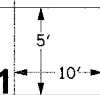

...:\000\work\150.dwg 10/27/2006 6:52:59 AM