

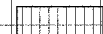

F. A. RTE.	SECTION	COUNTY	TOTAL SHEETS	SHEET NO.
328	5R, Y, RS-1	CLAY	242	95
STA. TO STA.				
FED. ROAD DIST. NO.		ELLIPHS	FED. AID PROJECT	
CONTRACT NO. 74078				

LEGEND

-  TOPSOIL EXCAVATION
-  PAVEMENT REMOVAL
-  PAVEMENT TO BE BROKEN & LEFT IN PLACE

SHEET NO. 95
 DATE 10/24/2009 8:53:09 AM
 DRAWN BY
 CHECKED BY
 REVISIONS
 NO. 1
 DATE
 BY
 REASON

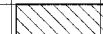
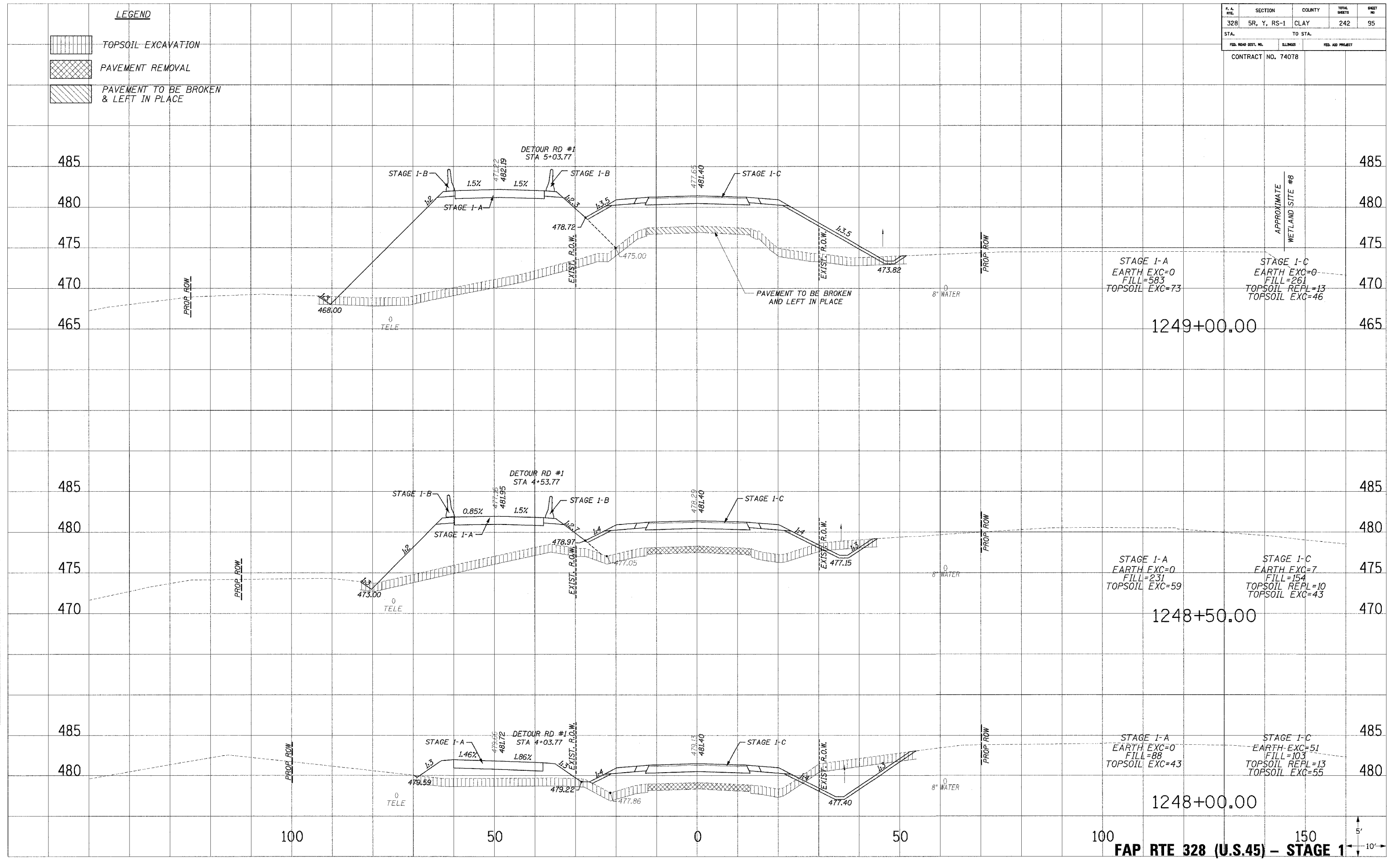

FAP RTE 328 (U.S.45) - STAGE 1

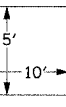

10/24/2009 8:53:09 AM
 10/24/2009 8:53:09 AM