

F.A. RTE.	SECTION	COUNTY	TOTAL SHEETS	SHEET NO.
328	SR, Y, RS-1	CLAY	242	98
STA.		TO STA.		
FED. ROAD DIST. NO.	ILLINOIS	FED. AID PROJECT		
CONTRACT NO. 74078				

**LEGEND**

	TOPSOIL EXCAVATION
	PAVEMENT REMOVAL
	PAVEMENT TO BE BROKEN & LEFT IN PLACE

PLATES  
 NOTE BOOK  
 TEMPLATE  
 AREAS CHECKED  
 NO.

PLATES  
 NOTE BOOK  
 TEMPLATE  
 AREAS CHECKED  
 NO.

PLATES  
 NOTE BOOK  
 TEMPLATE  
 AREAS CHECKED  
 NO.

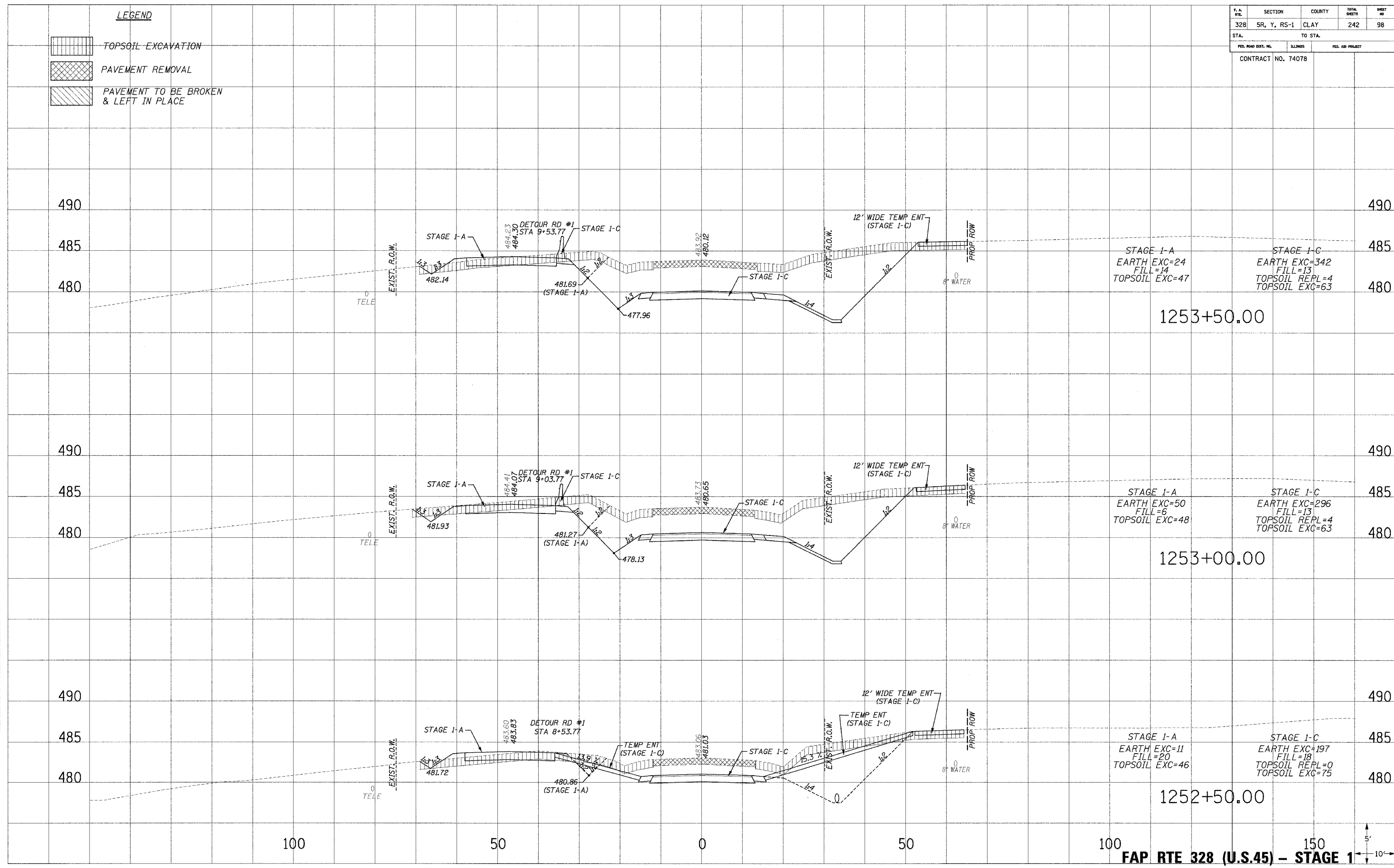

**FAP RTE 328 (U.S.45) - STAGE 1**

10/24/2005 8:55:30 AM