



F. & R.T.	SECTION	COUNTY	TOTAL SHEETS	SHEET NO.
328	SR, Y, RS-1	CLAY	242	170
STA.		TO STA.		
FED. ROAD DIST. NO.	SLIPNOIS	FED. AID PROJECT		

CONTRACT NO. 74078

**LEGEND**

-  TOPSOIL EXCAVATION
-  PAVEMENT REMOVAL
-  PAVEMENT TO BE BROKEN & LEFT IN PLACE

PLANNED  
 NOTE BOOK  
 AREAS CHECKED

PLANNED  
 NOTE BOOK  
 AREAS CHECKED

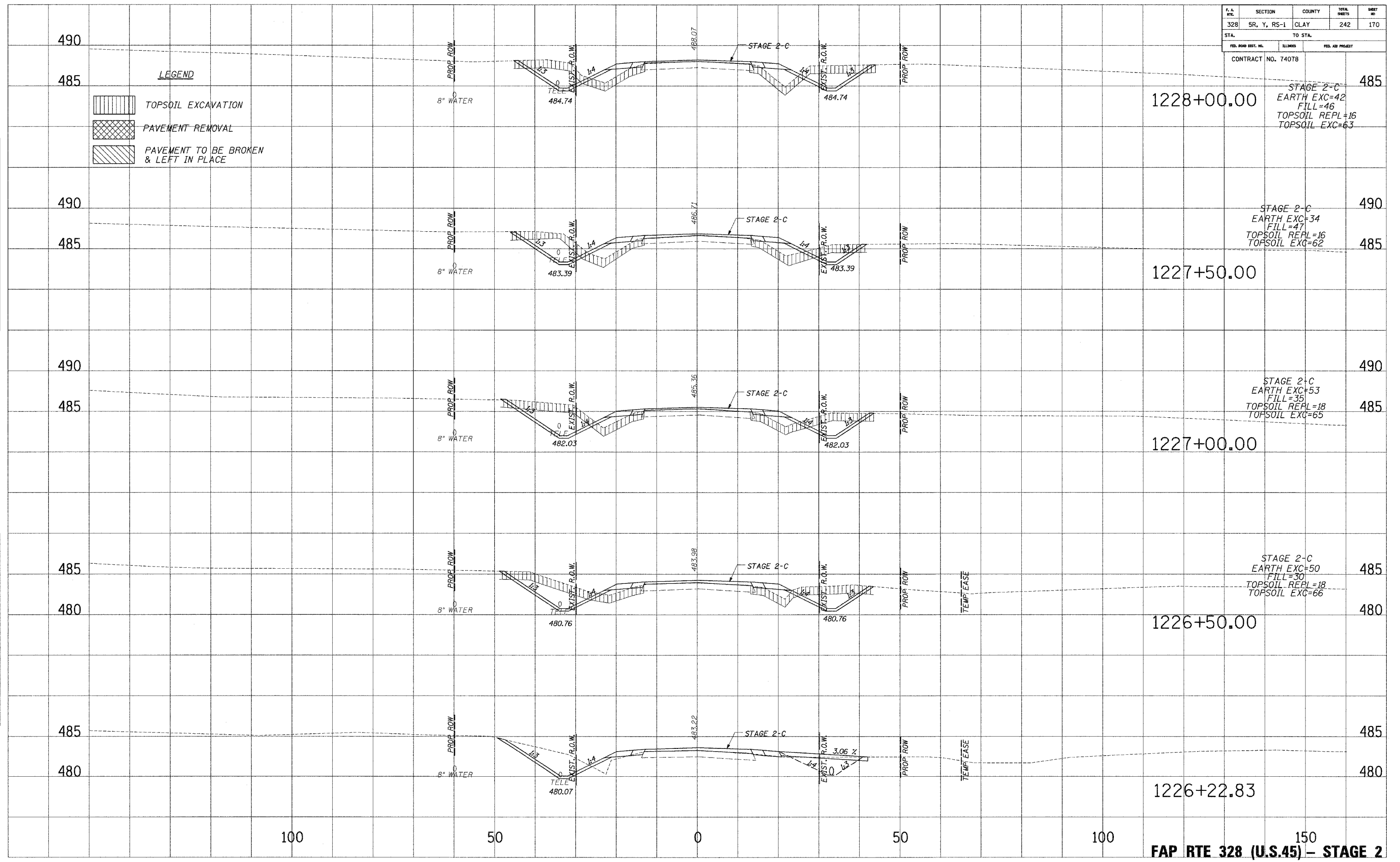

1228+00.00  
 STAGE 2-C  
 EARTH EXC=42  
 FILL=46  
 TOPSOIL REPL=16  
 TOPSOIL EXC=63

1227+50.00  
 STAGE 2-C  
 EARTH EXC=34  
 FILL=47  
 TOPSOIL REPL=16  
 TOPSOIL EXC=62

1227+00.00  
 STAGE 2-C  
 EARTH EXC=53  
 FILL=35  
 TOPSOIL REPL=18  
 TOPSOIL EXC=65

1226+50.00  
 STAGE 2-C  
 EARTH EXC=50  
 FILL=30  
 TOPSOIL REPL=18  
 TOPSOIL EXC=66

1226+22.83

FAP RTE 328 (U.S.45) - STAGE 2

10/24/2009 8:55:25 AM