



F.A. RTE.	SECTION	COUNTY	TOTAL SHEETS	SHEET NO.
328	SR, Y, RS-1	CLAY	242	177
STA.		TO STA.		
FED. ROAD DIST. NO.	ILLINOIS	FED. AID PROJECT		
CONTRACT NO. 74078				

**LEGEND**

-  TOPSOIL EXCAVATION
-  PAVEMENT REMOVAL
-  PAVEMENT TO BE BROKEN & LEFT IN PLACE

PLOTTED  
 TEMPLATE  
 AREAS CHECKED  
 NO.

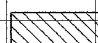
PLOTTED  
 TEMPLATE  
 AREAS CHECKED  
 NO.

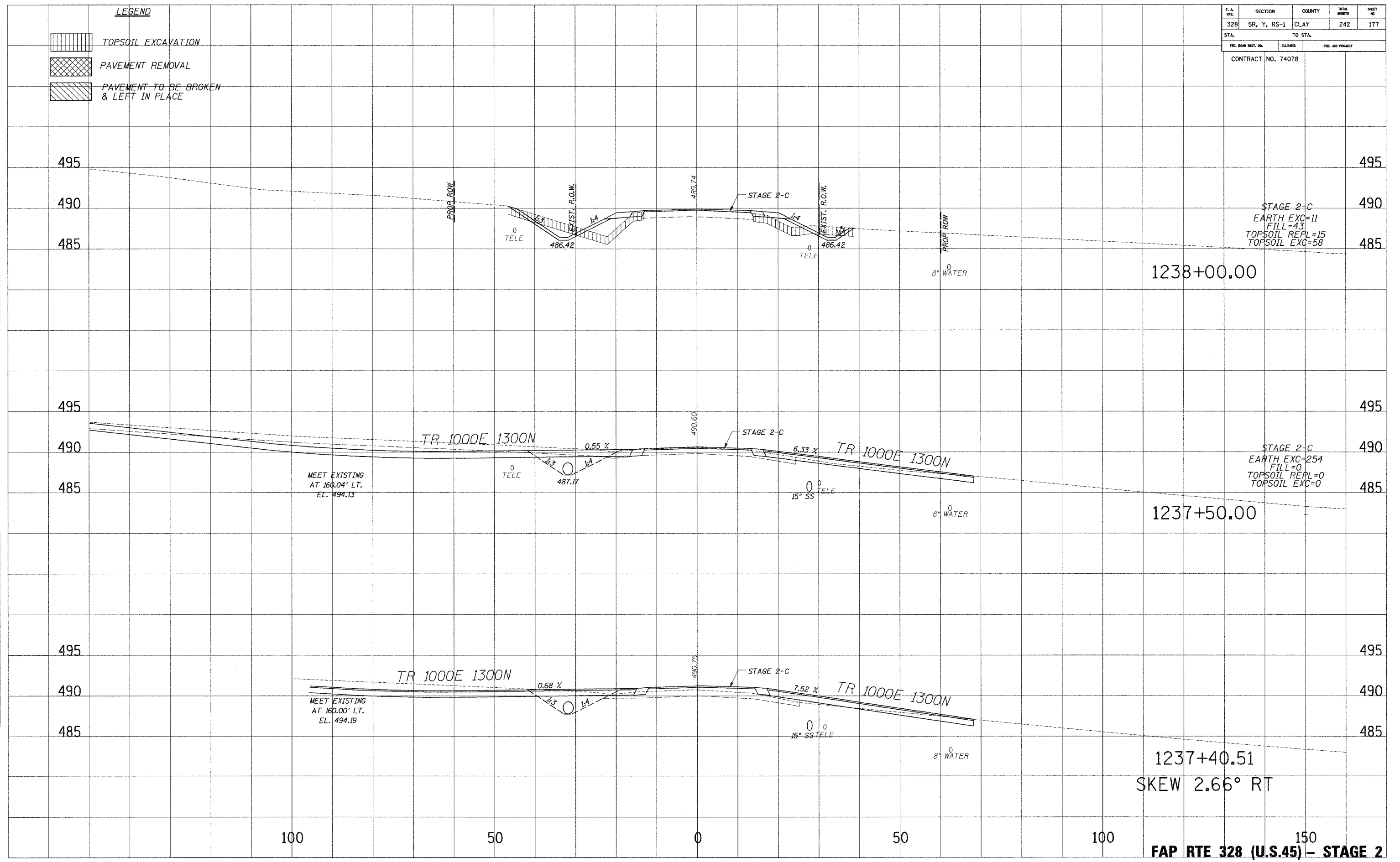

STAGE 2-C  
 EARTH EXC=11  
 FILL=43  
 TOPSOIL REPL=15  
 TOPSOIL EXC=58

STAGE 2-C  
 EARTH EXC=254  
 FILL=0  
 TOPSOIL REPL=0  
 TOPSOIL EXC=0

1237+40.51  
 SKEW 2.66° RT

FAP RTE 328 (U.S.45) - STAGE 2

...:\DRAWINGS\328\328-177.DWG 10/24/2006 8:58:26 AM