

F.A. RTE.	SECTION	COUNTY	TOTAL SHEETS	SHEET NO.
328	5R, Y, R5-1	CLAY	242	180
STA.		TO STA.		
FED. ROAD DIST. NO.	ILLINOIS	FED. AID PROJECT		

CONTRACT NO. 74078

STAGE 2-C
EARTH EXC=34
FILL=22
TOPSOIL REPL=16
TOPSOIL EXC=61

PLANNED
NOTE BOOK
NO.

PLANNED
NOTE BOOK
NO.

PLANNED
NOTE BOOK
NO.

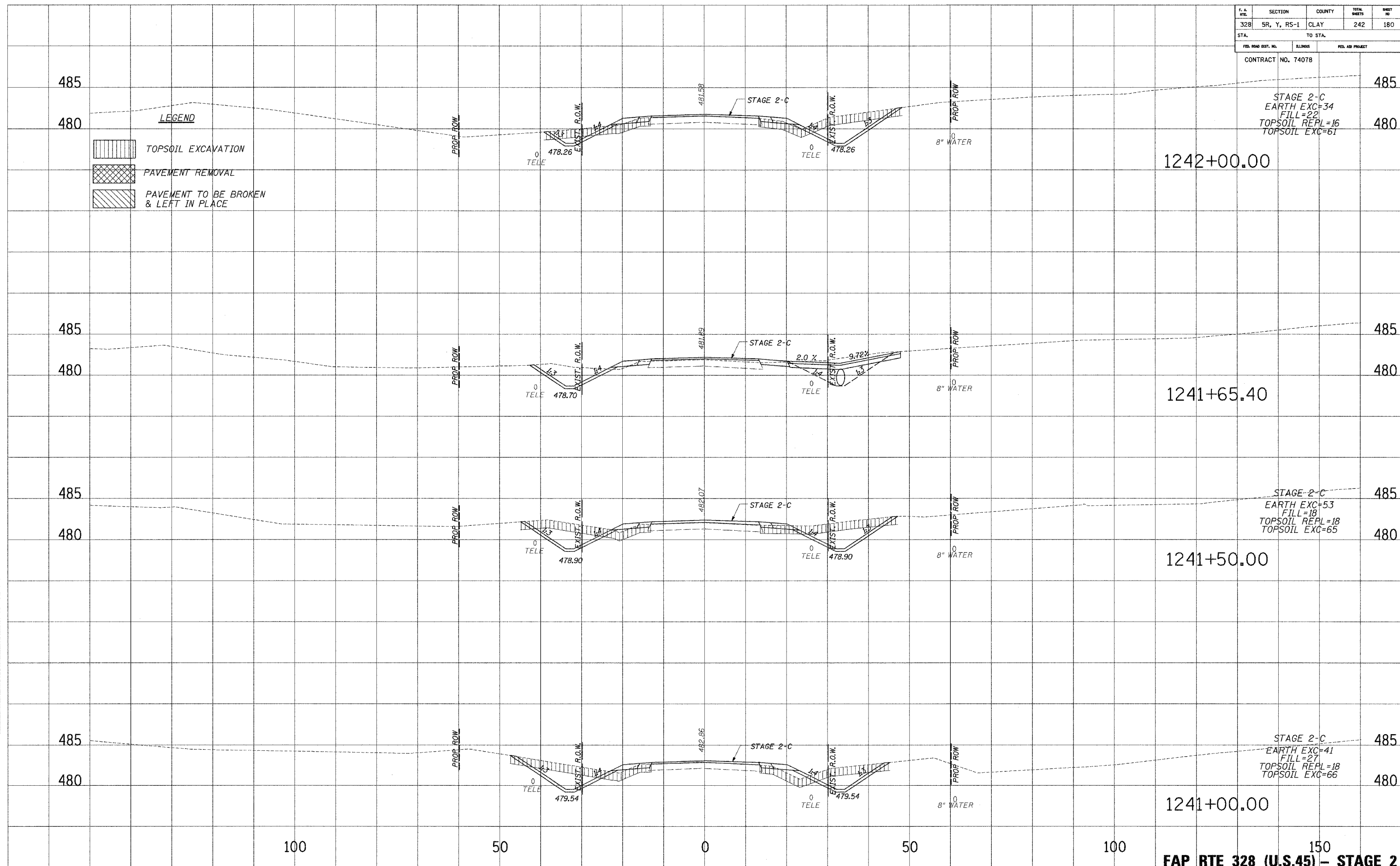

1242+00.00

1241+65.40

1241+50.00

1241+00.00

FAP RTE 328 (U.S.45) - STAGE 2

DATE: 10/24/2012 8:05:25 AM