

F.A. RTE.	SECTION	COUNTY	TOTAL SHEETS	SHEET NO.
328	5R, Y, RS-1	CLAY	242	183
STA.		TO STA.		
FED. ROAD DIST. NO.	SUBDIVISION	FED. AID PROJECT		
CONTRACT NO. 74078				

LEGEND

	TOPSOIL EXCAVATION
	PAVEMENT REMOVAL
	PAVEMENT TO BE BROKEN & LEFT IN PLACE

PLATTER
NOTE BOOK
TEMPLATE
AREAS CHECKED
NO.

PLATTER
NOTE BOOK
TEMPLATE
AREAS CHECKED
NO.

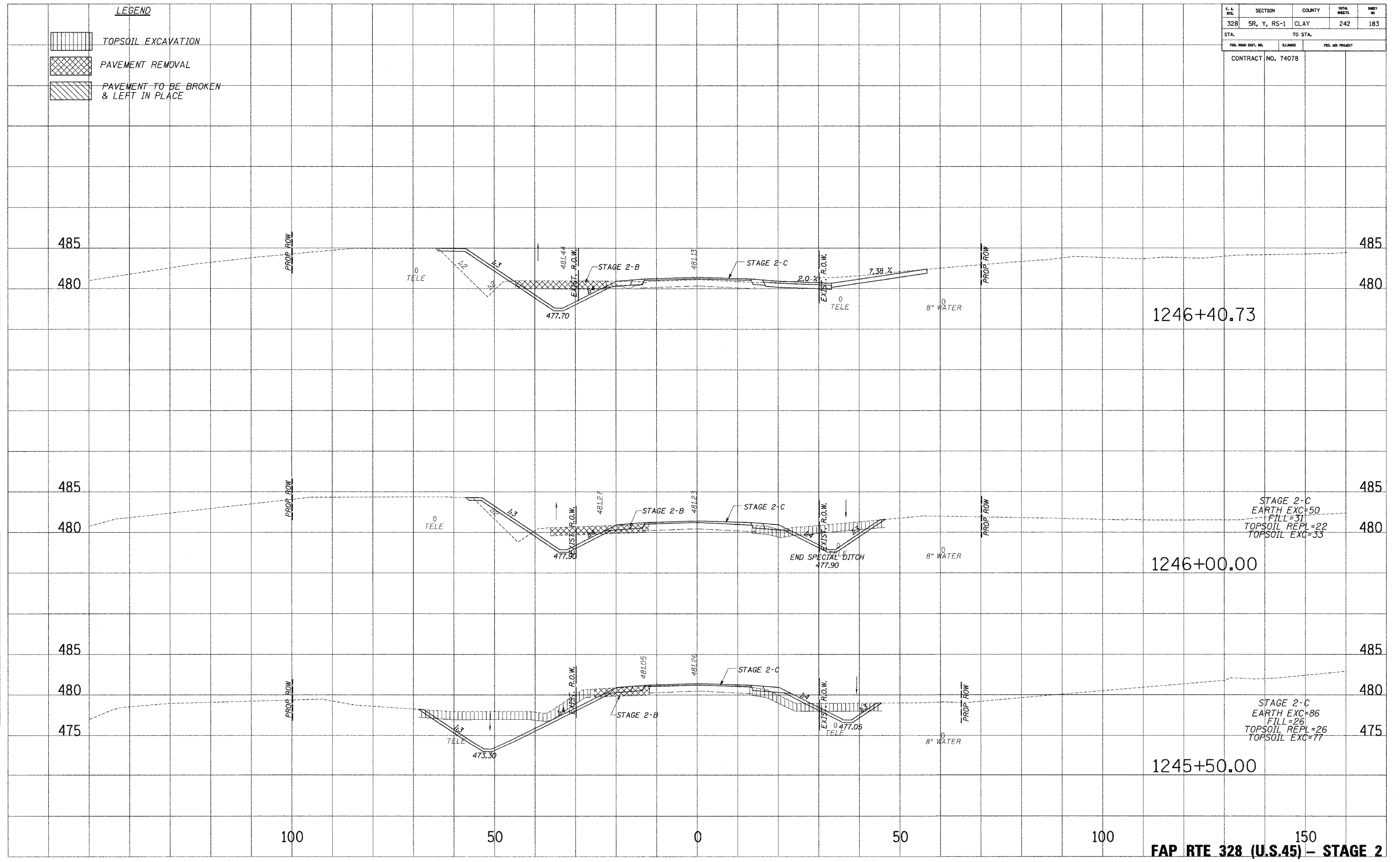

FAP RTE 328 (U.S.45) - STAGE 2

DATE PLOTTED: 10/24/2006 10:59:27 AM