

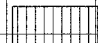

F.A. R/L	SECTION	COUNTY	TOTAL SHEETS	SHEET NO.
328	5R, Y, RS-1	CLAY	242	185
STA.		TO STA.		
FED. ROAD DIST. NO.	SLAB NO.	FED. AID PROJECT		
CONTRACT NO. 74078				

- LEGEND**
-  TOPSOIL EXCAVATION
 -  PAVEMENT REMOVAL
 -  PAVEMENT TO BE BROKEN & LEFT IN PLACE

PLOTTED
 NOTE BOOK
 TEMPLATE
 AREAS CHECKED
 NO.

PLOTTED
 NOTE BOOK
 TEMPLATE
 AREAS CHECKED
 NO.

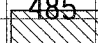
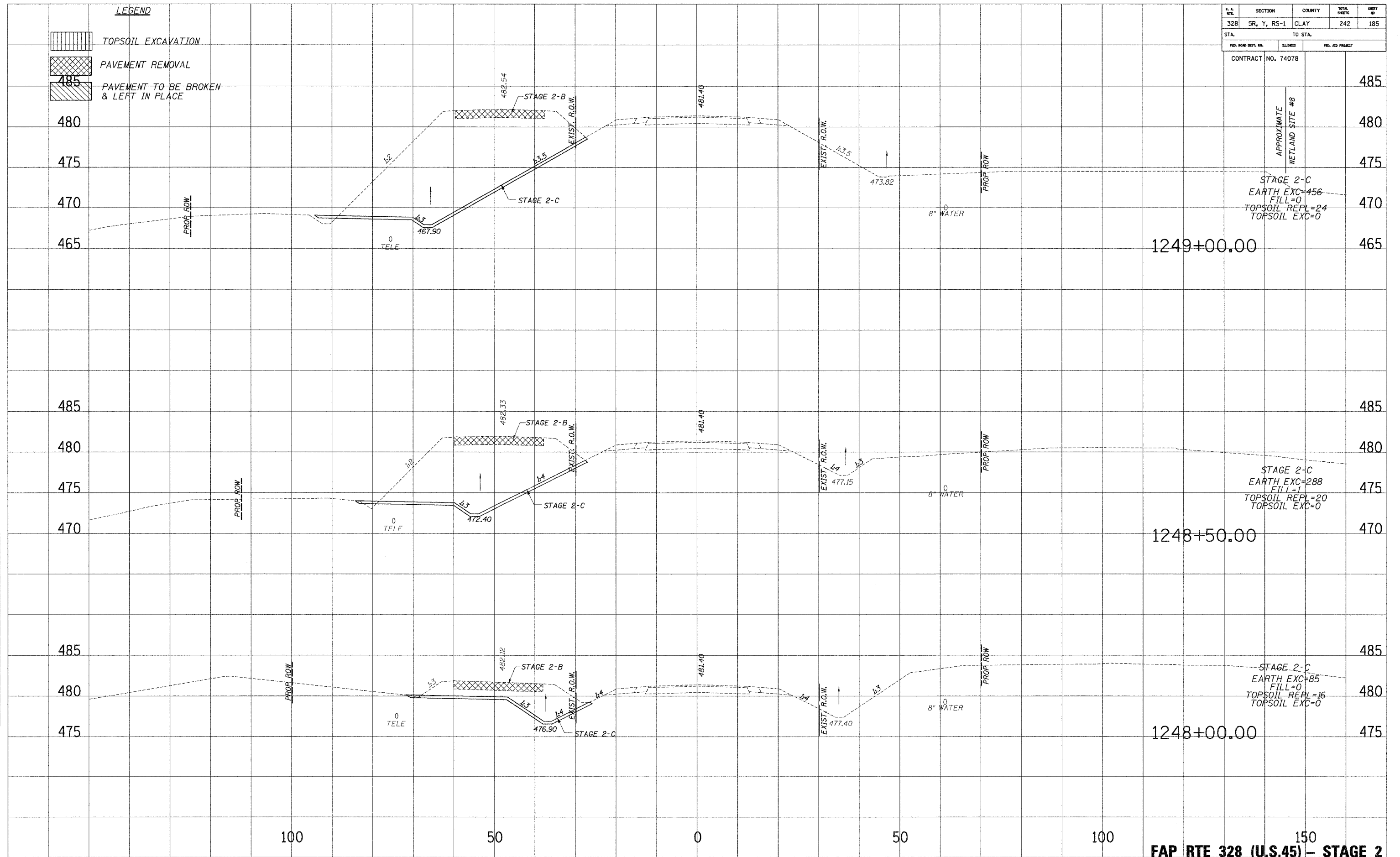

FAP RTE 328 (U.S.45) - STAGE 2

10/24/2006 8:59:27 AM