



F.A. AVE.	SECTION	COUNTY	TOTAL SHEETS	SHEET NO.
328	5R, Y, RS-1	CLAY	242	188
STA.		TO STA.		
FED. ROAD DIST. NO.	ILLINOIS	FED. AID PROJECT		
CONTRACT NO. 74078				

**LEGEND**

 TOPSOIL EXCAVATION  
 PAVEMENT REMOVAL  
 PAVEMENT TO BE BROKEN & LEFT IN PLACE

PLATED  
 NOTE BOOK  
 TEMPLATE  
 AREAS CHECKED  
 NO.

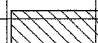
PLATED  
 NOTE BOOK  
 TEMPLATE  
 AREAS CHECKED  
 NO.

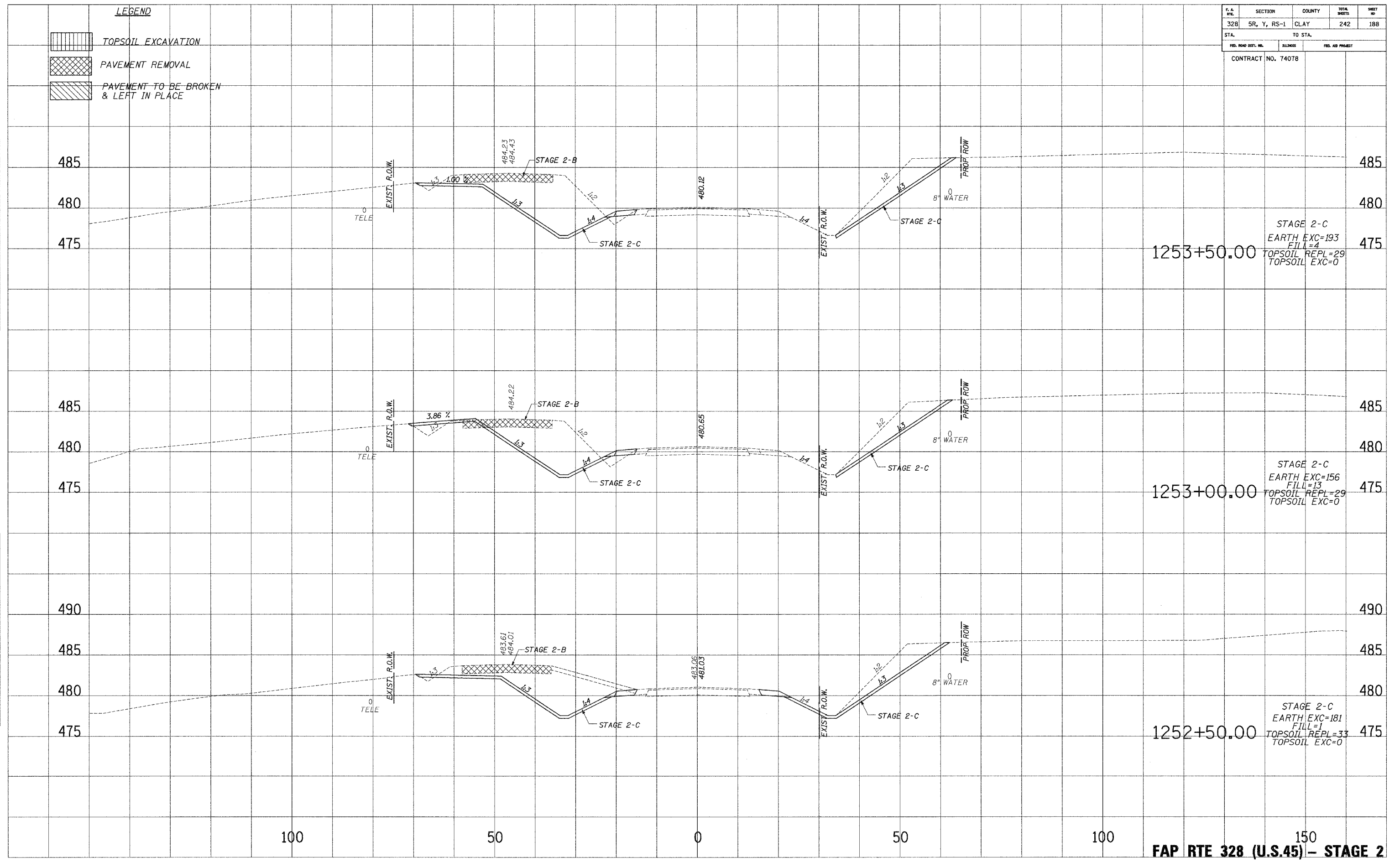

150  
**FAP RTE 328 (U.S.45) - STAGE 2**

10/24/2006 9:56:27 AM