

F.A.P. RTE.	SECTION	COUNTY	TOTAL SHEETS	SHEET NO.
3762	01-00139-02-BR	WILL	35	06
STA.	TO STA.			
FED. ROAD DIST. NO. 1	ILLINOIS	HIGHWAY PROJECT		
CONTRACT # 83802				

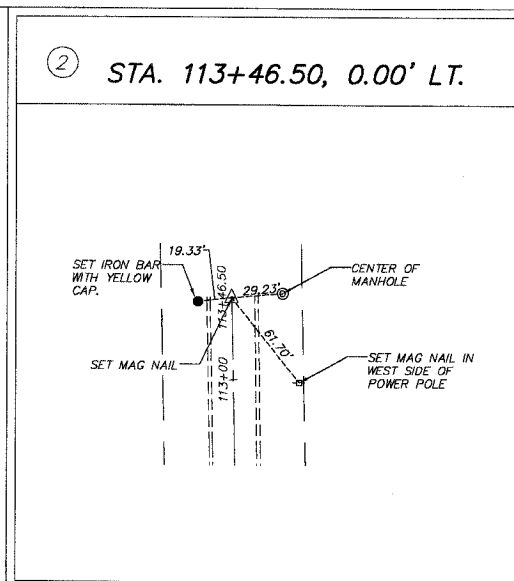
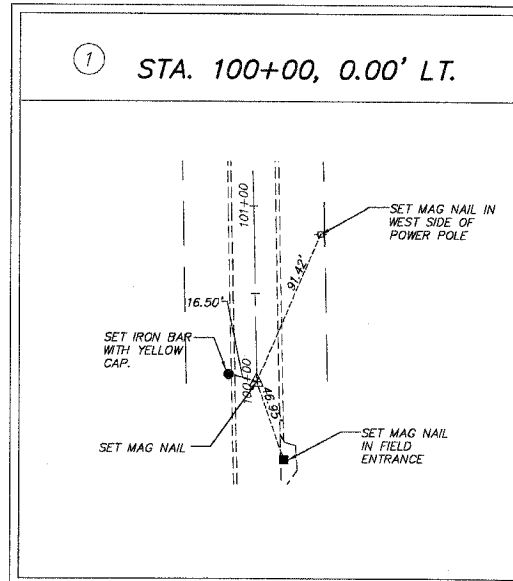

NO.	PROPOSED STATION	OFFSET	NORTHING	EASTING
1	100+00	0.00' LT	1695070.187	1134844.758
2	113+46.50	0.00' LT	1696409.903	1134812.903

● THESE STAKES REFERENCE SET MONUMENTATION. SET 1/2 INCH IRON BAR FLUSH WITH GROUND TO SET MAG NAIL.

■ THESE STAKES REFERENCE SET MONUMENTATION. SET MAG NAIL WITH WASHER SET TO TIE SET MAG NAIL.

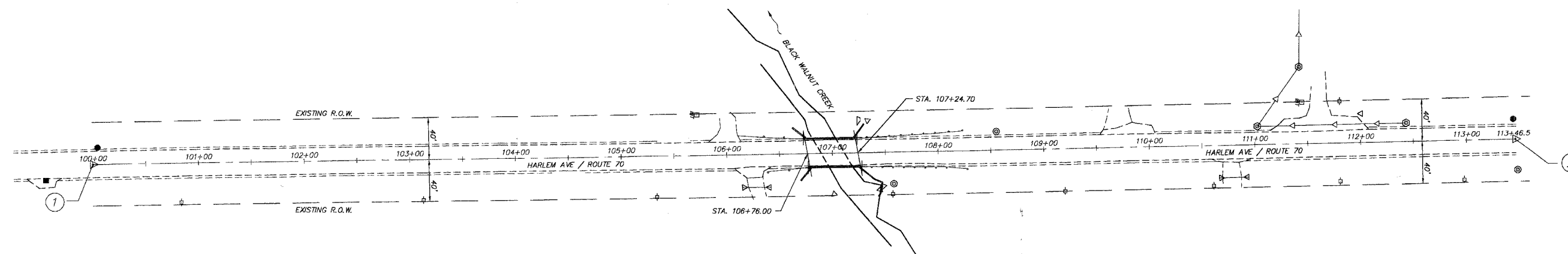

HARLEM AVENUE



SMITH ENGINEERING CONSULTANTS, INC.
 CIVIL/STRUCTURAL ENGINEERS AND SURVEYORS
 4500 PRIME PARKWAY, SUITE 201
 McHENRY, ILLINOIS 60050
 PH: 815-385-1778 FAX: 815-385-1781
 www.smithengineering.com E-MAIL: see@smitheng.com
 McHENRY HUNTLEY YORKVILLE
 ILLINOIS PROFESSIONAL DESIGN FIRM # 184-000108

ILLINOIS DEPARTMENT OF TRANSPORTATION

WILL COUNTY DEPARTMENT OF HIGHWAYS
 HARLEM AVENUE/DRECKSLER ROAD
 OVER BLACK WALNUT CREEK
 ALIGNMENT AND TIES

REVISIONS	
NO.	DATE
7.	
6.	
5.	
4.	
3.	
2.	
1.	

SCALE: "NTS" DRAWN BY WJH
 DATE 5-26-2005 CHECKED BY RGD

PLOT FILE BY STANDARD
 USER: CJE
 COMP. FILE: 04015901.dwg