

F.A.P. RTE.	SECTION	COUNTY	TOTAL SHEETS	SHEET NO.
3762	01-00139-02-BR	WILL	35	12
STA.	110+00	TO STA.	113+46.50	
FED. ROAD DIST. NO. 1	ILLINOIS	HIGHWAY PROJECT		
CONTRACT # 83802				

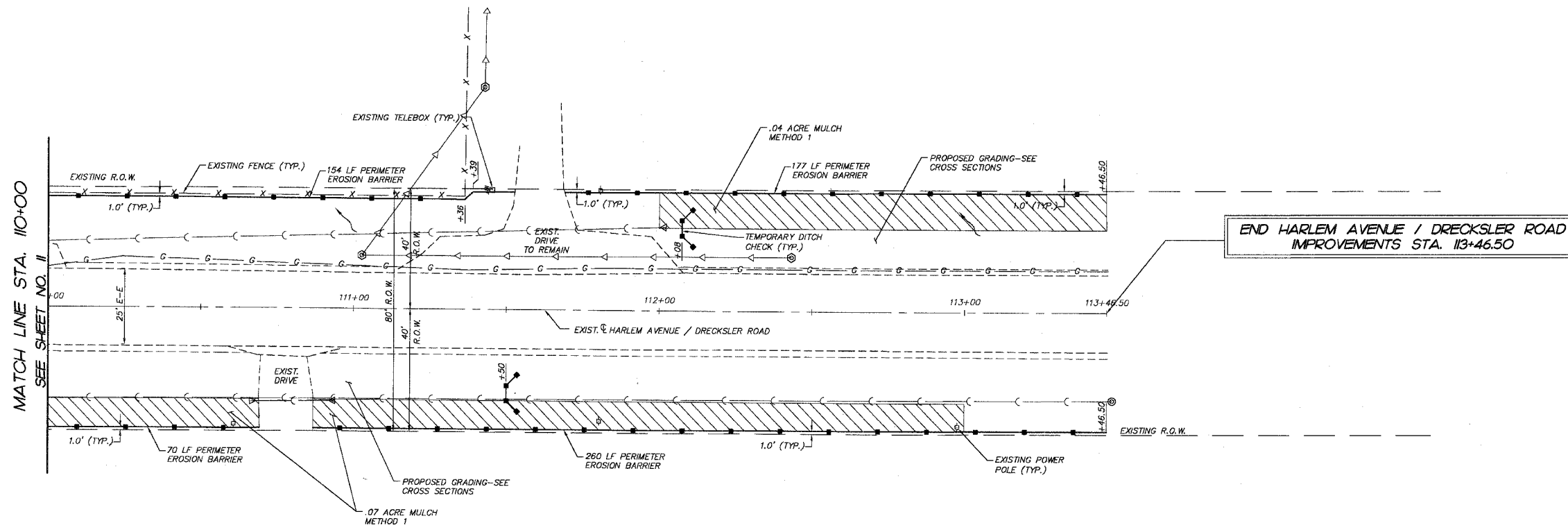

END HARLEM AVENUE / DRECKSLER ROAD  
IMPROVEMENTS STA. 113+46.50

**LEGEND:**

	DENOTES EROSION CONTROL BLANKET
	DENOTES MULCH METHOD 1
	DENOTES PERIMETER EROSION BARRIER
	DENOTES TEMPORARY DITCH CHECK
	DENOTES FLOW DIRECTION

PLOT FILE: STANDARD  
V.E.P. CE-12  
COMP. FILE: 040158-028.dwg

REVISIONS	
NO.	DATE
7.	
6.	
5.	
4.	
3.	
2.	
1.	

**SMITH ENGINEERING CONSULTANTS, INC.**  
CIVIL/STRUCTURAL ENGINEERS AND SURVEYORS  
4500 PRIME PARKWAY, SUITE 201  
MOLLENTY, ILLINOIS 60050  
PH: 615-385-1778 FAX: 615-385-1781  
www.smithengineering.com E-MAIL: seo@smithengineering.com  
• MCHENRY • HUNTLEY • YORKVILLE  
ILLINOIS PROFESSIONAL DESIGN FIRM # 184-000108

ILLINOIS DEPARTMENT OF TRANSPORTATION  
  
WILL COUNTY DEPARTMENT OF HIGHWAYS  
HARLEM AVENUE/DRECKSLER ROAD  
OVER BLACK WALNUT CREEK  
EROSION CONTROL PLAN  
  
SCALE: 1"=20'  
DATE 5-26-2005  
  
DRAWN BY WJH  
CHECKED BY JLP