

FOR INDEX OF SHEETS, SEE SHEET NO.2

FEDERAL AID DESIGN ENGINEER: ABIGAIL BRINKS 847-705-4233  
CONSULTING ENGINEER: ENGINEERING ENTERPRISES, INC.  
CONTACT: TIMOTHY V. WEIDNER

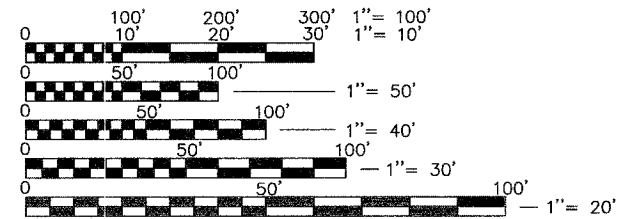

FULL SIZE PLANS HAVE BEEN PREPARED USING STANDARD ENGINEERING SCALES, REDUCED SIZED PLANS WILL NOT CONFORM TO STANDARD SCALES, IN MAKING MEASUREMENTS ON REDUCED PLANS, THE ABOVE SCALES MAY BE USED.

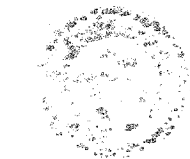

J.U.L.I.E.  
JOINT UTILITY LOCATION INFORMATION FOR EXCAVATION  
1-800-892-0123

CONTRACT NO. 83826

**STATE OF ILLINOIS**  
**DEPARTMENT OF TRANSPORTATION**  
**DIVISION OF HIGHWAYS**  
**PLANS FOR PROPOSED**  
**FEDERAL AID PROJECT**  
**RESURFACING**  
**MAIN STREET - FAU ROUTE 2533**  
**PROJECT NO. M-8003(486)**  
**SECTION NO. 05-00036-00-RS**  
**FROM WEBSTER STREET (FAU 1550)**  
**TO ASHLAND AVENUE (FAU 1650)**  
**VILLAGE OF MONTGOMERY**  
**KANE COUNTY**  
**JOB NO. C-91-138-05**

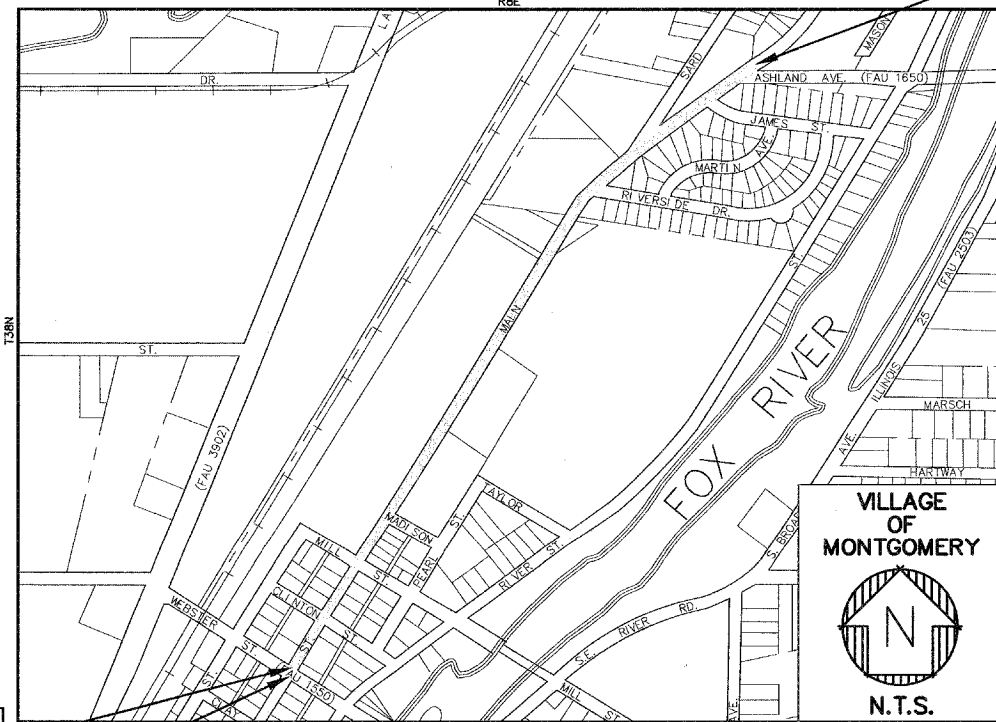

**LOCATION MAP**

GROSS LENGTH OF PROJECT = 4,120 FEET (0.78 MILES)  
NET LENGTH OF IMPROVEMENTS = 4,086 FEET (0.77 MILES)

CONSTRUCTION BEGINS AT STA. 10+54 MAIN ST.

PROJECT BEGINS AT STA. 10+20 MAIN ST.

PROJECT AND CONSTRUCTION ENDS STA. 51+40 MAIN ST.

**DESIGN DESIGNATION**  
MAIN STREET: MINOR ARTERIAL  
DESIGN SPEED = 30 M.P.H.  
POSTED SPEED = 30 M.P.H.  
ADT(2003) = 2800

DATE: 11/02/2005  
BY: Ronald G. Naylor  
RONALD G. NAYLOR  
LICENSE EXPIRES: 11/30/2005

**Engineering Enterprises, Inc.**  
Consulting Engineers  
52 Wheeler Road  
Sugar Grove, Illinois 60554  
630/466-9350

F.A.U. RTE.	SECTION	COUNTY	TOTAL SHEETS	SHEET NO.
2533	05-00036-00-RS	KANE	15	1
FED. ROAD DIST. NO.	ILLINOIS	FED. AID PROJECT - LAPP		
CONTRACT NO. 83826				

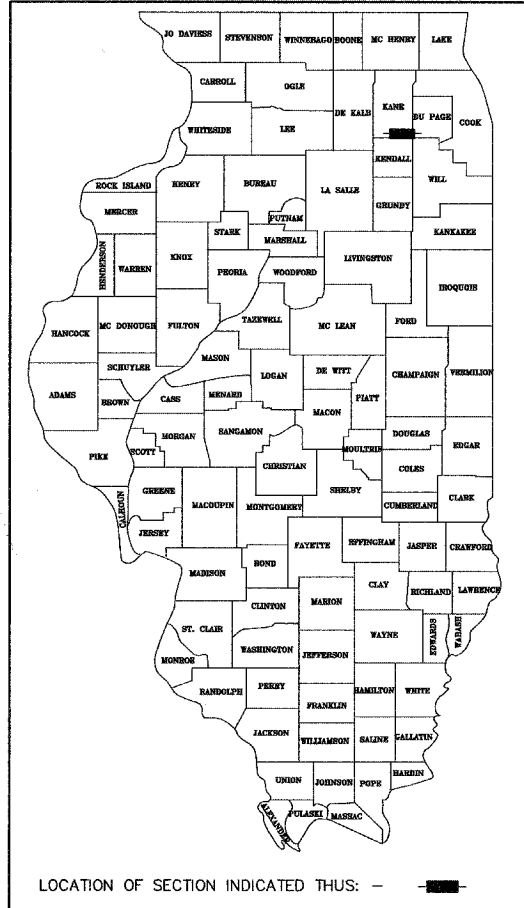

STATE OF ILLINOIS  
DEPARTMENT OF TRANSPORTATION

APPROVED: Nov. 3 20.05  
*Michael S. Burt*  
LOCAL AGENCY OFFICIAL

APPROVED: November 8 20.05  
*C. [Signature]*  
ENGINEER OF LOCAL ROADS & STREETS

APPROVED: Nov. 18 20.05  
*Deane M. O'Keefe, Col*  
DEPUTY DIRECTOR OF HIGHWAYS, REGION ENGINEER

TOPOGRAPHICAL INFORMATION FROM SURVEY BY ENGINEERING ENTERPRISES, INC.

COPYRIGHT © 2005 ENGINEERING ENTERPRISES, INC.

PATH: H:\V5556PRJ\A\000001\A\05\000001\000001.DWG