

MAILBOXES SHALL BE TEMPORARILY RELOCATED AS DIRECTED BY THE ENGINEER IN ACCORDANCE WITH THE SPECIAL PROVISIONS.

SEE PLAN AND PROFILE SHEETS FOR STORM SEWER REMOVAL AND STRUCTURE REMOVAL AND ADJUSTMENT SCHEDULES.

ALL VARIOUS SIGNS WHICH INTERFERE WITH CONSTRUCTION OPERATIONS SHALL BE REMOVED AND RELOCATED AS DIRECTED BY THE ENGINEER. SEE SPECIAL PROVISIONS.

LEGEND

- (A) STRUCTURE TO BE ADJUSTED
- (R) STRUCTURE TO BE REMOVED
- (F) STRUCTURE TO BE FILLED
- (TM) TELEPHONE MANHOLE TO BE ADJUSTED BY OTHERS
- U.P.TBRBO UTILITY POLE - TO BE RELOCATED BY OTHERS
- U.P.DND UTILITY POLE - DO NOT DISTURB
- 15' TREE REMOVAL
- DRIVEWAY PAVEMENT REMOVAL
- PAVEMENT REMOVAL
- SIDEWALK REMOVAL
- CULVERT TO BE REMOVED

STATION	OFFSET	UNIT
119+13.5	31.1' RT.	8
119+45.3	29.9' RT.	12
124+64.7	49.3' RT.	6

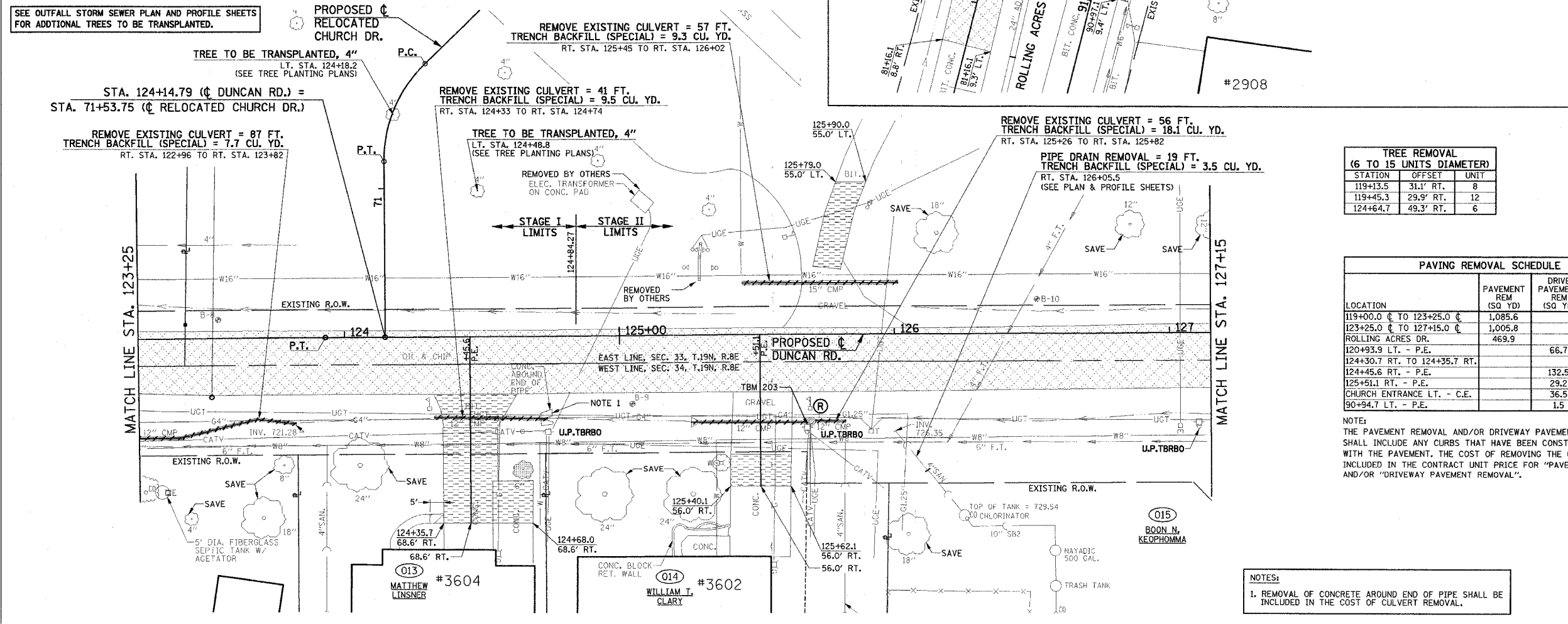

STATION	OFFSET	UNIT
119+13.5	31.1' RT.	8
119+45.3	29.9' RT.	12
124+64.7	49.3' RT.	6

LOCATION	PAVEMENT REM (SQ YD)	DRIVE PAVEMENT REM (SQ YD)	SIDEWALK REM (SQ FT)
119+00.0 C TO 123+25.0 C	1,085.6		
123+25.0 C TO 127+15.0 C	1,005.8		
ROLLING ACRES DR.	469.9		
120+93.9 LT. - P.E.		66.7	
124+30.7 RT. TO 124+35.7 RT.			16.8
124+45.6 RT. - P.E.		132.5	
125+51.1 RT. - P.E.		29.2	
CHURCH ENTRANCE LT. - C.E.		36.5	
90+94.7 LT. - P.E.		1.5	

NOTE: THE PAVEMENT REMOVAL AND/OR DRIVEWAY PAVEMENT REMOVAL SHALL INCLUDE ANY CURBS THAT HAVE BEEN CONSTRUCTED MONOLITHIC WITH THE PAVEMENT. THE COST OF REMOVING THE CURBS SHALL BE INCLUDED IN THE CONTRACT UNIT PRICE FOR "PAVEMENT REMOVAL" AND/OR "DRIVEWAY PAVEMENT REMOVAL".

NOTES:
1. REMOVAL OF CONCRETE AROUND END OF PIPE SHALL BE INCLUDED IN THE COST OF CULVERT REMOVAL.

ILLINOIS DEPARTMENT OF TRANSPORTATION

REMOVALS/RELOCATIONS PLAN

DATE: 8-05
DRAWN BY: S.M.W.
CHECKED BY: R.L.H.

SCALE: 1"=20'