

F.A.U. RTE.	SECTION	COUNTY	TOTAL SHEETS	SHEET NO.
807	00-00374-00-PV	CHAMPAIGN	149	30
STA.	TO STA.			
FED. ROAD DIST. NO. 7	ILLINOIS	F.A. PROJECT	M-5181(38)	
CONTRACT NO. 91308				

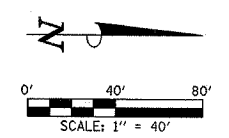
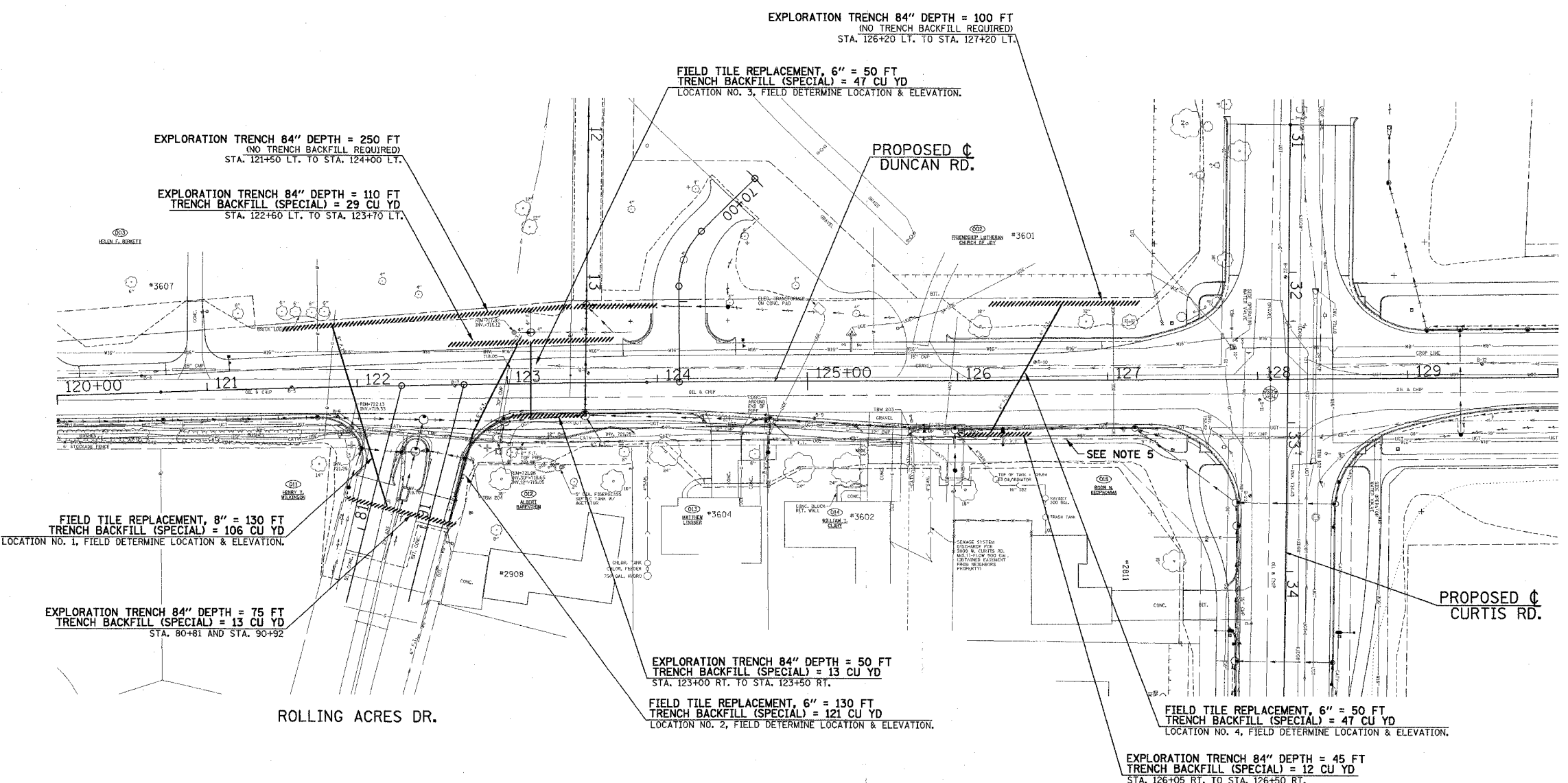

LEGEND

////// EXPLORATION TRENCH, 84"

———— FIELD TILE REPLACEMENT

SEE PLAN AND PROFILE SHEETS FOR PROPOSED STORM SEWER INFORMATION.

NOTES

1. THE LOCATIONS OF THE EXISTING FIELD TILES SHOWN ARE FROM RECORD DRAWINGS. THE EXACT LOCATIONS OF THE FIELD TILES ARE UNKNOWN. "EXPLORATION TRENCH" IS INCLUDED FOR THE PURPOSE OF LOCATING THE EXISTING FIELD TILE WITHIN THE LIMITS OF THE PROPOSED IMPROVEMENTS. THE EXPLORATION TRENCH SHALL BE CONSTRUCTED AT THE LOCATIONS SHOWN OR AS DIRECTED BY THE ENGINEER.
2. THE INTENT OF THE FIELD TILE SYSTEMS MODIFICATIONS SHOWN IS TO MAINTAIN FIELD TILE FLOW THRU THE PUBLIC RIGHT-OF-WAY BY:
 - (A) UPGRADING THE FIELD TILE WITHIN THE LIMITS OF THE PROPOSED IMPROVEMENTS USING THE "FIELD TILE REPLACEMENT" PAY ITEM AT NEAR THE SAME LOCATION AND ELEVATION AS THE EXISTING FIELD TILE.
 - AND/OR
 - (B) CONNECTING THE DOWNSTREAM END OF THE FIELD TILE TO THE PROPOSED STORM SEWER SYSTEM (SEE PLAN AND PROFILE SHEETS) AND PLUGGING THE UPSTREAM END IN ACCORDANCE WITH SECTION 611 OF THE STANDARD SPECIFICATIONS.
3. THIS WORK SHALL BE PERFORMED IN ACCORDANCE WITH THE APPLICABLE PORTIONS OF SECTIONS 213 AND 611 OF THE STANDARD SPECIFICATIONS AS THE CASE MAY BE AND AS DIRECTED BY THE ENGINEER. THIS WORK SHALL BE PAID FOR USING THE ESTABLISHED PAY ITEMS OR IN ACCORDANCE WITH ARTICLE 109.04 OF THE STANDARD SPECIFICATIONS AS DETERMINED BY THE ENGINEER. SEE THE SPECIAL PROVISIONS FOR FURTHER INFORMATION.
4. REMOVAL OF THE EXISTING PAVEMENT AT THE EXPLORATION TRENCH AND FIELD TILE REPLACEMENT LOCATIONS WILL NOT BE PAID FOR SEPARATELY BUT WILL BE INCLUDED IN THE CONTRACT UNIT PRICE PER SQUARE YARD FOR "PAVEMENT REMOVAL".
5. SEE PLAN AND PROFILE SHEETS FOR MODIFICATIONS OF THE FIELD TILE ON THE EAST SIDE OF DUNCAN RD. FROM APPROXIMATELY STA. 123+50 RT. TO STA. 127+50 RT.

RECOMMENDED SEQUENCE OF EXPLORATION & REPLACEMENT

- THE RECOMMENDED SEQUENCE OF FIELD TILE SYSTEM MODIFICATIONS IS AS FOLLOWS"
- STEP 1 - LOCATE EXISTING FIELD TILE
CONSTRUCT "EXPLORATION TRENCH" AT THE LOCATIONS SHOWN OR AS DIRECTED BY THE ENGINEER.
 - STEP 2 - EVALUATE EXISTING LOCATION AND ELEVATION
THE ENGINEER SHALL DETERMINE IF THE LOCATION AND ELEVATION OF THE EXISTING FIELD TILE CAN BE MAINTAINED OR IF IT MUST BE CONNECTED TO THE PROPOSED STORM SEWER SYSTEM BY COMPARING THE FOUND FIELD TILE WITH THE PROPOSED STORM SEWER SYSTEM.
 - STEP 3 - PERFORM SYSTEM MODIFICATIONS PER NOTE 2(A) AND/OR 2(B) AS DIRECTED BY THE ENGINEER.

ILLINOIS DEPARTMENT OF TRANSPORTATION

FIELD TILE EXPLORATION & REPLACEMENT PLAN

DATE : 8-05
DRAWN BY : S.M.W.
CHECKED BY : R.L.H.