

SEC. 27, T.19 N., R.8 E., 3rd P.M.
CHAMPAIGN COUNTY, ILLINOIS

F.A.U. RT.:	SECTION	COUNTY	TOTAL SHEETS	SHEET NO.
B07	00-00374-00-PV	CHAMPAIGN	149	40
STA. 64+70	TO STA. 68+70			
FED. ROAD DIST. NO. 7 ILLINOIS F.A. PROJECT M-5181(38)				
CONTRACT NO. 91308				

LEGEND

- PROPOSED BITUMINOUS PAVEMENT TRANSITION - SEE TYPICAL SECTIONS
- PROPOSED AGGREGATE SHOULDERS, TYPE B, 4"
- PROPOSED PAVEMENT PATCHING, TYPE IV, 8"

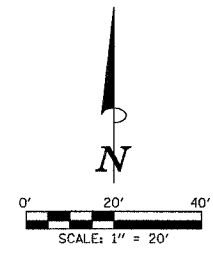

SEE SCHEDULE OF QUANTITIES FOR TYPICAL SECTION PAVEMENT PAY ITEMS AND THEIR LOCATIONS.

STATION AND OFFSET CALLOUTS ARE BASED ON \odot TEMPORARY CURTIS ROAD FROM STATION 61+00.00 AHEAD.

PROP. CURVE CURTIS-6 (FUTURE \odot)
PI STA. = 67+00.29
 Δ = 4° 38' 59" (RT)
D = 0° 53' 13"
R = 6,460.00'
T = 262.27'
L = 524.24'
E = 5.32'
P.R.C. STA = 64+38.03
P.T. STA = 69+62.27
S.E. = NONE

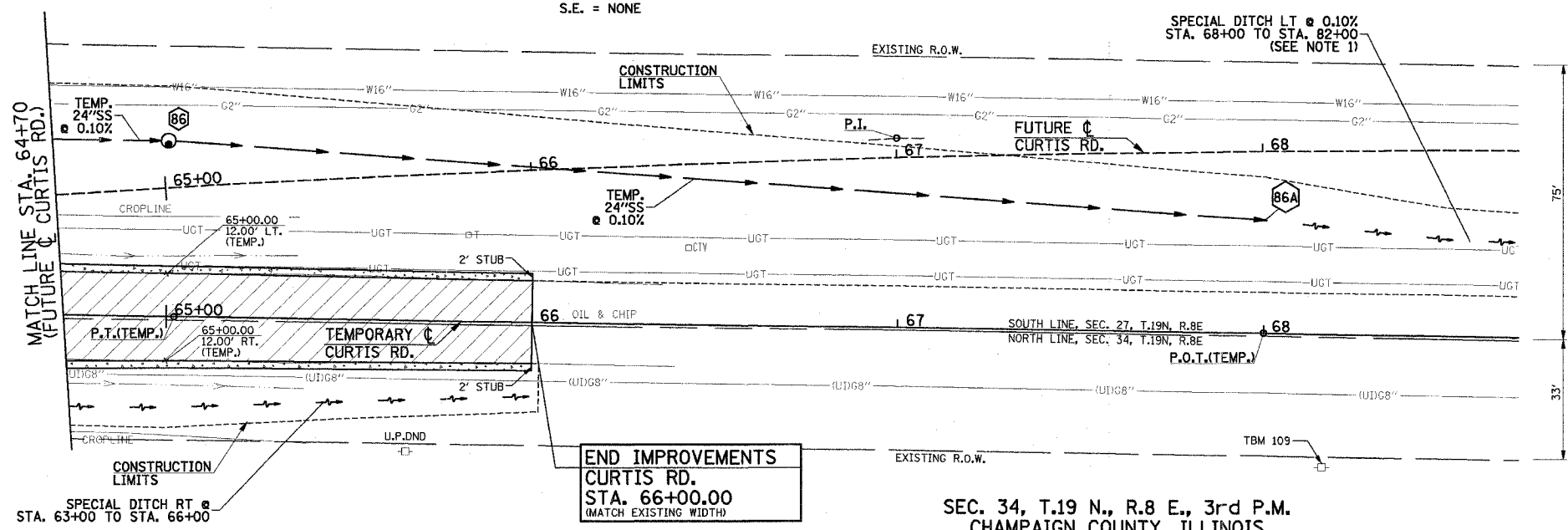

NOTES

1. SPECIAL DITCH LT. FROM STA. 68+00 TO STA. 82+00 NOT SHOWN ON PLAN AND PROFILE SHEETS. SEE CROSS SECTIONS FOR ADDITIONAL INFORMATION.
2. PIPE CULVERTS, SALVAGED PIPE 24" = 97 FT. TRENCH BACKFILL (SPECIAL) = 11.5 CU. YD. US. INV. = 744.52, 15' FROM N. CURTIS E.O.P. DS. INV. = 744.42, 13.3' FROM N. CURTIS E.O.P. PIPE AND END SECTIONS SALVAGED FROM CULVERT AT LT. STA. 32+70 (SEE SPECIAL PROVISIONS)

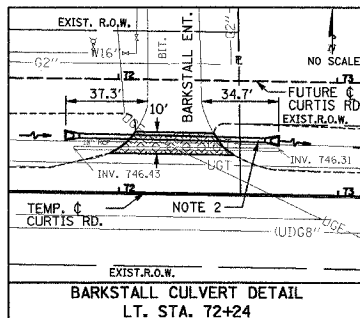

SEC. 34, T.19 N., R.8 E., 3rd P.M.
CHAMPAIGN COUNTY, ILLINOIS

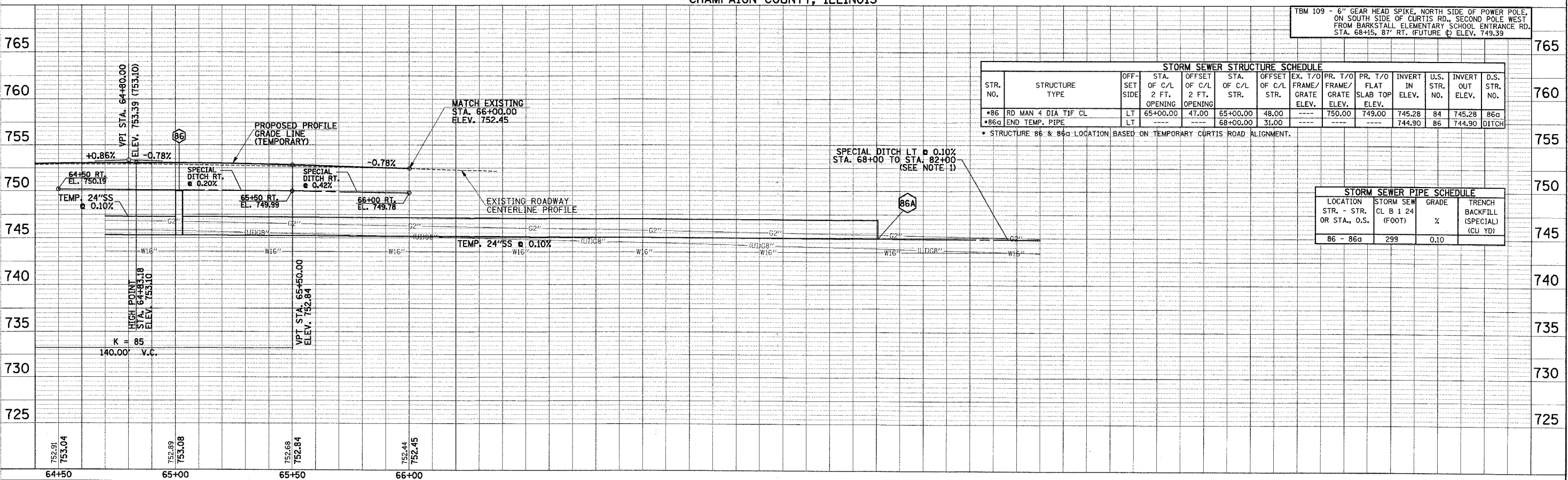

STR. NO.	STRUCTURE TYPE	OFF-SET SIDE	STA. OF C/L 2 FT. OPENING	OFFSET OF C/L 2 FT. OPENING	STA. OF C/L STR.	OFFSET OF C/L STR.	EX. T/O FRAME/GRATE ELEV.	PR. T/O FRAME/GRATE ELEV.	PR. T/O FLAT SLAB TOP ELEV.	INVERT IN ELEV.	U.S. STR. NO.	INVERT OUT ELEV.	D.S. STR. NO.
*86	RD MAN 4 DIA TIF CL	LT	65+00.00	47.00	65+00.00	48.00	---	750.00	749.00	745.28	84	745.28	86a
*86a	END TEMP. PIPE	LT	---	---	68+00.00	31.00	---	---	---	744.90	86	744.90	DITCH

* STRUCTURE 86 & 86a LOCATION BASED ON TEMPORARY CURTIS ROAD ALIGNMENT.

LOCATION STR. - STR. OR STA., O.S.	STORM SEW CL B 1 24 (FOOT)	GRADE %	TRENCH BACKFILL (SPECIAL) (CU YD)
86 - 86a	299	0.10	

TBM 109 - 6" GEAR HEAD SPIKE, NORTH SIDE OF POWER POLE, ON SOUTH SIDE OF CURTIS RD., SECOND POLE WEST FROM BARKSTALL ELEMENTARY SCHOOL ENTRANCE RD., STA. 68+15, 87' RT. (FUTURE \odot) ELEV. 749.39

DATE: _____
BY: _____
SURVEYED: _____
GRADES CHECKED: _____
STRUCTURE NOTES PREPARED: _____

DATE: _____
BY: _____
SURVEYED: _____
GRADES CHECKED: _____
STRUCTURE NOTES PREPARED: _____