

SEC. 33, T.19 N., R.8 E., 3rd P.M.
CHAMPAIGN COUNTY, ILLINOIS

004
PAUL E. CURTIS

F.A.U. RTE.	SECTION	COUNTY	TOTAL SHEETS	SHEET NO.
807	00-00374-00-PV	CHAMPAIGN	149	42
STA. 115+00 TO STA. 119+00				
FED. ROAD DIST. NO. 7 ILLINOIS F.A. PROJECT M-5181(38)				
CONTRACT NO. 91308				

LEGEND

PROPOSED AGGREGATE SUBGRADE, SPECIAL

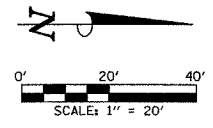

SEE SCHEDULE OF QUANTITIES FOR TYPICAL SECTION PAVEMENT PAY ITEMS AND THEIR LOCATIONS.

DATE	BY	REVISION

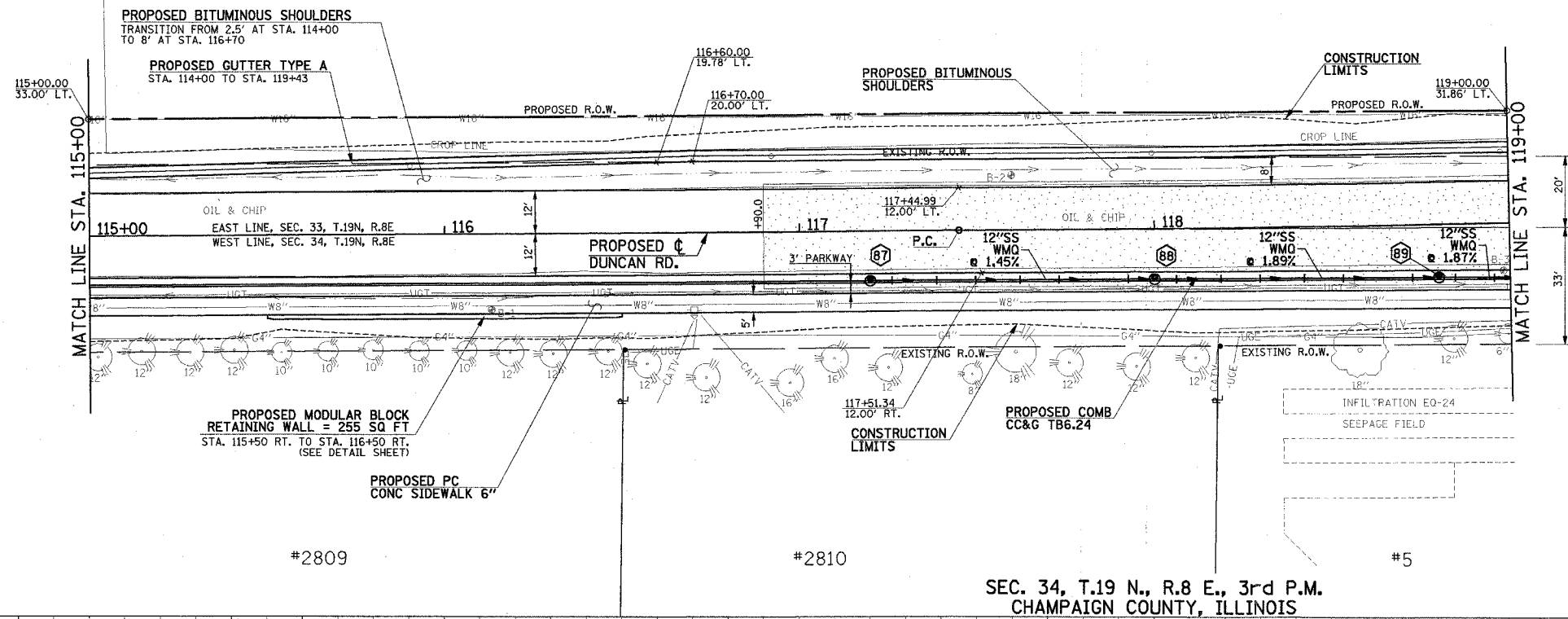

PROP. CURVE DUNC-1
PI STA. = 119+07.04
 $\Delta = 1^\circ 46' 06''$ (LT)
 $D = 0^\circ 32' 44''$
 $R = 10,500.00'$
 $T = 162.04'$
 $L = 324.05'$
 $E = 1.25'$
P.C. STA = 117+45.00
P.R.C. STA = 120+69.05
S.E. = NONE

SEC. 34, T.19 N., R.8 E., 3rd P.M.
CHAMPAIGN COUNTY, ILLINOIS

DATE	BY	REVISION

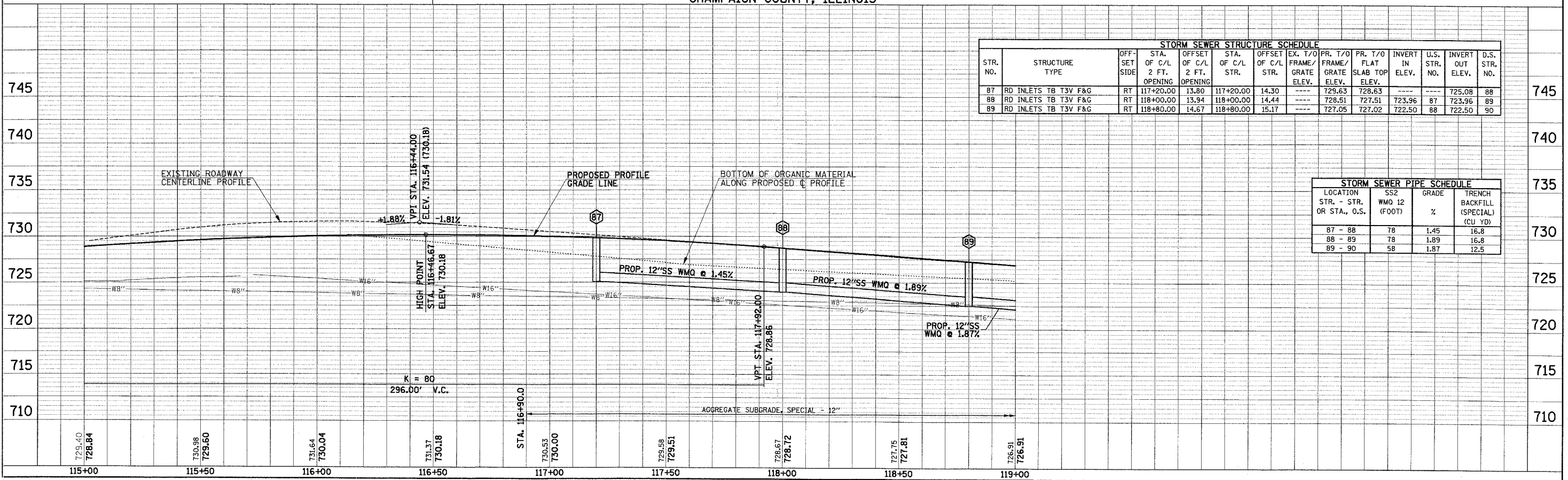

STR. NO.	STRUCTURE TYPE	OFF-SET OF C/L SIDE	STA. OF C/L 2 FT. OPENING	OFFSET OF C/L 2 FT. STR.	STA. OF C/L STR.	OFFSET OF C/L STR.	EX. T/O PR. T/O FRAME/GRATE ELEV.	PR. T/O FLAT SLAB TOP ELEV.	INVERT IN ELEV.	U.S. STR. NO.	INVERT OUT ELEV.	D.S. STR. NO.
87	RD INLETS TB T3V F&G	RT	117+20.00	13.80	117+20.00	14.30	---	729.63	728.63	---	725.08	88
88	RD INLETS TB T3V F&G	RT	118+00.00	13.94	118+00.00	14.44	---	728.51	727.51	723.96	723.96	89
89	RD INLETS TB T3V F&G	RT	118+80.00	14.67	118+80.00	15.17	---	727.05	727.02	722.50	722.50	90

LOCATION STR. - STR. OR STA., O.S.	SS2 WMO 12 (FOOT)	GRADE %	TRENCH BACKFILL (SPECIAL) (CU YD)
87 - 88	78	1.45	16.8
88 - 89	78	1.89	16.8
89 - 90	58	1.87	12.5

P:\C01330\GEOPAK\2DFILES\PI2DUNCAN.DGN