

| | | | | |
|-----------------------|----------------|---------------|--------------|-----------|
| F.A.U. NO. | SECTION | COUNTY | TOTAL SHEETS | SHEET NO. |
| 807 | 00-00374-00-PV | CHAMPAIGN | 149 | 74 |
| STA. 51+50 | | TO STA. 60+70 | | |
| FED. ROAD DIST. NO. 7 | ILLINOIS | F.A. PROJECT | M-5181(38) | |

CONTRACT NO. 91308

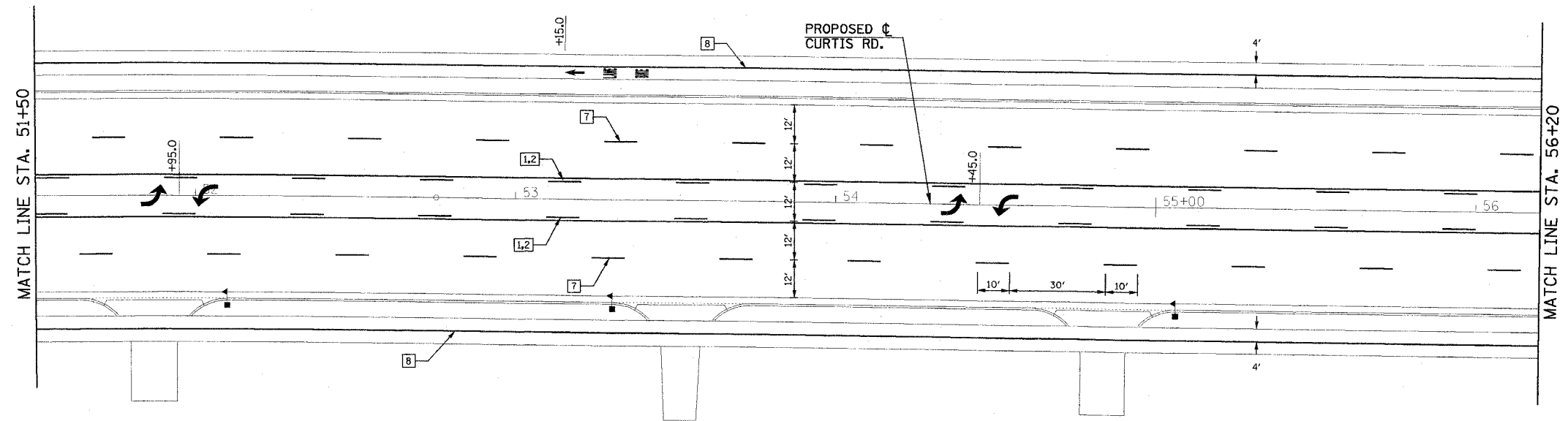

| TYPICAL PAVEMENT MARKING LEGEND | | | |
|---------------------------------|---------------------------|----|---------------------------------|
| 1 | 4" SKIP-DASH (YELLOW) | 8 | 4" SOLID (WHITE) |
| 2 | 4" SOLID (YELLOW) | 9 | 12" DIAGONAL (WHITE) |
| 3 | 12" DIAGONAL (YELLOW) | 10 | 6" CROSSWALK (WHITE) |
| 4 | 4" DOUBLE YELLOW (NARROW) | 11 | 24" STOP BAR (WHITE) |
| 5 | 4" DOUBLE YELLOW (WIDE) | 12 | 8" SOLID (WHITE) |
| 6 | RESERVED | 13 | 4" LANE LINE EXTENSIONS (WHITE) |
| 7 | 4" SKIP-DASH (WHITE) | 14 | RESERVED |

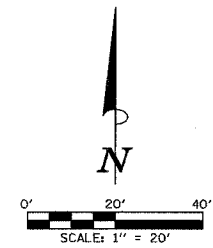
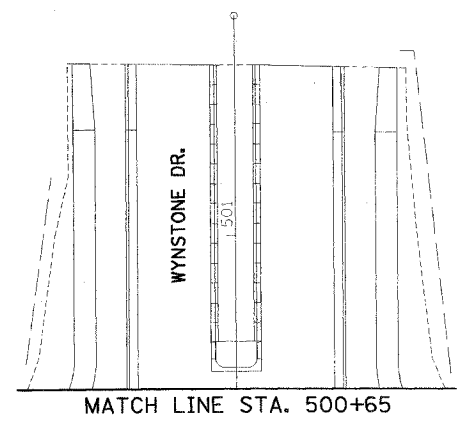
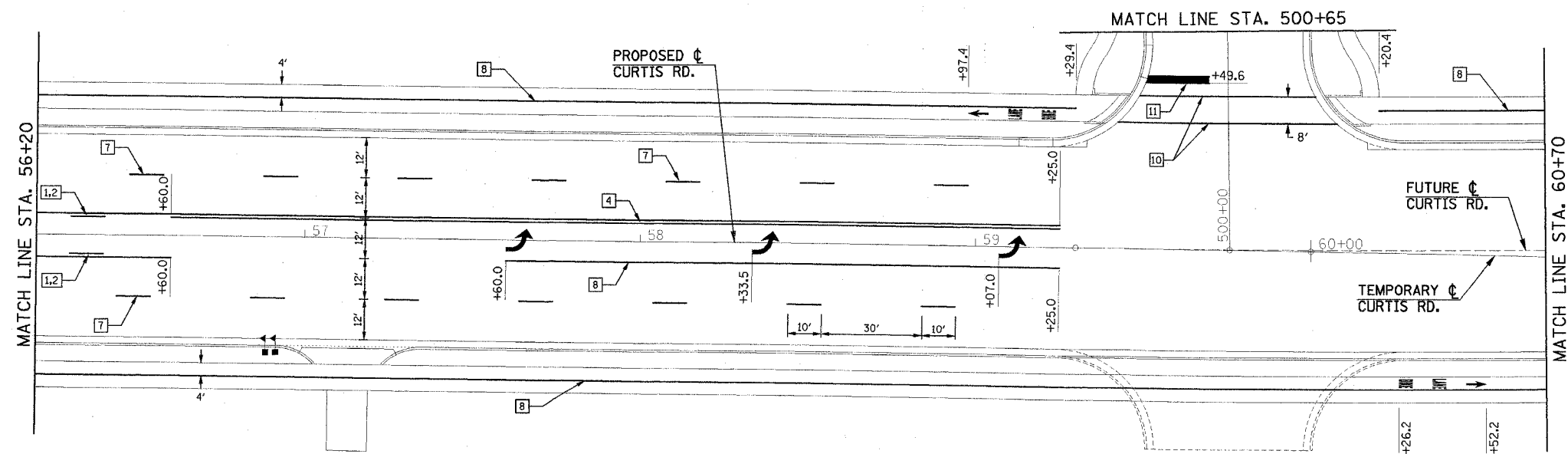

ILLINOIS DEPARTMENT OF TRANSPORTATION

PAVEMENT MARKING PLAN

DATE : 8-05
 DRAWN BY : S.M.W.
 CHECKED BY : R.L.H.

SCALE : 1"=20'