

| ROUTE NO.  | SECTION        | COUNTY  | TOTAL SHEETS |
|------------|----------------|---------|--------------|
| C.H. 23    | 94-00087-00-BR | HANCOCK | 43           |
| ROAD DIST. | ILLINOIS       |         |              |

# STATE OF ILLINOIS

## DEPARTMENT OF TRANSPORTATION

### DIVISION OF HIGHWAYS

# PLANS FOR PROPOSED MAJOR BRIDGE PROGRAM

**COUNTY HIGHWAY C.H. 23(FAS RTE. 429)**  
**SECTION 94-00087-00-BR**  
**HANCOCK COUNTY**  
**PROJECT NO. BRS-429(102)**  
**JOB NO. C-96-205-06**

**INDEX OF SHEETS**

| SHEET NO. | TITLE   |
|-----------|---|
| 1.        | COVER SHEET   |
| 2.        | SUMMARY OF QUANTITIES, GENERAL NOTES & TYPICAL SECTIONS |
| 3.        | ENTRANCE DETAILS  |
| 4.-5.     | PLAN AND PROFILE  |
| 6.        | SHOULDER AND GUARDRAIL DETAILS                          |
| 7.-26.    | BRIDGE PLANS  |
| 27.-40.   | STATION CROSS SECTIONS                                  |
| 41.       | EROSION CONTROL PLAN                                    |
| 42.-43.   | TEMPORARY FENCE   |

**STANDARDS:**

- 280001-02
- 420001-06
- 420401-05
  
- 515001-02
- 601101
- 630001-05
- 631011-02
- 631026-02
- 635006-02
- 702001-05
- BLR 21-6

**SCALES**

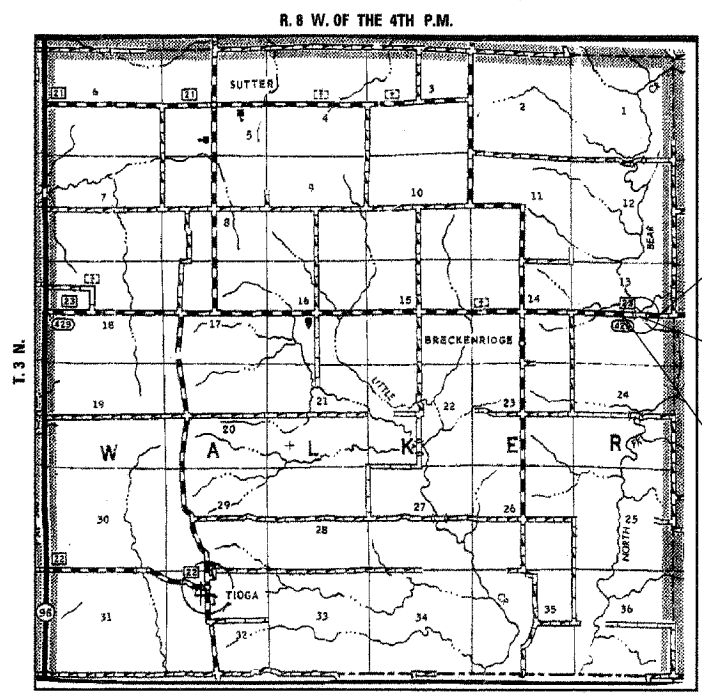
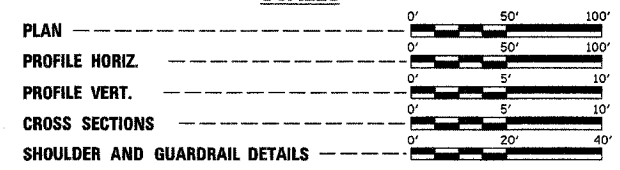

**LOCATION PLAN**

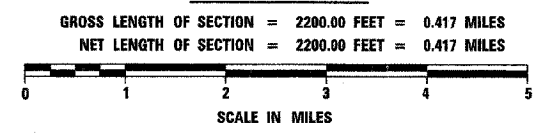

**MAJOR COLLECTOR (UNDER 400 ADT)**  
**CURRENT ADT 242 (2005)**  
**DESIGN SPEED 40 MPH**

**IMPROVEMENT ENDS  
STA. 320 + 50**

**STA. 313 + 34 - SPECIAL BRIDGE DESIGN  
CONTINUOUS STEEL COMPOSITE WIDE FLANGE  
BEAM BRIDGE; 5 SPANS AT 72',90',90',  
90',72'; SKEW = 0°; 30'-0" ROADWAY  
EXISTING S.N. 034-3230  
PROPOSED S.N. 034-3231**

**IMPROVEMENT BEGINS  
STA. 298 + 50**



*Gary J. Cartwright* 10-17-05  
 ILLINOIS PROFESSIONAL ENGINEER NO. 43408  
 EXPIRES 11-30-05

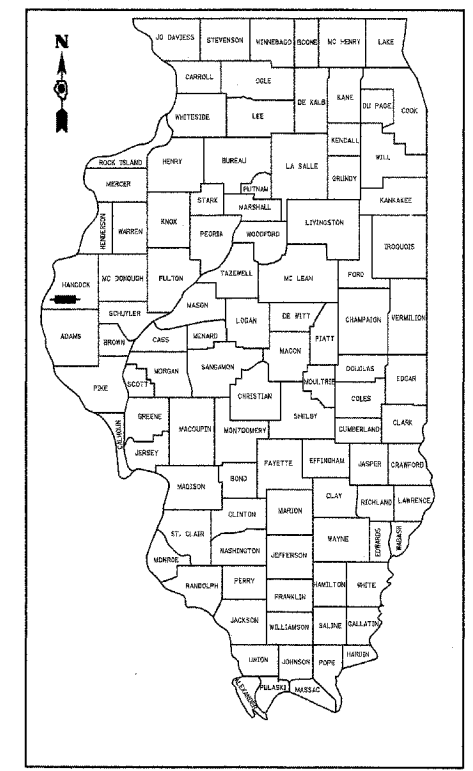

LOCATION OF SECTION INDICATED THUS:

TOLL FREE JOINT UTILITY LOCATING  
 INFORMATION FOR EXCAVATORS (J.U.L.I.E.)  
 TELEPHONE NUMBER 1-800-892-0123

|   |   |      |
|---|---|------|
| APPROVED  | 10-13   | 2005 |
|   | <i>Paul E. Sy</i><br>COUNTY ENGINEER  |      |
| PASSED  | Oct 30  | 2005 |
|   | <i>Tommy Ford</i><br>DISTRICT ENGINEER OF LOCAL ROADS & STREETS               |      |
| PASSED  | Oct 25  | 2005 |
|   | <i>E. B. Fung</i><br>DISTRICT SIX ENGINEER OF CONSTRUCTION                    |      |
| RELEASING FOR BID<br>BASED ON LIMITED<br>REVIEW   | Oct 26  | 2005 |
|   | <i>Christine M. Reed</i><br>DEPUTY DIRECTOR OF HIGHWAYS, REGION FOUR ENGINEER |      |
| STATE OF ILLINOIS<br>DEPARTMENT OF TRANSPORTATION |   |      |