

PROP. HOT MIX ASPHALT SURFACE REMOVAL (2 1/2") - (TYP.)
 PROP. POLYMERIZED LEVELING BINDER (MM) IL. - 4.75, N50 (3/4") - (TYP.)
 PROP. POLYMERIZED HOT MIX ASPHALT SURFACE COURSE, MIX "F", N90, (1 3/4") - (TYP.)

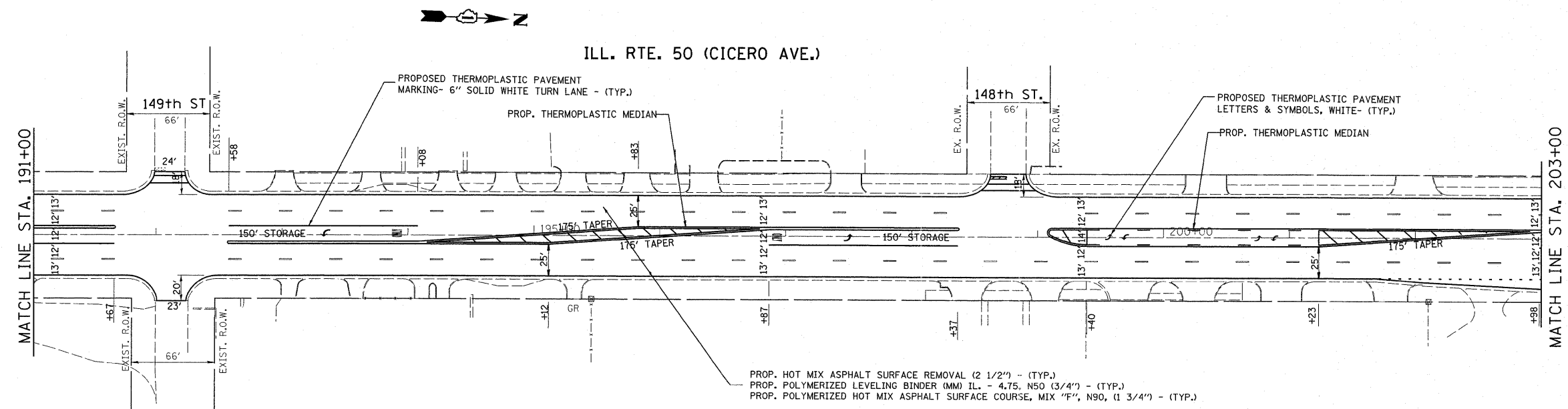

PROP. HOT MIX ASPHALT SURFACE REMOVAL (2 1/2") - (TYP.)
 PROP. POLYMERIZED LEVELING BINDER (MM) IL. - 4.75, N50 (3/4") - (TYP.)
 PROP. POLYMERIZED HOT MIX ASPHALT SURFACE COURSE, MIX "F", N90, (1 3/4") - (TYP.)

FILE NAME = c:\pwork\pwork\guillaumefp\d0208043\63110-shr-plan.dgn	USER NAME = guillaumefp	DESIGNED -	REVISED -	STATE OF ILLINOIS DEPARTMENT OF TRANSPORTATION	ILL. RTE 50 (CICERO AVE.) (147th ST. TO 175th ST.) ROADWAY & PAVEMENT MARKING PLAN	F.A.P. RTE. 350	SECTION 101 EXT-RS-2	COUNTY COOK	TOTAL SHEETS 33	SHEET NO. 13
	PLOT SCALE = 50.0000' / in.	CHECKED -	REVISED -			SCALE: 1"=50'	SHEET NO. OF SHEETS	STA. 177+00 TO STA. 203+00	CONTRACT NO. 60L03	
PLOT DATE = 11/1/2011	DATE -	REVISED -	REVISED -							