

REMOVAL OF EXISTING TRAFFIC SIGNAL EQUIPMENT

THE FOLLOWING EXISTING TRAFFIC SIGNAL EQUIPMENT SHALL BE REMOVED BY THE CONTRACTOR, SHALL REMAIN THE PROPERTY OF THE STATE AND SHALL BE DELIVERD BY THE CNOTRACTOR TO THE STATE'S TRAFFIC SIGNAL MAINTENANCE CONTRACTOR'S MAIN FACILITY AS PER THE TRAFFIC SIGNAL SPECIFICATIONS.

- 4 EACH PED. SIGNAL HEAD, L.E.D., 2 - FACE
- 4 EACH PED. PUSH BUTTON
- 1 EACH CONTROLLER AND CABINET (COMPLETE)
- 1 EACH UNINTERRUPTABLE POWER SUPPLY (COMPLETE)
- 4 EACH VIDEO DETECTION CAMERA

THE FOLLOWING EXISTING TRAFFIC SIGNAL EQUIPMENT SHALL BE REMOVED BY THE CONTRACTOR AND SHALL REMAIN THE PROPERTY OF THE AGENCY LISTED BELOW. THE CONTRACTOR SHALL SAFELY STORE AND ARRANGE FOR PICK UP OF ALL EQUIPMENT TO BE RETURNED TO THE LISTED AGENCY AS PER THE TRAFFIC SIGNAL SPECIFICATIONS.

AGENCY: VILLAGE OF LINCOLNSHIRE

- 3 EACH LIGHT DETECTOR AND BEACON
- 1 EACH LIGHT DETECTOR AMPLIFIER

THE FOLLOWING ITEMS SHALL BE REMOVED BY THE CONTRACTOR AND SHALL BE DISPOSED OF BY THEM OUTSIDE THE RIGHT-OF-WAY AT THEIR EXPENSE. THE SALVAGE VALUE OF THE REMOVED EQUIPMENT SHALL BE REFLECTED IN THE CONTRACT BID PRICE.

- 12 EACH SIGNAL HEAD, 1 - FACE, 3 - SECTION
- 4 EACH SIGNAL HEAD, 1 - FACE, 5 - SECTION,
- 4 EACH TEMPORARY WOOD POLE AND GUY WIRE (COMPLETE)
- 1 EACH TRAFFIC SIGNAL POST
- 1 EACH ELECTRICAL SERVICE
- 2 EACH LUMINAIRE & MAST ARM ON WOOD POLE
- 2 EACH WOOD POST (100mm x 100mm)

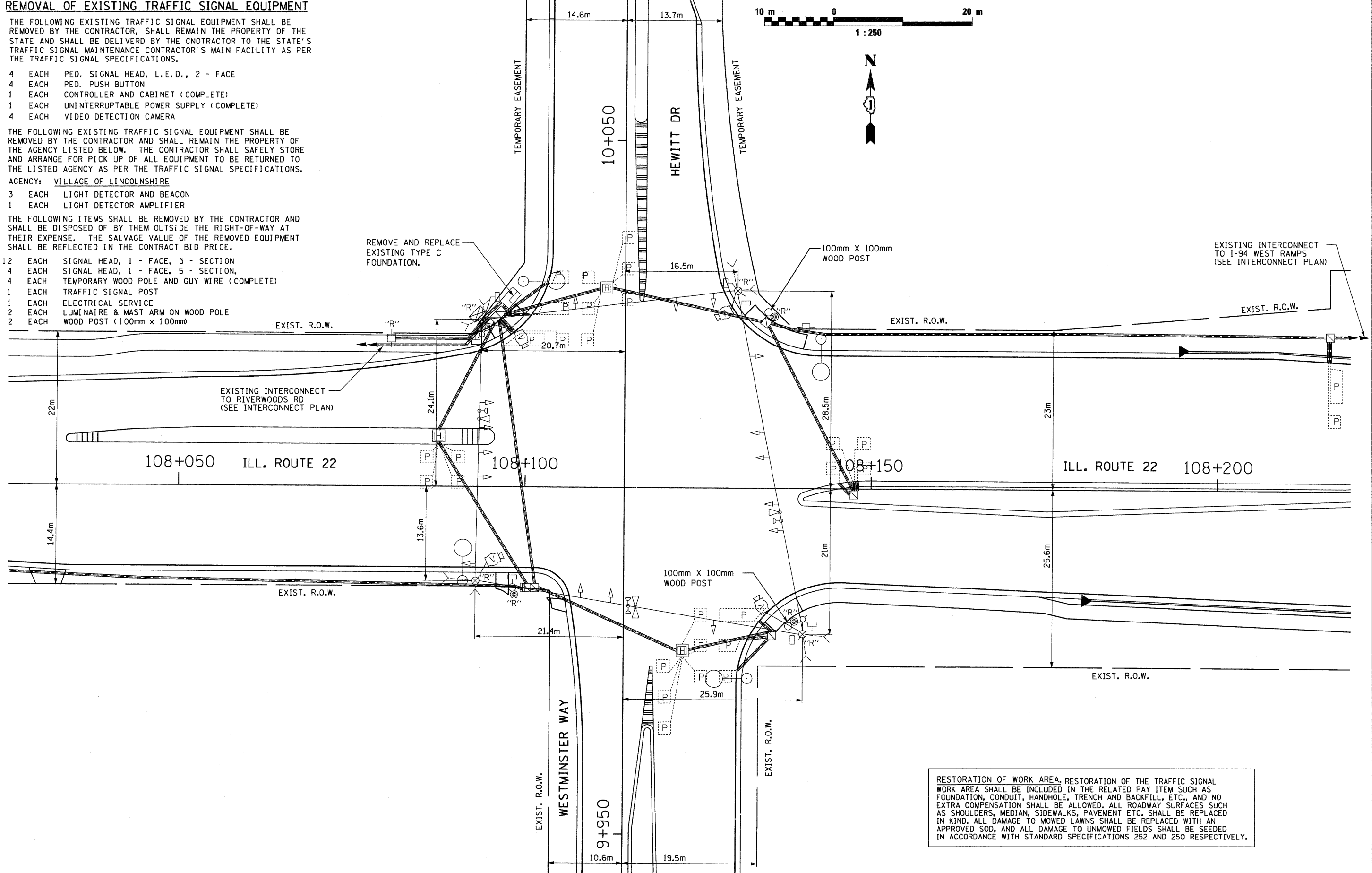

RESTORATION OF WORK AREA, RESTORATION OF THE TRAFFIC SIGNAL WORK AREA SHALL BE INCLUDED IN THE RELATED PAY ITEM SUCH AS FOUNDATION, CONDUIT, HANDHOLE, TRENCH AND BACKFILL, ETC., AND NO EXTRA COMPENSATION SHALL BE ALLOWED. ALL ROADWAY SURFACES SUCH AS SHOULDERS, MEDIAN, SIDEWALKS, PAVEMENT ETC. SHALL BE REPLACED IN KIND. ALL DAMAGE TO MOWED LAWNS SHALL BE REPLACED WITH AN APPROVED SOD, AND ALL DAMAGE TO UNMOWED FIELDS SHALL BE SEEDD IN ACCORDANCE WITH STANDARD SPECIFICATIONS 252 AND 250 RESPECTIVELY.

FILE NAME = #FILE#	USER NAME = #USER#	DESIGNED - JDH	REVISED -	STATE OF ILLINOIS DEPARTMENT OF TRANSPORTATION	IL ROUTE 22 (HALF DAY RD) AT WESTMINSTER WAY / HEWITT RD REMOVE EXISTING TRAFFIC SIGNAL EQUIPMENT PLAN	F.A. RTE. 337	SECTION 20-N-4	COUNTY LAKE	TOTAL SHEETS 18	SHEET NO. 9		
PLOT SCALE = #SCALE#	CHECKED - DW	REVISED -	SCALE: 1:250			SHEET NO. 1 OF 3 SHEETS	STA. TO STA.	ILLINOIS FED. AID PROJECT				
PLOT DATE = #DATE#	DATE -	REVISED -										
CONTRACT NO. 60L19												