

- PAVEMENT MARKING LEGEND
- (A) 4" WHITE - SOLID (EDGE LINE)
 - (B) 4" YELLOW - SOLID, 2 @ 11" C-C
 - (C) 4" WHITE - SOLID, 2 @ 11" C-C
 - (D) 6" WHITE - SOLID, (TURN LANE LINE)
 - (E) 12" WHITE - SOLID, DIAGONAL 20' C-C
 - (F) 12" YELLOW - SOLID, (RT. 45 33/64 DIAGONAL) @ 75' C-C, (FLEMING RD.)
 - (G) 12" YELLOW - SOLID (RT. 45° DIAGONAL) @ 150' C-C, (IL. 120)
 - (H) 24" WHITE - SOLID, STOP BAR
 - (I) 8' WHITE - SOLID, LETTERS & SYMBOLS (LEFT OF RIGHT TURN ONLY)

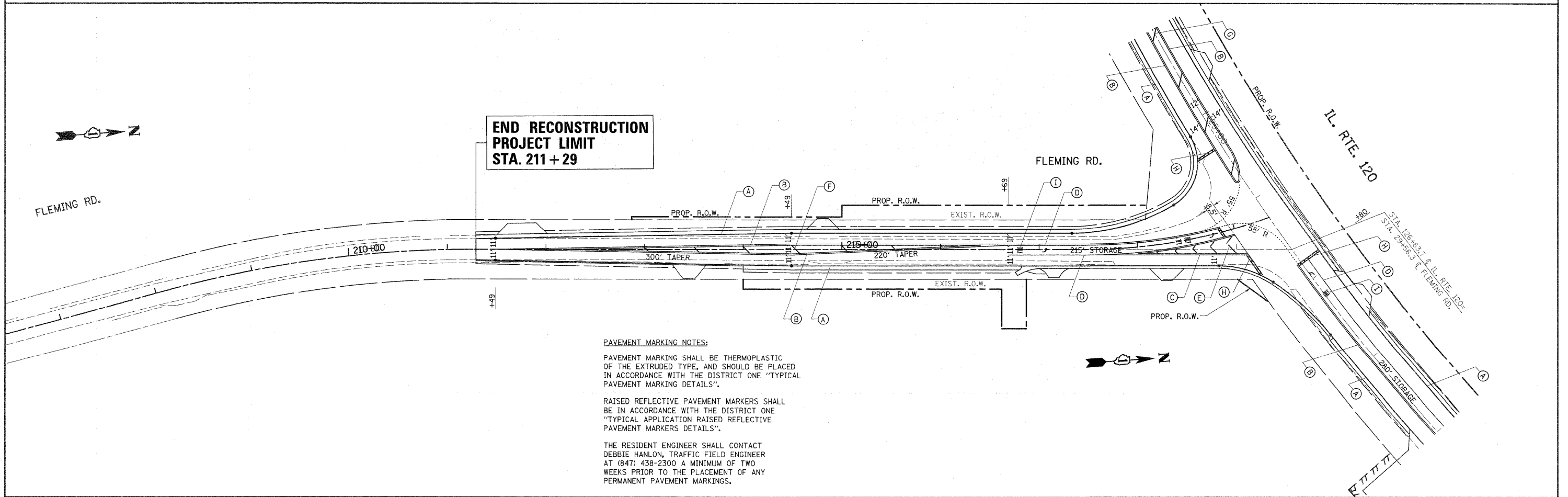

PAVEMENT MARKING NOTES:

PAVEMENT MARKING SHALL BE THERMOPLASTIC OF THE EXTRUDED TYPE, AND SHOULD BE PLACED IN ACCORDANCE WITH THE DISTRICT ONE "TYPICAL PAVEMENT MARKING DETAILS".

RAISED REFLECTIVE PAVEMENT MARKERS SHALL BE IN ACCORDANCE WITH THE DISTRICT ONE "TYPICAL APPLICATION RAISED REFLECTIVE PAVEMENT MARKERS DETAILS".

THE RESIDENT ENGINEER SHALL CONTACT DEBBIE HANLON, TRAFFIC FIELD ENGINEER AT (847) 438-2300 A MINIMUM OF TWO WEEKS PRIOR TO THE PLACEMENT OF ANY PERMANENT PAVEMENT MARKINGS.

FILE NAME = P113787-ehs-pmk.dgn

USER NAME = drsvakosgn
 PLOT SCALE = 50.0000' / in.
 PLOT DATE = 7/27/2011

DESIGNED -	REVISED -
DRAWN -	REVISED -
CHECKED -	REVISED -
DATE -	REVISED -

**STATE OF ILLINOIS
DEPARTMENT OF TRANSPORTATION**

**PAVEMENT MARKING PLAN
IL. ROUTE 120 FLEMING RD.**

SCALE: 1" = 50' SHEET NO. OF SHEETS STA. TO STA.

F.A.P. RTE. 333	SECTION 15-N-6	COUNTY McHENRY	TOTAL SHEETS G7	SHEET NO. 35
CONTRACT NO. 60L27				
ILLINOIS FED. AID PROJECT				