

FINAL SURVEY	SUBMITTED	BY	DATE
NOTE BOOK	PLOTTED		
NO.	TEMPLATE		
	AREAS CHECKED		
	AREAS CHECKED		

ORIGINAL SURVEY	SUBMITTED	BY	DATE
NOTE BOOK	PLOTTED		
NO.	TEMPLATE		
	AREAS CHECKED		
	AREAS CHECKED		

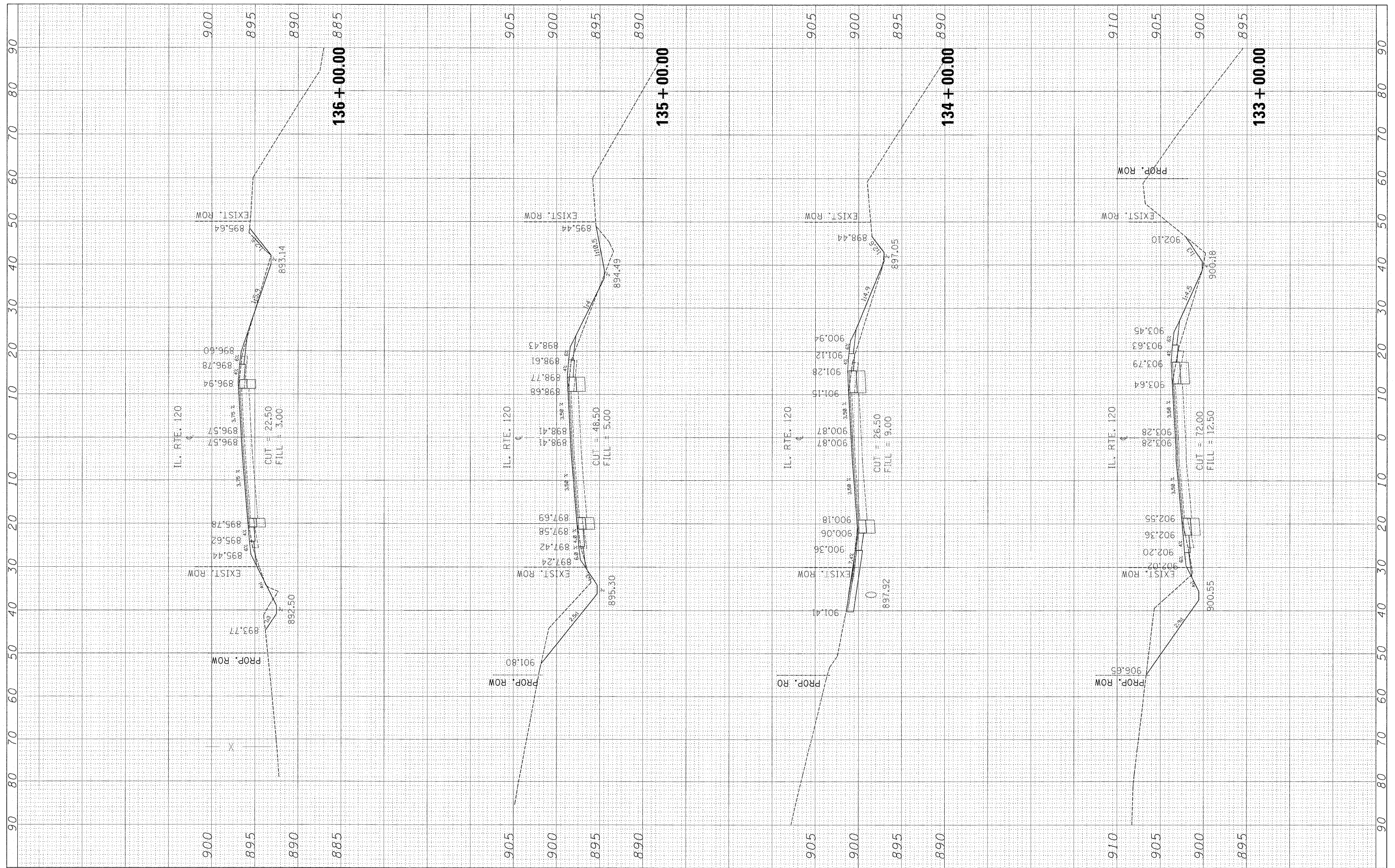

FILE NAME = c:\pwork\pwork\galbenjr\d0107803\F113787-sh

USER NAME = galbenjr  
 DESIGNED -  
 DRAWN -  
 CHECKED -  
 DATE -

DESIGNED -  
 DRAWN -  
 CHECKED -  
 DATE -

REVISI  
 REVISI  
 REVISI  
 REVISI

**STATE OF ILLINOIS  
 DEPARTMENT OF TRANSPORTATION**

**IL. RTE. 120 AT FLEMING RD.  
 CROSS SECTIONS**

SCALE: SHEET NO. OF SHEETS STA. 133+00.00 TO STA. 136+00.00

F.A.P. RTE. 333	SECTION 15-N-6	COUNTY McHenry	TOTAL SHEETS 67	SHEET NO. 66
CONTRACT NO. 60L27				
FED. ROAD DIST. NO.		ILLINOIS FED. AID PROJECT		