

**PAVEMENT MARKING KEY NOTE LEGEND:**

- (A) PROP. THERMO. PVT. MARKING (YELLOW) - 4" SOLID CENTERLINE (2 LINES @ 11" C-C) - (TYP.)
- (B) PROP. THERMO. PVT. MARKING (YELLOW) - 4" SKIP-DASH CENTERLINE (10' LINE - 30' SPACE) - (TYP.)
- (B1) PROP. THERMO. PVT. MARKING (YELLOW) - 4" SOLID NO PASSING ZONE LINE (5-1/2" C-C FROM SKIP-DASH) - (TYP.)
- (C) PROP. THERMO. PVT. MARKING (YELLOW) - 4" SOLID EDGELINE - (TYP.)
- (D) PROP. THERMO. PVT. MARKING (WHITE) - 4" SOLID EDGELINE - (TYP.)
- (E) PROP. THERMO. PVT. MARKING (WHITE) - 4" SKIP-DASH LANE LINE (10' LINE - 30' SPACE) - (TYP.)
- (F) PROP. THERMO. PVT. MARKING (WHITE) - 6" SOLID TURN LANE LINE - (TYP.)
- (G) PROP. THERMO. PVT. MARKING (WHITE) - 6" SKIP-DASH TURN LANE LINE (2' LINE - 6' SPACE) - (TYP.)
- (H) PROP. THERMO. PVT. MARKING (WHITE) - 6" SOLID PEDESTRIAN CROSSWALK - (TYP.)
- (I) PROP. THERMO. PVT. MARKING (WHITE) - 8" SOLID CHANNELIZATION LINE - (TYP.)
- (J) PROP. THERMO. PVT. MARKING (WHITE) - 12" LONGITUDINAL CROSSWALK - RT. 90° 6' LINE, @ 2' APART - (TYP.)
- (K) PROP. THERMO. PVT. MARKING (WHITE) - 12" SOLID CHANNELIZATION LINE - RT. 45° CHEVRON @ 20' C-C - (TYP.)
- (L) PROP. THERMO. PVT. MARKING (YELLOW) - 12" SOLID PAINTED MEDIAN DIAGONAL LINE - RT. 45° DIAGONAL @ 50' C-C - (TYP.)
- (M) PROP. THERMO. PVT. MARKING (YELLOW) - 12" SOLID PAINTED MEDIAN DIAGONAL LINE - RT. 45° DIAGONAL @ 20' C-C - (TYP.)
- (N) PROP. THERMO. PVT. MARKING (WHITE) - 12" SOLID SHOULDER DIAGONAL LINE - RT. 45° DIAGONAL @ 20' C-C - (TYP.)
- (O) PROP. THERMO. PVT. MARKING (WHITE) - 24" SOLID STOP BAR - (TYP.)
- (P) PROP. THERMO. PVT. MARKING (WHITE) LETTERS AND SYMBOLS - (TYP.)
- (Q) PROP. THERMO. PVT. MARKING (WHITE) RAILROAD-HIGHWAY GRADE CROSSING MARKINGS LETTERS AND SYMBOLS FOR "RR" - (TYP.) 16" SOLID LINES FOR "X" (TYP.) 24" SOLID TRANSVERSE LINES - (TYP.) SEE STATE STANDARD DETAIL 780001

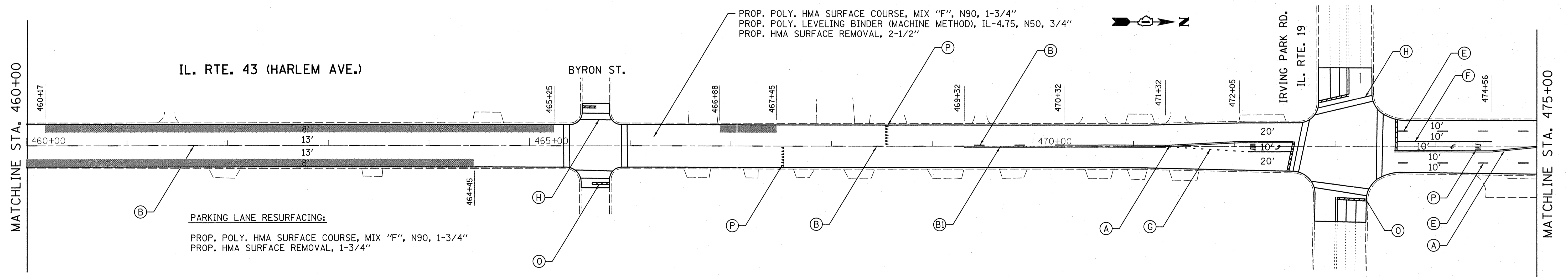

FILE NAME =	USER NAME = beckercom	DESIGNED -	REVISED -	<b>STATE OF ILLINOIS DEPARTMENT OF TRANSPORTATION</b>	<b>IL RTE. 43 (HARLEM AVE.) - (26TH ST. TO CULLOM AVE.) ROADWAY AND PAVEMENT MARKING PLAN</b>	F.A.P. RTE.	SECTION	COUNTY	TOTAL SHEETS	SHEET NO.	
10-20-2011	5311-sht-pln.dgn	DRAWN -	REVISED -			348	2010-090-RS	COOK	55	20	
	PLOT SCALE = 50.0000' / 1" =	CHECKED -	REVISED -			SHEET NO. OF SHEETS STA. TO STA.		CONTRACT NO. 60L86			
	PLOT DATE = 10/20/2011	DATE -	REVISED -			FED. ROAD DIST. NO. 1 ILLINOIS FED. AID PROJECT					