

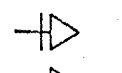

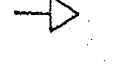





WORK SHALL MEET THE REQUIREMENTS OF THE SPECIAL PROVISION, "TRAFFIC SIGNAL SIGNAL SPECIFICATIONS FOR DETECTOR LOOP REPLACEMENT AND/OR INSTALLATION ON ROADWAY GRINDING, RESURFACING AND PATCHING OPERATIONS". SPECIAL ATTENTION MUST BE MADE TO THE SECTIONS "INSPECTION OF CONSTRUCTION" AND "DETECTOR LOOP REPLACEMENT" FOR INSTALLATION AND INSPECTION REQUIREMENTS. LOOP REPLACEMENT WORK THAT DOES NOT MEET THE CONTRACT REQUIREMENTS SHALL NOT BE PAID. WORK NECESSARY TO COMPLETE THE LOOP REPLACEMENT WORK MAY BE ASSIGNED BY THE ENGINEER TO IDOT'S ELECTRICAL MAINTENANCE CONTRACTOR (EMC); ALL RELATED COSTS WILL BE THE RESPONSIBILITY OF THE CONTRACTOR.

TRAFFIC SIGNAL LEGEND

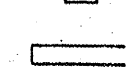
- | | | | |
|--|---|----------|---|
| SIGNAL HEAD WITH BACKPLATE |  | EXISTING |  |
| SIGNAL HEAD |  | |  |
| GALVANIZED STEEL CONDUIT IN TRENCH OR PUSHED |  | |  |
| DETECTOR LOOP |  | |  |
| VEHICLE DETECTOR, NON COMPENSATED MAGNETIC TYPE | | |  |
| RACEWAY FOR MAGNETIC DETECTOR, TYPE I OR TYPE II | | |  |

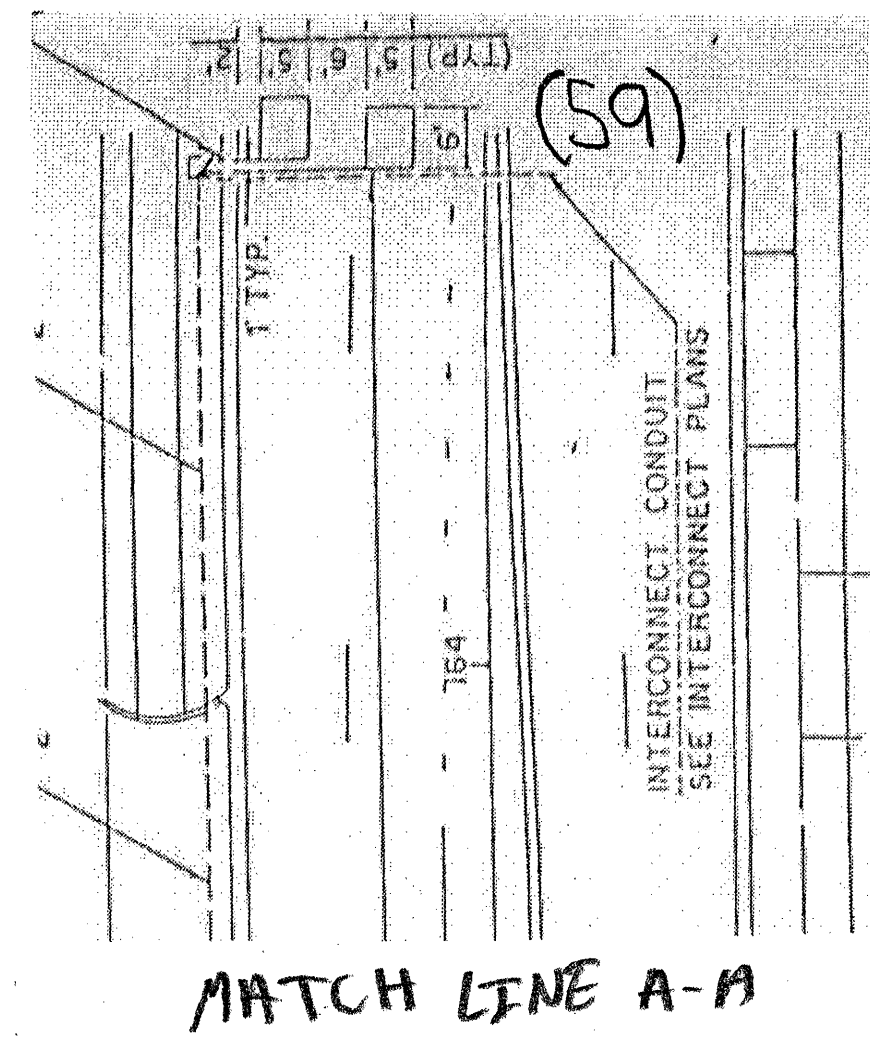

RESURFACING LIMITS

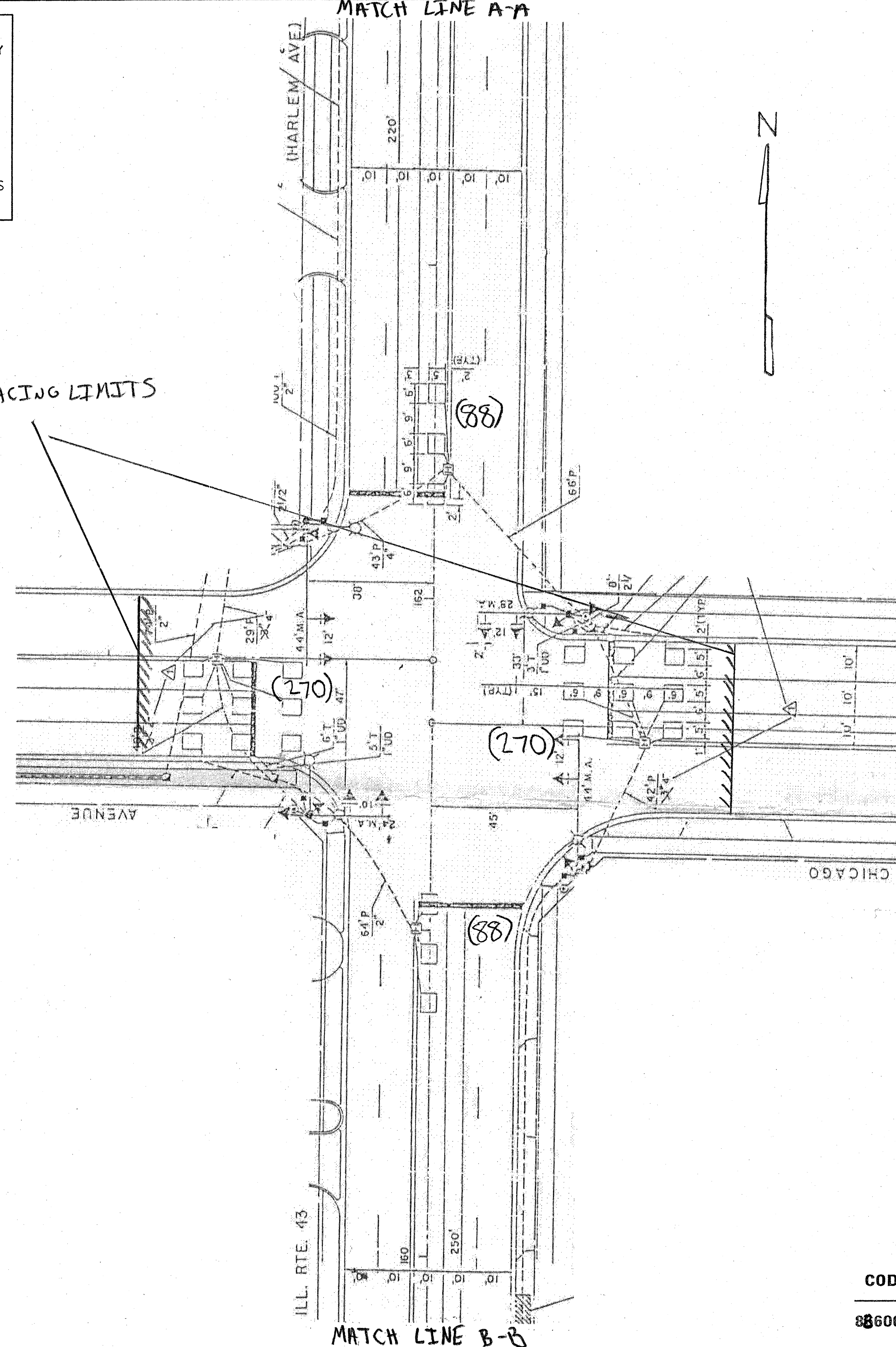

THIS PLAN IS FOR THE SOLE PURPOSE OF
DETECTOR LOOP REPLACEMENTS ONLY

REPLACE ALL DETECTOR LOOPS AS SHOWN
(WITHIN THE RESURFACING LIMITS)

CODE	QUANTITY	UNIT	ITEM
88600600	834	FOOT	DETECTOR LOOP, REPLACEMENT

FILE NAME = c:\pw_work\pwidot\nguyensm\d0112618\flasher.dgn	USER NAME = nguyensm	DESIGNED - DRAWN -	REVISED - REVISED -	STATE OF ILLINOIS DEPARTMENT OF TRANSPORTATION	DISTRICT ONE - DETECTOR LOOP REPLACEMENT IL 53 HARLEM AVE @ CHICAGO AVE.	F.A.P. RTE. #	SECTION	COUNTY	TOTAL SHEETS	SHEET NO.
PLOT SCALE = 100.0000 / IN.	CHECKED -	REVISED -	318			2010-090-25	COOK	55	37	
PLOT DATE = 11/19/2010	DATE -	REVISED -	CONTRACT NO. 60186			ILLINOIS FED. AID PROJECT				
SCALE: SHEET NO. OF SHEETS STA. TO STA.		FED. ROAD DIST. NO.				ILLINOIS FED. AID PROJECT				