

When cantilever forming brackets are used, the work shall be done according to Article 503.06(b) of the Standard Specifications, except as modified below and in the details shown on this sheet.
 The finishing machine rails shall be placed on the top flange of the exterior beams.
 The beams or girders, supporting cantilever forming brackets, shall be tied together at 4 foot intervals.
 For Standard construction, or Stage Construction the Hardwood bracing materials shall be placed as shown between webs of beams in each bay.

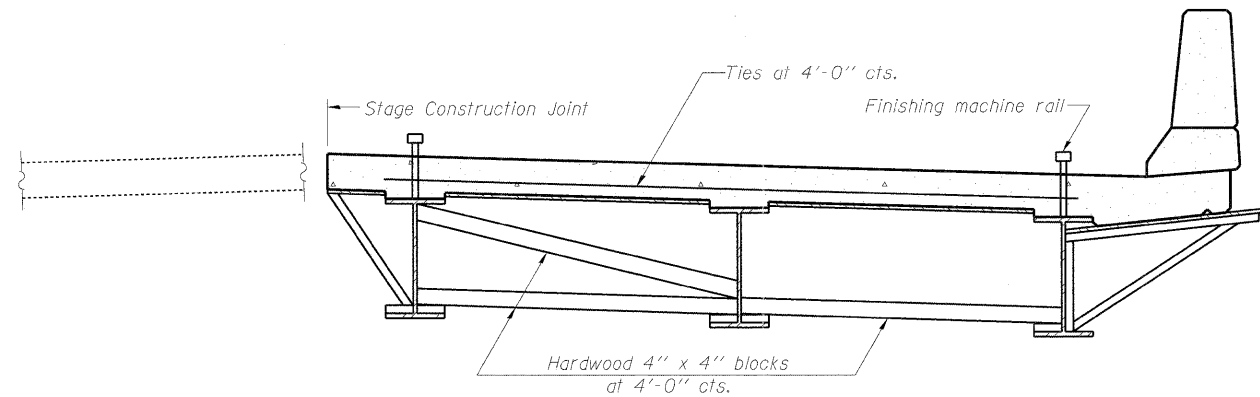

**FORM BRACES FOR
STAGE CONSTRUCTION**

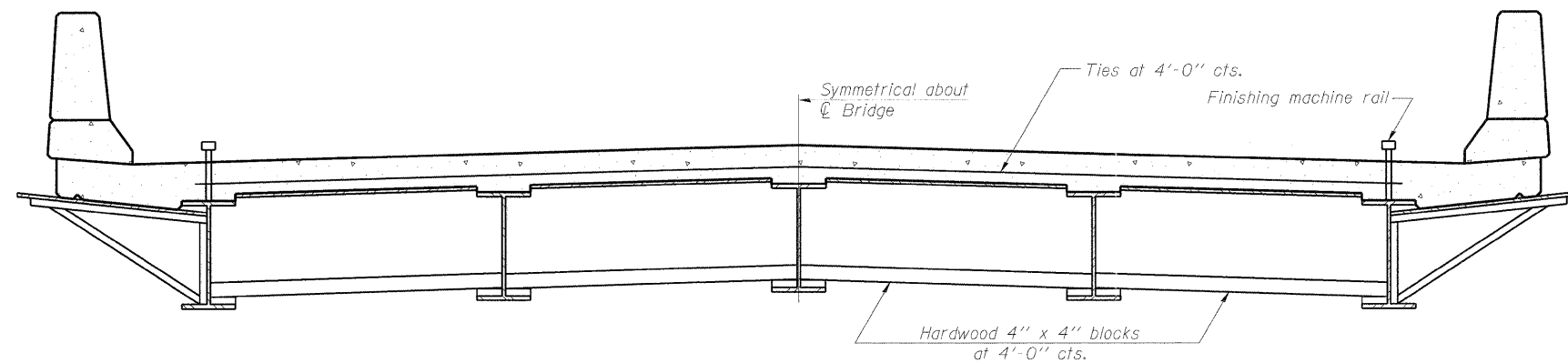

**FORM BRACES FOR
STANDARD CONSTRUCTION**

FILE NAME = g:\project\2150\001\cadd\structure\sh\0160680-60M52-220-Forming.dgn

SB-1

7-1-10



USER NAME = zpiemid	DESIGNED - BPS	REVISED -
PLLOT SCALE = N/A	CHECKED - BHS	REVISED -
PLLOT DATE = 10/27/2011	DRAWN - BPS	REVISED -
	CHECKED - BHS	REVISED -

**STATE OF ILLINOIS
DEPARTMENT OF TRANSPORTATION**

**CANTILEVER FORMING BRACKETS
S.N. 016-0680**

SHEET NO. S20 OF 29 SHEETS

F.A.U. RTE.	SECTION	COUNTY	TOTAL SHEETS	SHEET NO.
2692	1415B-1	COOK	72	55
CONTRACT NO. 60M52				
ILLINOIS FED. AID PROJECT				