

BENCHMARK

BM-1 CUT 'C' SOUTHEAST CORNER OF SOUTHWEST CONCRETE RETAINING WALL OF WESTERN AVE. BRIDGE OVER BUTTERFIELD CREEK. ELEV. = 654.70

NOTE:
VERTICAL AND HORIZONTAL CONTROL
NAVD 1988 DATUM PER GPS VRS NETWORK

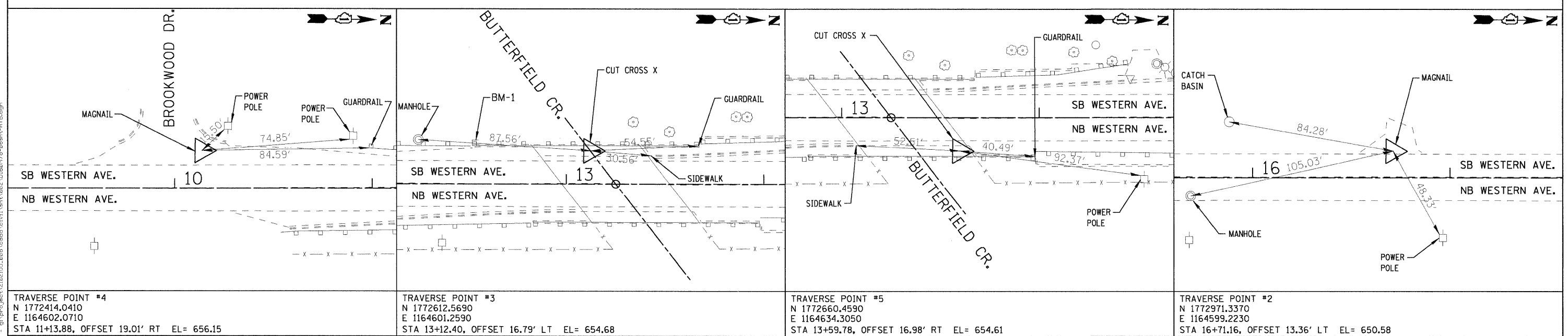

TRAVERSE POINT #4 N 1772414.0410 E 1164602.0710 STA 11+13.88, OFFSET 19.01' RT EL= 656.15	TRAVERSE POINT #3 N 1772612.5690 E 1164601.2590 STA 13+12.40, OFFSET 16.79' LT EL= 654.68	TRAVERSE POINT #5 N 1772660.4590 E 1164634.3050 STA 13+59.78, OFFSET 16.98' RT EL= 654.61	TRAVERSE POINT #2 N 1772971.3370 E 1164599.2230 STA 16+71.16, OFFSET 13.36' LT EL= 650.58
--	--	--	--



USER NAME = zpiend	DESIGNED - DJB	REVISED -
PLOT SCALE = 50,0000' / IN.	DRAWN - ENTRAN	REVISED -
PLOT DATE = 12/5/2011	CHECKED - TMH	REVISED -
	DATE - 10/28/11	REVISED -

**STATE OF ILLINOIS
DEPARTMENT OF TRANSPORTATION**

WESTERN AVENUE OVER BUTTERFIELD CREEK ALIGNMENT, TIES & BENCHMARKS	
SCALE: 50,0000' / IN.	SHEET NO. OF SHEETS STA. TO STA.

F.A.U. RTE. 2845	SECTION 0505-B	COUNTY COOK	TOTAL SHEETS 52	SHEET NO. 7
CONTRACT NO. 60M78				
FED. ROAD DIST. NO. 1 ILLINOIS FED. AID PROJECT				

FILE NAME = g:\projects\2102195_008\roads\env\1\h\1\002\0160M78-06shr-ATB.dgn