

* Order a(E) & a₁(E) bars full length.
Cut to fit skew and use remainder
of bars in opposite end.

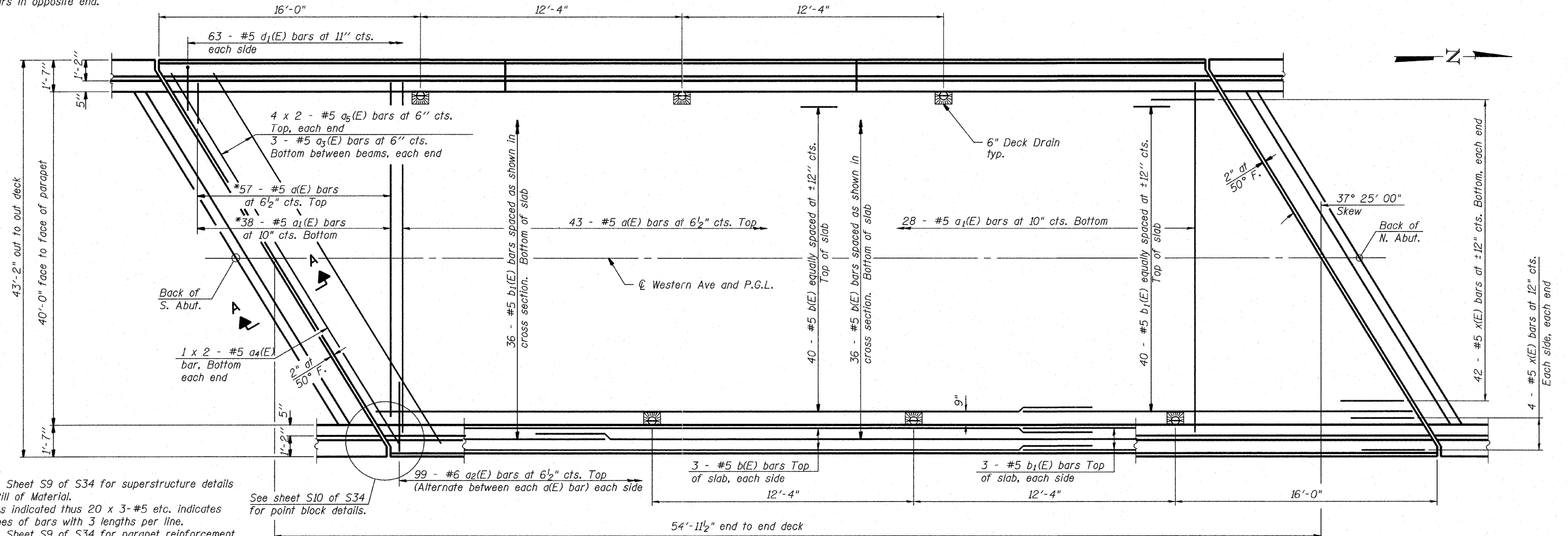

Notes:
See Sheet S9 of S34 for superstructure details and Bill of Material.
Bars indicated thus 20 x 3-#5 etc. indicates 20 lines of bars with 3 lengths per line.
See Sheet S9 of S34 for parapet reinforcement.
See Sheet S9 of S34 for Section A-A.

See sheet S10 of S34 for point block details.

Dimensions are based on a Rolled Rail Strip Seal Joint. If the Contractor elects to use the Welded Rail Strip Seal Joint, deck dimensions may require adjustments to satisfy the details on Base Sheet EJ-SSJ.

PLAN

MINIMUM BAR LAP

(Deck)
#5 bar = 2'-7"

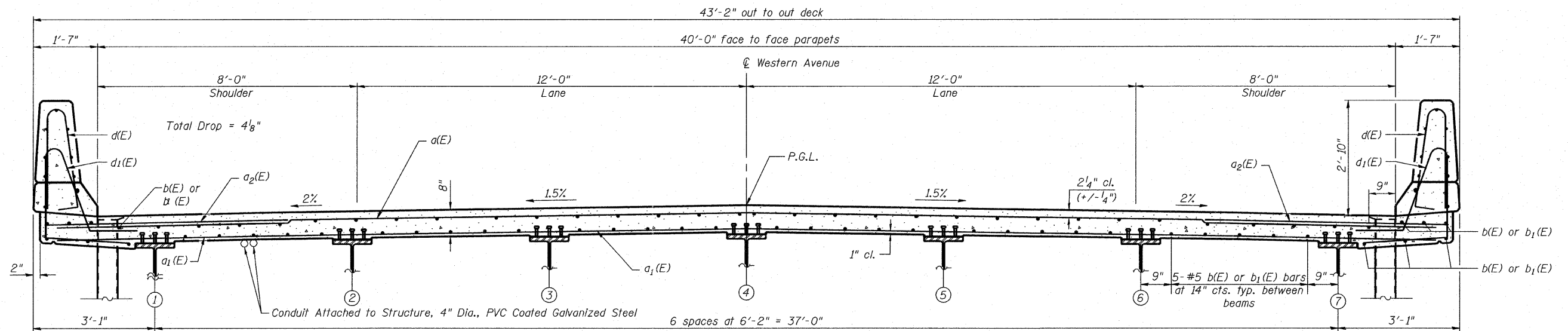

CROSS SECTION
(Looking North)

APEX
CONSULTING ENGINEERS, LLC
111 E. Wacker Drive, Suite 500
Chicago, IL 60601
Phone (312) 977-0660 Fax (312) 977-0661

USER NAME =
DESIGNED - RAD
CHECKED - HAA
DRAWN - WHI
PLOT SCALE =
PLOT DATE = 12/8/2011

DESIGNED - RAD
CHECKED - HAA
DRAWN - WHI
CHECKED - RAD

REVISED
REVISED
REVISED
REVISED

STATE OF ILLINOIS
DEPARTMENT OF TRANSPORTATION

DECK PLAN AND SECTION
STRUCTURE NO. 016-0772

SHEET NO. 58 OF S34 SHEETS

| F.A.U. RTE. | SECTION | COUNTY | TOTAL SHEETS | SHEET NO. |
|--------------------|---------|--------|--------------|-----------|
| 2845 | 0505-B | COOK | 52 | 18 |
| CONTRACT NO. 60M78 | | | | |

ILLINOIS FED. AID PROJECT