

IL. ROUTE 47

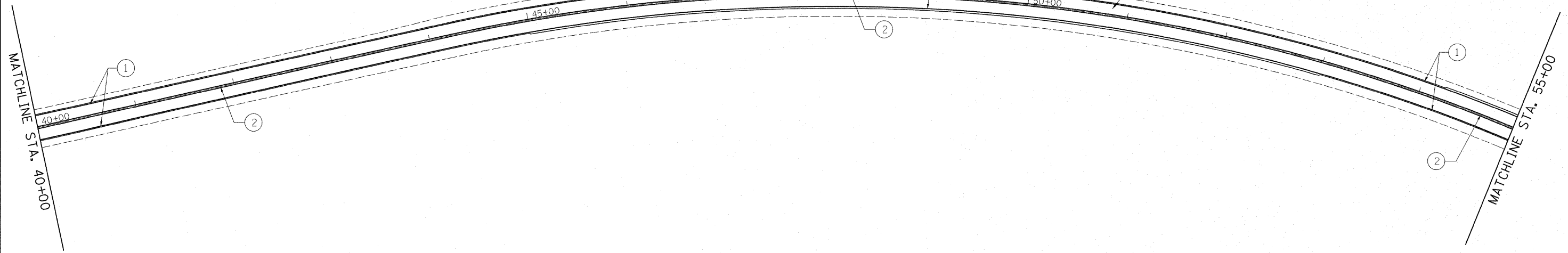

PROP. HOT-MIX ASPHALT SURFACE REMOVAL, 2 1/4"
 PROP. HOT-MIX ASPHALT SURFACE COURSE, MIX "D", N50, 1 1/2"
 PROP. POLY. LEVELING BINDER (MACHINE METHOD), IL-4.75, N50, 3/4"



- ① PROP. THERMOPLASTIC PVMT. MARKING 4", LINE, WHITE (TYP.)
- ② PROP. THERMOPLASTIC PVMT. MARKING 4", DOUBLE YELLOW (TYP.)
- ③ PROP. THERMOPLASTIC PVMT. MARKING 4", SKIP DASH, YELLOW (TYP.)
- ④ PROP. THERMOPLASTIC PVMT. MARKING 6", TURN LANE, WHITE (TYP.)
- ⑤ PROP. THERMOPLASTIC PVMT. MARKING 8", DIAGONALS, WHITE (TYP.)
- ⑥ PROP. THERMOPLASTIC PVMT. MARKING 12", DIAGONALS, YELLOW (TYP.)
- ⑦ PROP. THERMOPLASTIC PVMT. MARKING 24", STOP BAR, WHITE (TYP.)

IL. ROUTE 47



PROP. HOT-MIX ASPHALT SURFACE REMOVAL, 2 1/4"
 PROP. HOT-MIX ASPHALT SURFACE COURSE, MIX "D", N50, 1 1/2"
 PROP. POLY. LEVELING BINDER (MACHINE METHOD), IL-4.75, N50, 3/4"

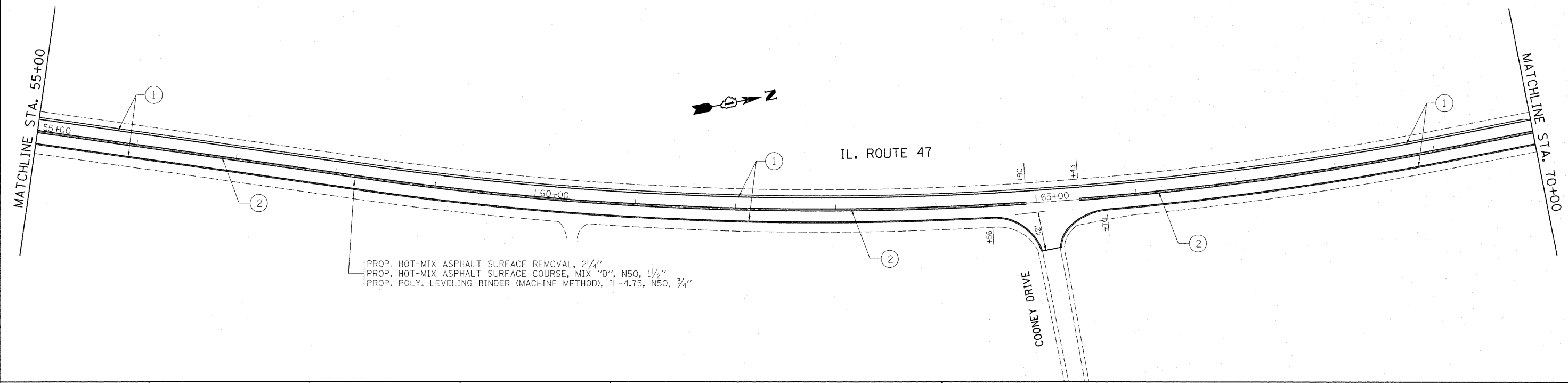

FILE NAME =
 D130911-sht-plan.dgn

USER NAME = midyja
 DRAWN -
 CHECKED -
 DATE -

DESIGNED -
 DRAWN -
 CHECKED -
 DATE -

REVISED -
 REVISED -
 REVISED -
 REVISED -

STATE OF ILLINOIS
 DEPARTMENT OF TRANSPORTATION

IL. ROUTE 47 (WARE ROAD TO PRICE ROAD)
 PAVEMENT MARKING SHEET

SCALE: 1"= 50' SHEET NO. OF SHEETS STA. 40+00.00 TO STA. 70+00.00

F.A.P. RTE.	SECTION	COUNTY	TOTAL SHEETS	SHEET NO.
326	104-RS-11	McHENRY	29	6
CONTRACT NO. 60N39				

ILLINOIS FED. AID PROJECT