

F.A.P. RTE.	SECTION	COUNTY	TOTAL SHEETS	SHEET NO.
307	129-R-2	KANE	243	28
STA.	TO STA.			
FED. ROAD DIST. NO. 1	ILLINOIS	FED. AID PROJECT		
CONTRACT NO. 62195				

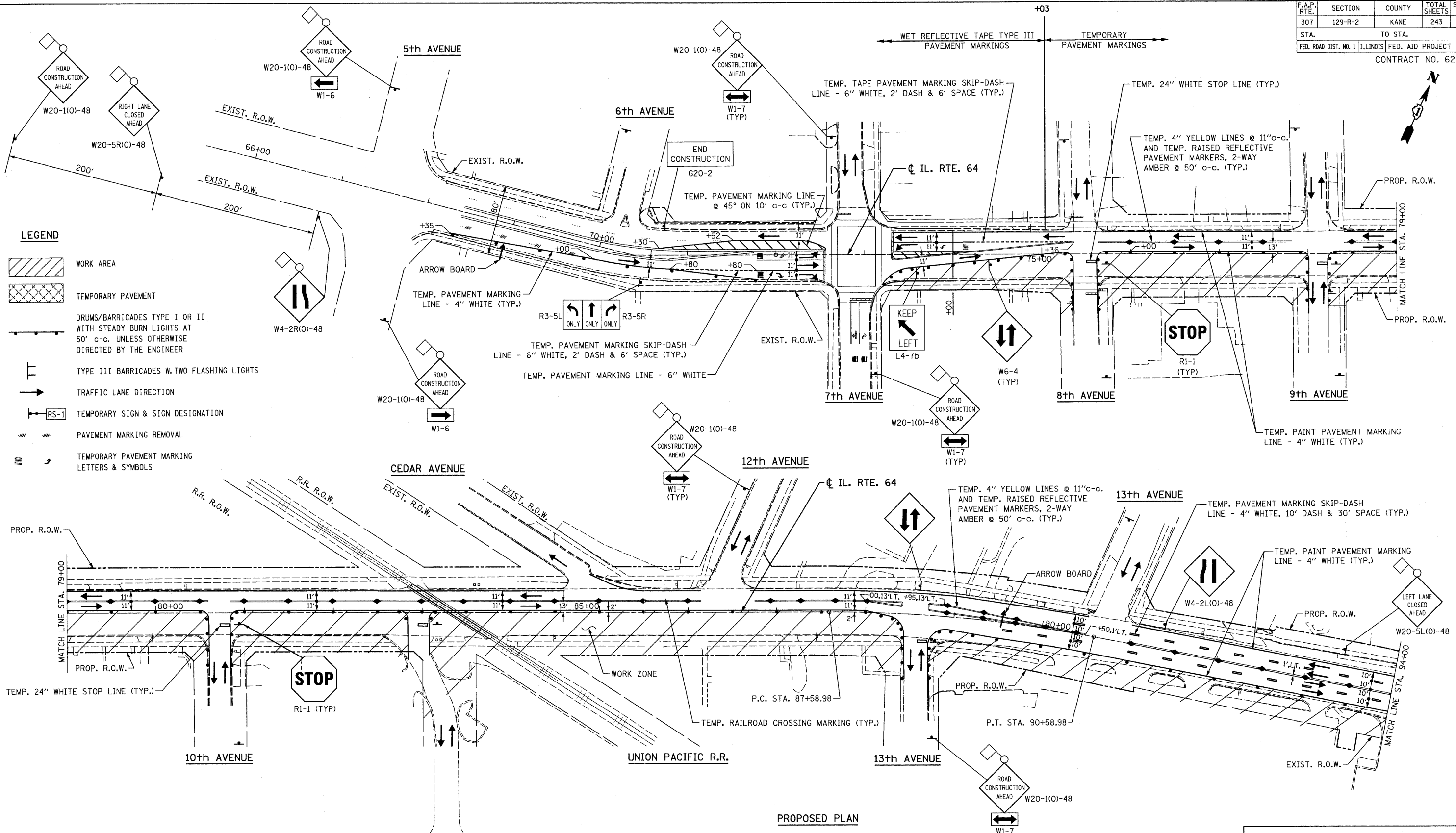

- LEGEND**
- WORK AREA
 - TEMPORARY PAVEMENT
 - DRUMS/BARRICADES TYPE I OR II WITH STEADY-BURN LIGHTS AT 50' c-c. UNLESS OTHERWISE DIRECTED BY THE ENGINEER
 - TYPE III BARRICADES W. TWO FLASHING LIGHTS
 - TRAFFIC LANE DIRECTION
 - TEMPORARY SIGN & SIGN DESIGNATION
 - PAVEMENT MARKING REMOVAL
 - TEMPORARY PAVEMENT MARKING LETTERS & SYMBOLS

NOTE:
1. FOR TRAFFIC CONTROL AND STAGING NOTES SEE SHEET NO. 26.

CHRISTIAN-ROGE & ASSOCIATES, INC.
ENGINEERS-PLANNERS-SURVEYORS
211 WEST WACKER DRIVE
CHICAGO, ILLINOIS 60606
1-312-372-2023 FAX: 1-312-372-5274

REVISIONS	
NAME	DATE

ILLINOIS DEPARTMENT OF TRANSPORTATION
SUGGESTED TRAFFIC CONTROL AND PROTECTION - STAGE I
STA. 74+00 TO STA. 94+00
ILLINOIS ROUTE 64
SCALE: 1" = 50'
DATE: AUGUST 10, 2011
DRAWN BY B.K.
CHECKED BY S.J.P.

FILE NAME: r:\tbl6\mtr\ra\dgn
PLOT DATE: 9/12/2011
PLOT SCALE: 60.0000 Ft. / IN.

ROAD CLOSED LOCAL TRAFFIC ONLY
(ON TYPE III BARRICADES)
R11-3